



Collective Intent

Community Manifesto

- + Each member of the community must play an important role.
- + Each member of the community must contribute through independent financial contributions, environmental management, resource management or distribution.
- + Each member must consider whether they will be participating in income sharing early on in their integration into the community.
- + The community is centred around egalitarianism and equal opportunity.
- + The community's core values must be shared by all inhabitants.
- + The community lives off the land, only adding to its environment.
- + The activities of the community must minimal-no negative environmental impact.
- + Any negative environmental impact must be offset through other protective endeavours.
- + The community must strive to protect native flora and fauna, with particular emphasis on the Curlew, the Nightjar and the Woodlark.
- + The community must constantly evaluate its waste production and usage, as well as defining what is waste, and what is useful.
- + The community must be designed to give each member enough space to live comfortably.
- + The community must be designed for each member to be able to sustain their diet off the land.
- + The community must have an integral relationship with the natural world.
- + The community must be designed to allow each member to continue their relationship with the modern world outside of RAF Barnham.

- Main Circulation Sites
- Water Sources
- Main On-site Roads
- Site Entrances

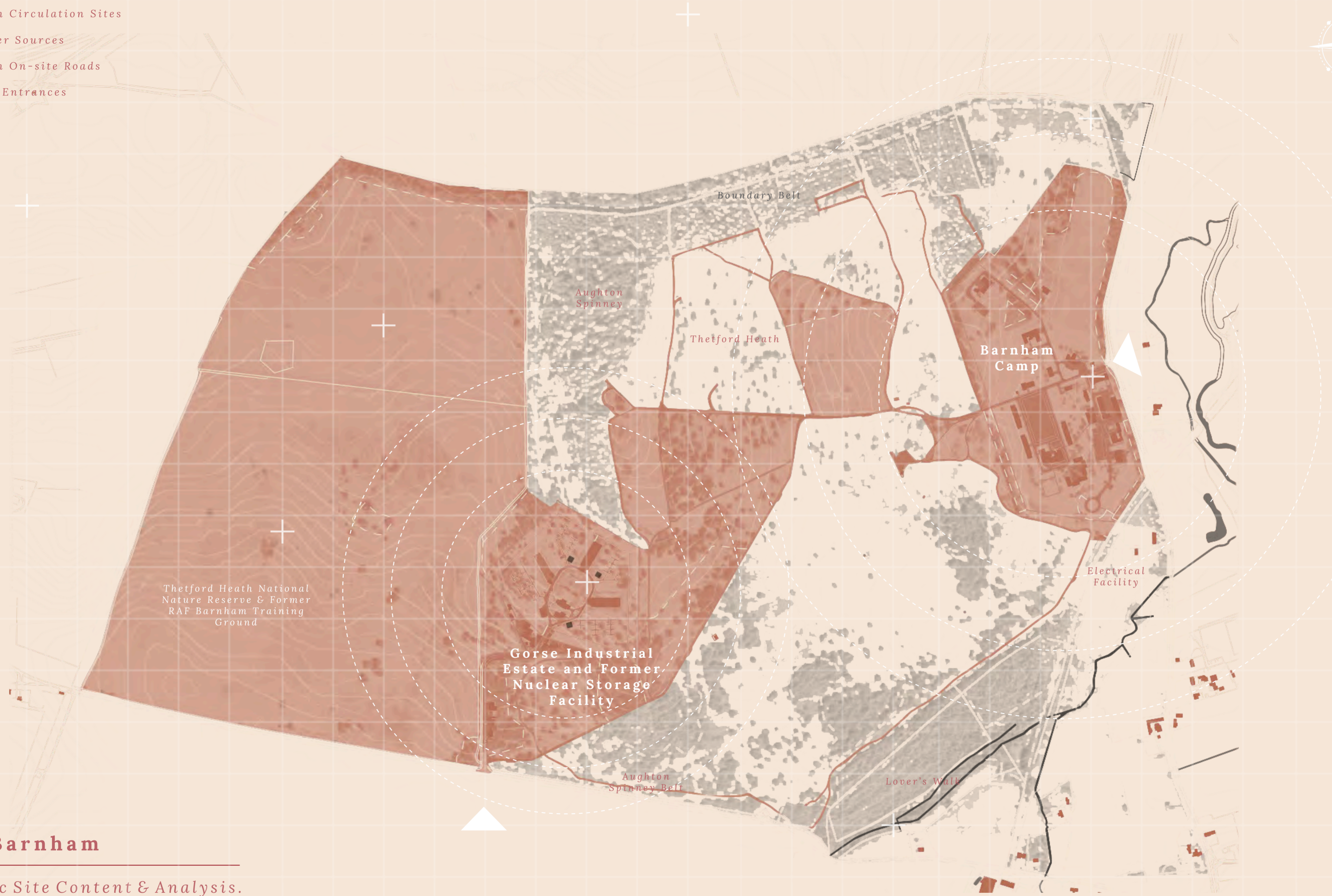

RAF Barnham

Specific Site Content & Analysis.

RAF Barnham (also called Barnham Camp) is a Royal Air Force station situated in the English county of Suffolk 2 miles (3.2 km) south of the Norfolk town of Thetford. It is located to the north of the village of Barnham on Thetford Heaths. The camp is a satellite station of RAF Honington. During the 1950s and 60s a part of RAF Barnham was set aside as high-security storage facility for nuclear weapons. This area of the site is now a scheduled monument. In January 2016, it was announced that RAF Barnham would close.

MASTER PLAN

Barnham Community

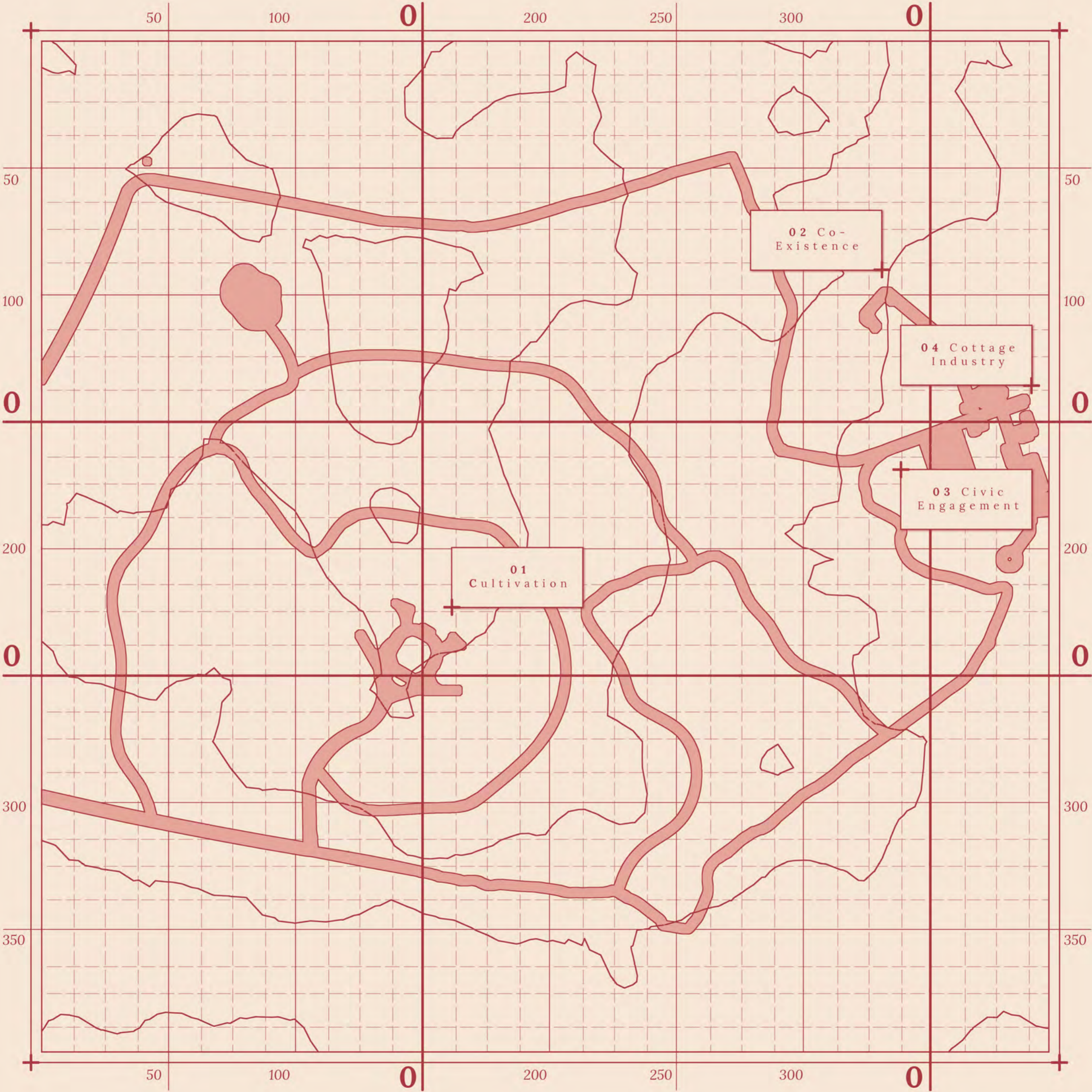

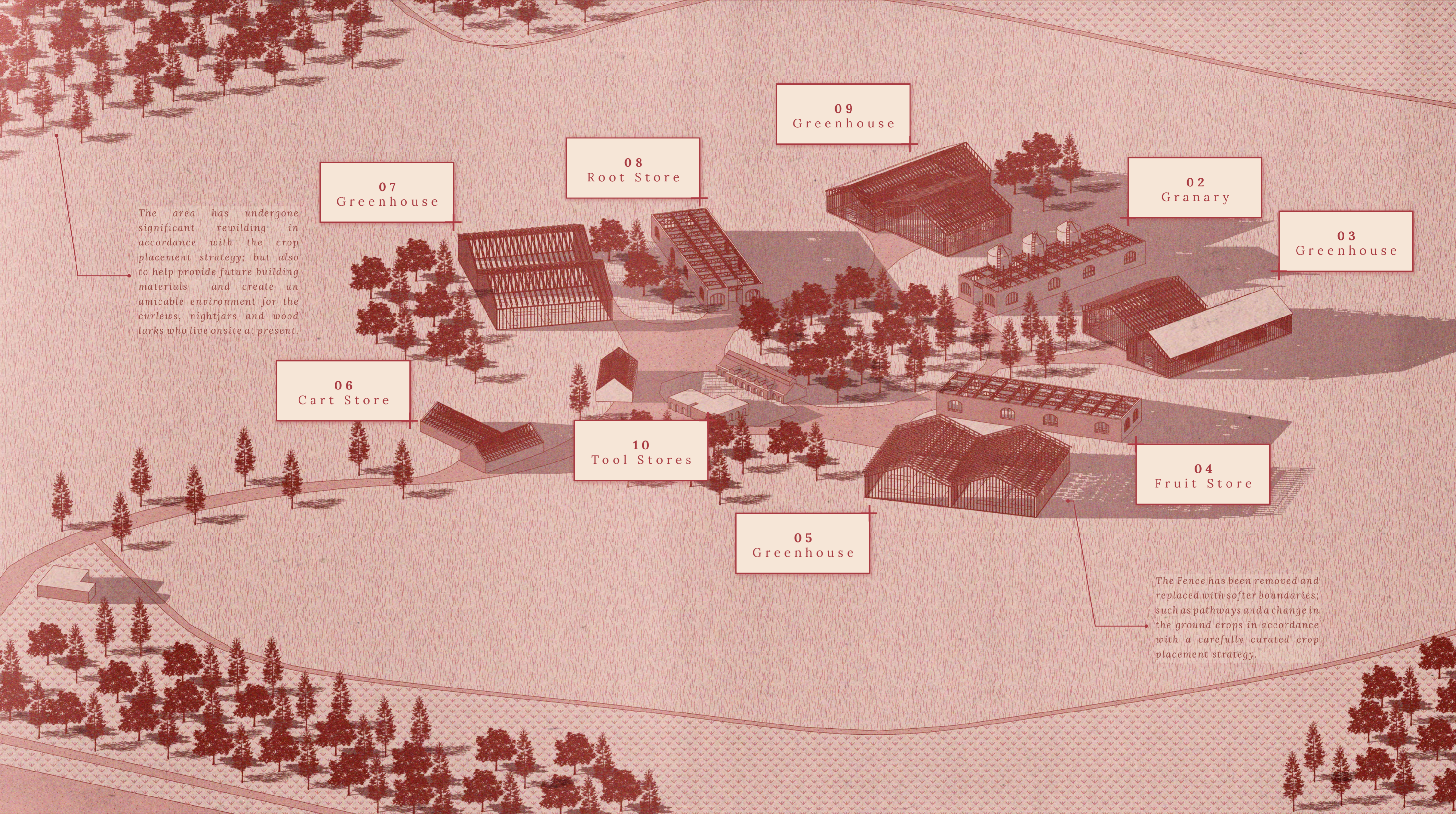

The area has undergone significant rewilding in accordance with the crop placement strategy; but also to help provide future building materials and create an amicable environment for the curlews, nightjars and wood larks who live onsite at present.

The Fence has been removed and replaced with softer boundaries; such as pathways and a change in the ground crops in accordance with a carefully curated crop placement strategy.

Masterplan

Cultivation - Phase 3: Rewilding & Growing

This axo is the first of two showing the major activity centres on-site. Cultivation is the major source of the community's nourishment and also its connection with the outside village in the form of a cottage industry. The four major interventions happening across the site - in particular in Cultivation - are demolition & salvage, adaptive reuse, new builds and re-wilding. In particular on this portion of the site, a significant portion of the land is kept rural and designated for food production, and re-wilding the outskirts and empty areas appeal to the existing flora and fauna on the site.

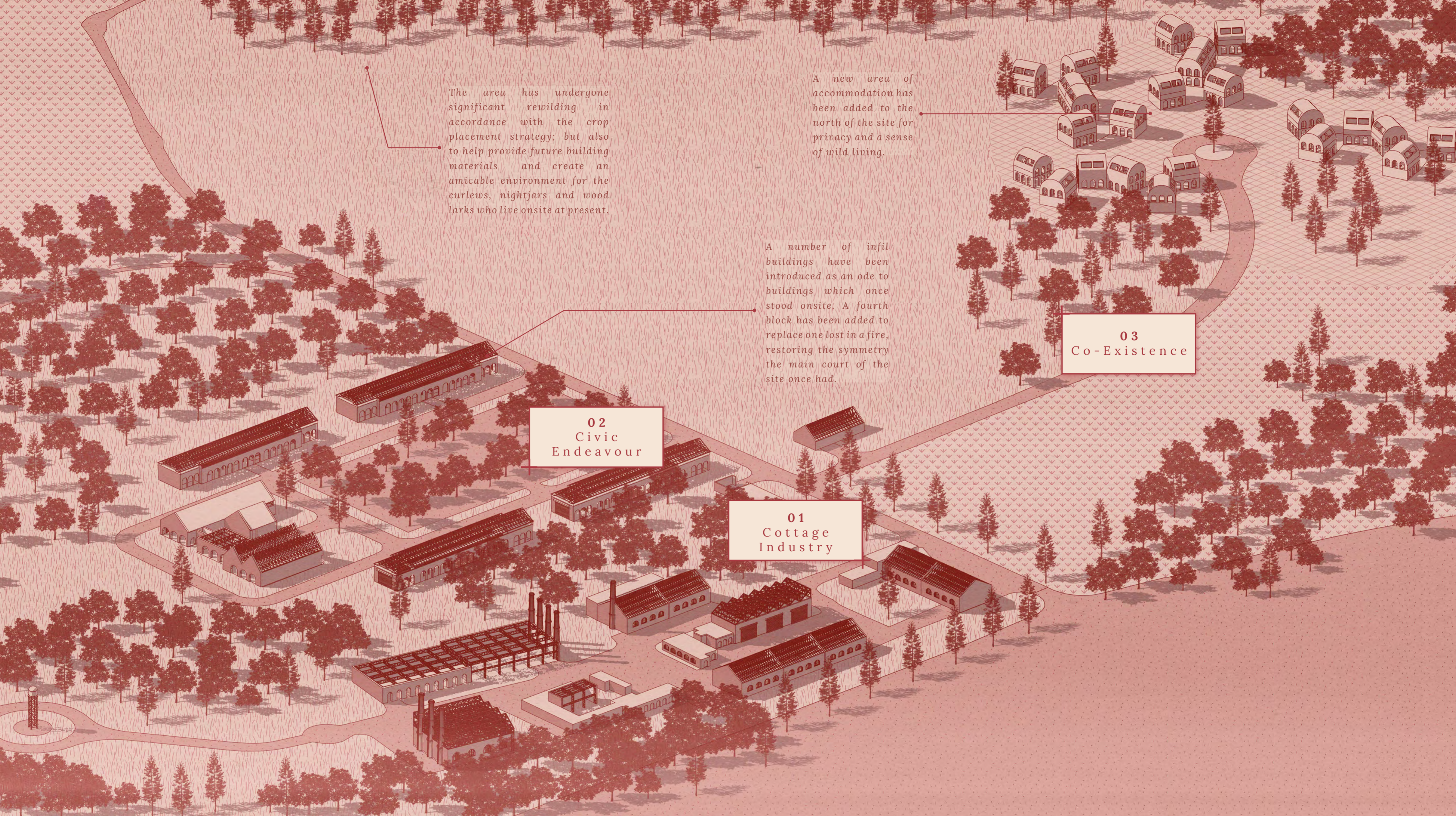

The area has undergone significant rewilding in accordance with the crop placement strategy; but also to help provide future building materials and create an amicable environment for the curlews, nightjars and wood larks who live onsite at present.

A new area of accommodation has been added to the north of the site for privacy and a sense of wild living.

A number of infill buildings have been introduced as an ode to buildings which once stood onsite. A fourth block has been added to replace one lost in a fire, restoring the symmetry the main court of the site once had.

02
Civic
Endeavour

01
Cottage
Industry

03
Co-Existence

Masterplan

Co-Exist, Civic Endeavour & Cottage Industry - Phase 3: Rewilding & Rehousing

This axo is the second of two showing the major activity centres on-site. Civic Endeavour and Cottage Industry - though separately defined areas - are very much integrated with one another. The building typologies bleed across each zone, with regular appearances from crafted timber trusses and the arch form. The site is extremely rural; with some areas rewilded to give as much consideration towards existing flora and fauna as the humans inhabiting RAF Barnham.

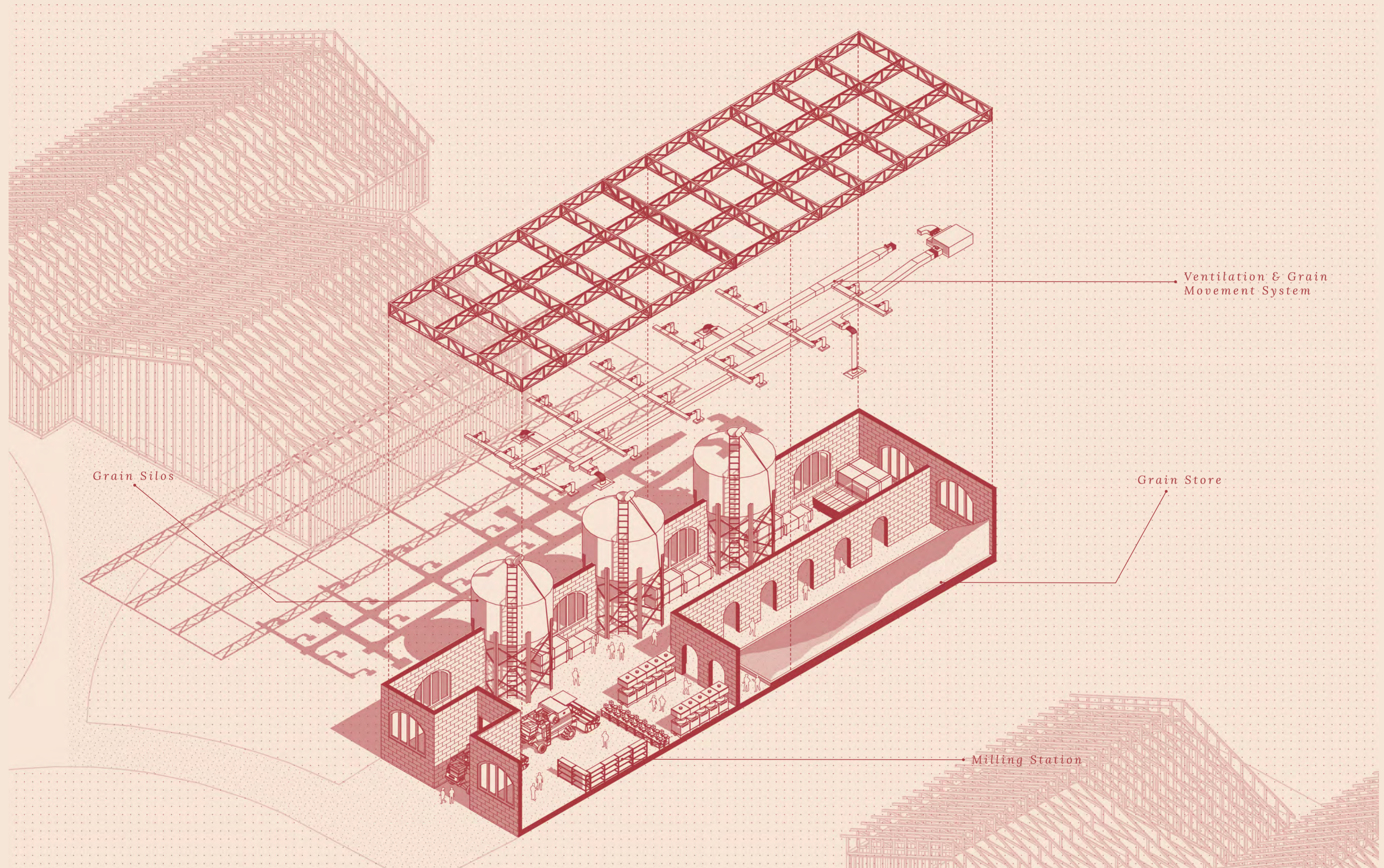

No.1 Granary

Axonometric

No.1 Granary is designed to house the full process of grain, from growth to storage. Housed within the ground cover section of the crop planting masterplan, The grain silos are accessible from both the inside and outside of the building, with a grain store and milling station processing the grain into usable, storable product to be moved into the bakery in civic engagement.



Growhouse

Encounters in the Commune

The growhouse is of greenhouse typology, making use of natural and artificial light to grow indoor planting naturally and abundantly. The significance of cultivation on the site comes back to commoning; making use of existing resources and new, modest and simply executed structures to provide sustainable life forces for Barnham community to thrive.



Cultivation

Encounters in the Commune

The above images capture exterior experiences in the commune. Various types of farming will be taken part in in the community; forming the predominant workload of the members and their contributions to the community. Above I have shown a vegetable field - a large proportion of the food eaten by the members - as well as an egg farm which forms one of the sole animal products produced on the site. The buildings shown are the agricultural typologies - some concrete existing building on Gorse industrial estate, and some newer, timber style sheds.



Co-Existence

Exploded Axonometric

The arch is a form replicated across RAF Barnham, simple and primitive. Arches are structures with deep resonance. They embody and symbolize many things: strength and support, lightness and openness within density, thresholds into liminal space. The co-living at RAF Barnham seeks to represent all of these things; with lightweight structural frames juxtaposed with dense and comforting rammed earth walls which replicate cave-like feelings of comfort. In architecture, the arch serves to lift the eye (and spirit) upwards to a higher plane/ideal; representing a move to a new yet old communal way of living.

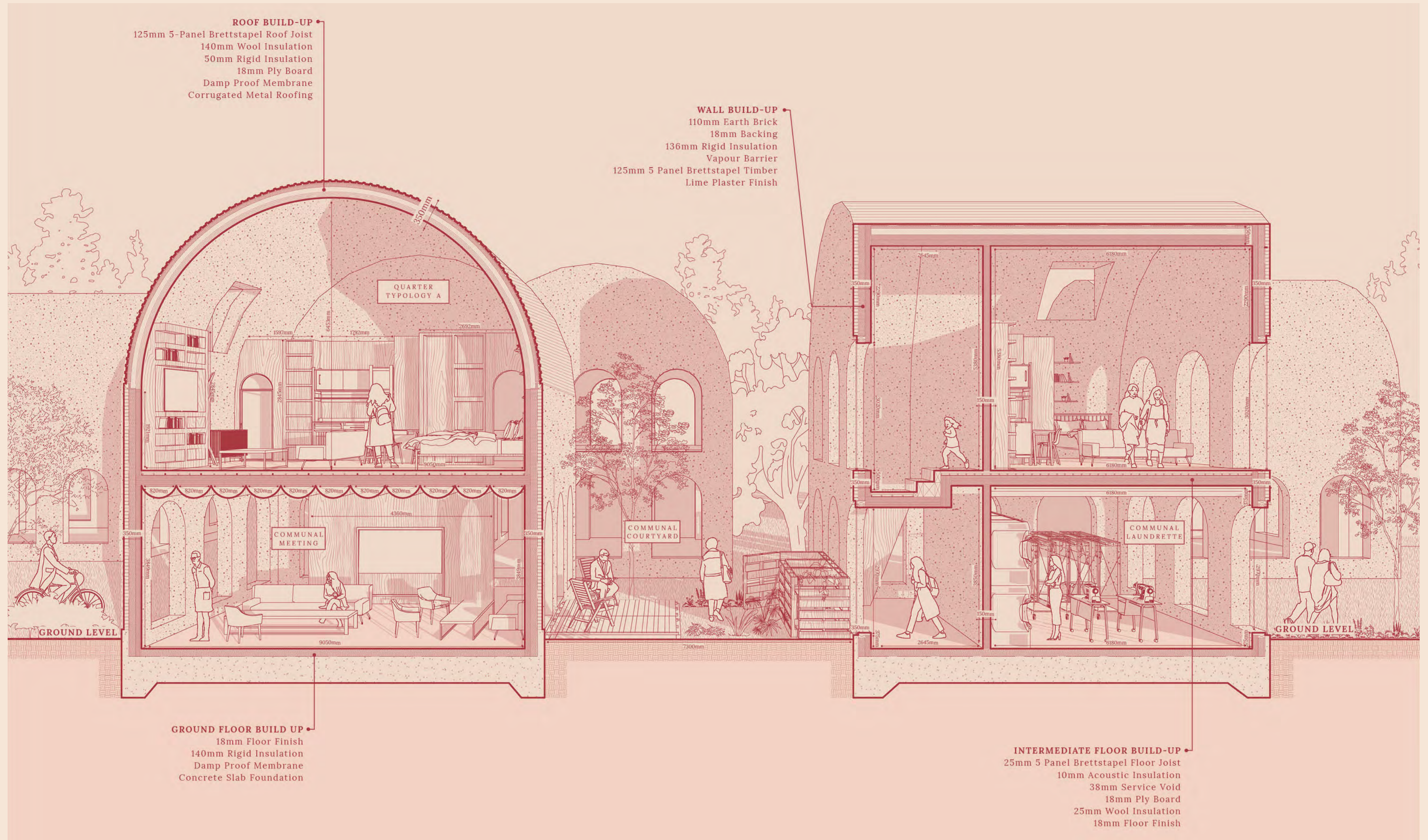

Co-Existence

Sections

The section is designed to be split level, encouraging communal activities to be open and experienced on the lower levels in conjunction with the outdoor space. Rammed earth, lime render (cooked on-site) and a vaulted ceiling provide a cave-like cosiness reminding residents that they owe their comfort to the natural world around them; and that materials like earth and timber are as significant a common resource as food and knowledge.

01. Pine Trees are felled onsite, during the waning phase of the moon, as this produces timber of higher density which is less prone to cracking, warping and infestation.

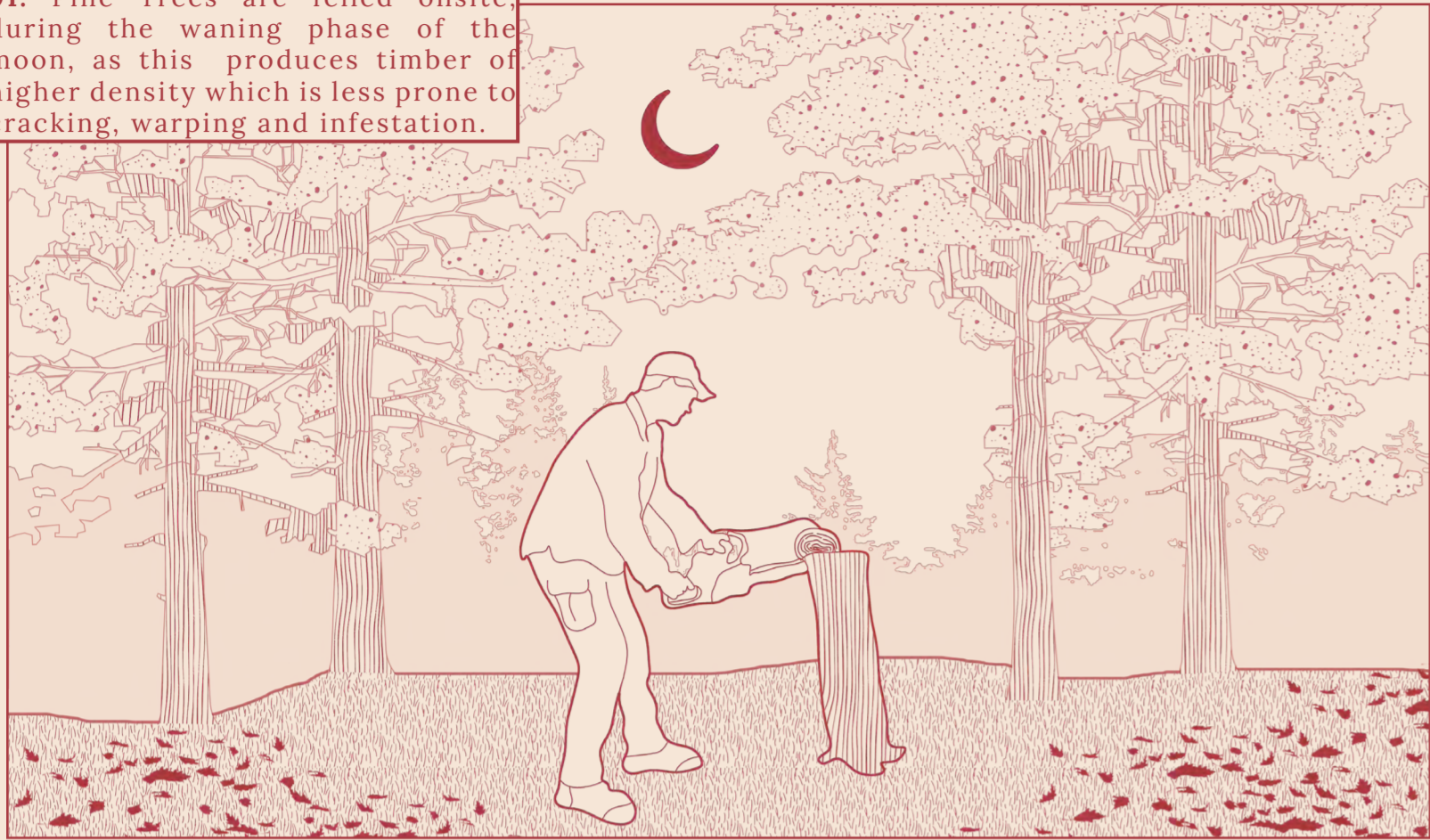

02. The timber is sawn, using various techniques depending on the usage of the lumber. The building frame will prioritise straight grain and quarter sawn.

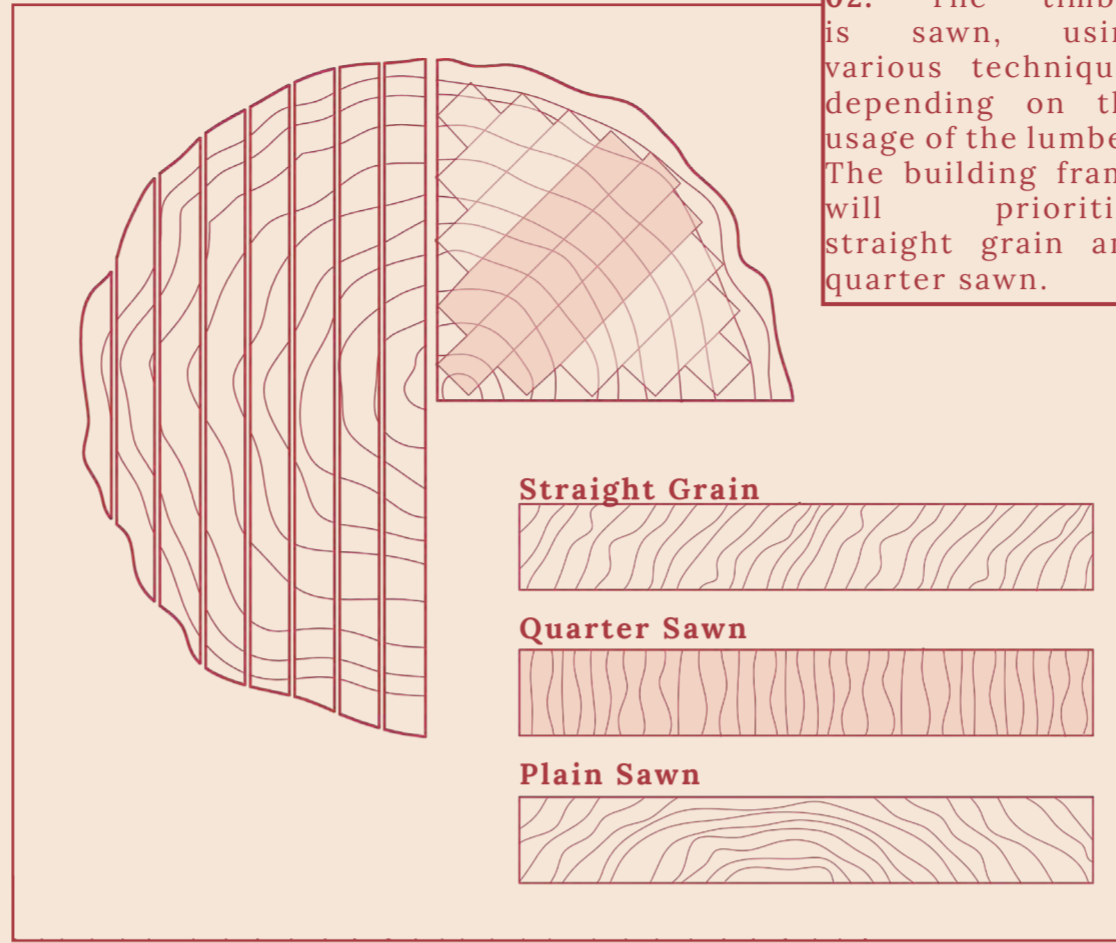

03. The timber is air-dried, this is done by building a lumber pile perpendicular to the prevailing wind; so the timber is exposed to enough air to dry it efficiently. Concrete blocks are used to lift the first layer of timber at least 1ft off the floor, and stickers are used to ensure adequate air flow. The stack is weighed down with more blocks, on top of a corrugated metal sheet.

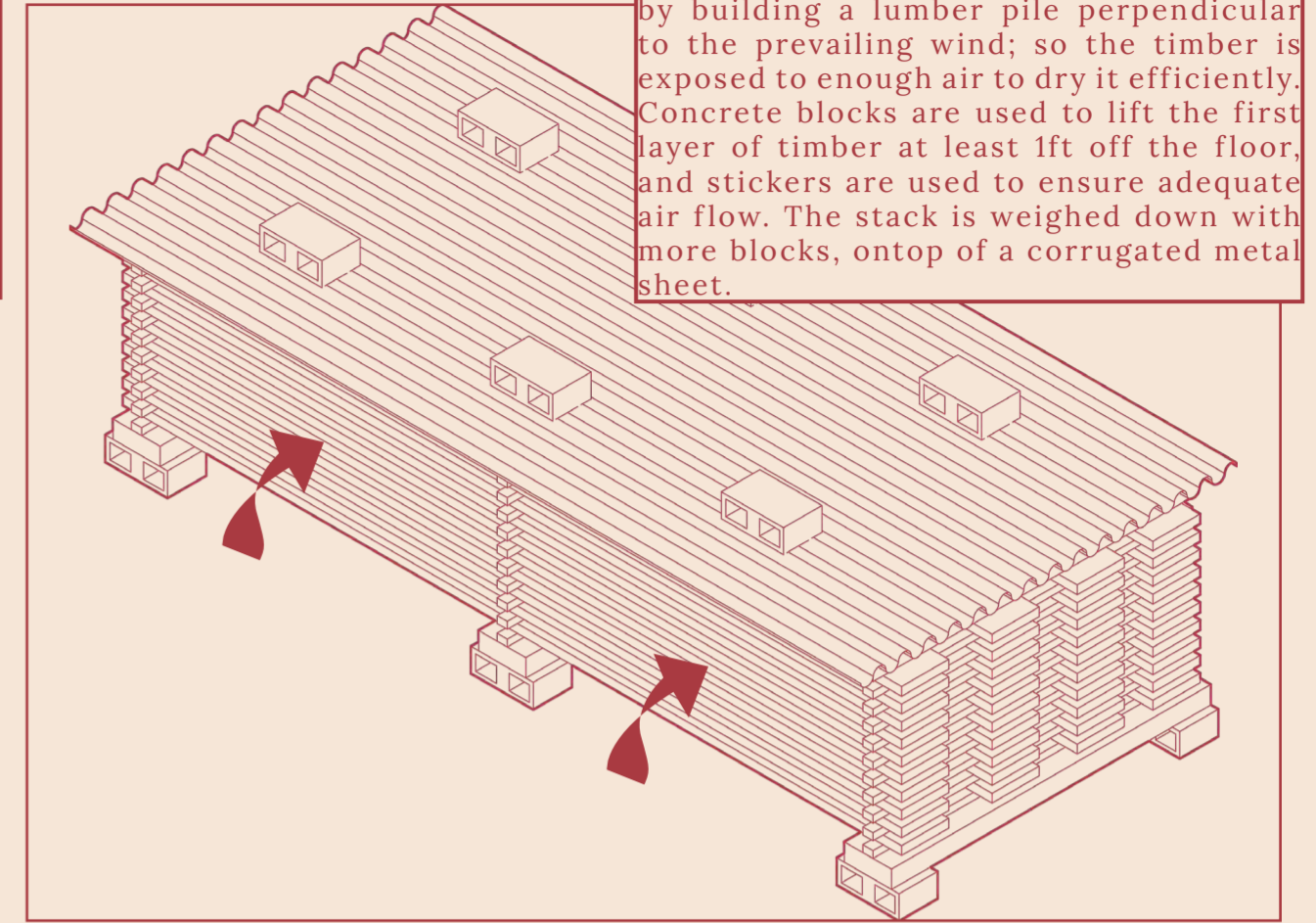

04. The timber is dressed, and posts are chosen according to knots and defects. Holes are drilled and the softwood is arranged, with hardwood dowels inserted to hold the timber together. Over time the hardwood dowels expand, achieving moisture equilibrium and creating strong, construction grade Brettstapel Timber.

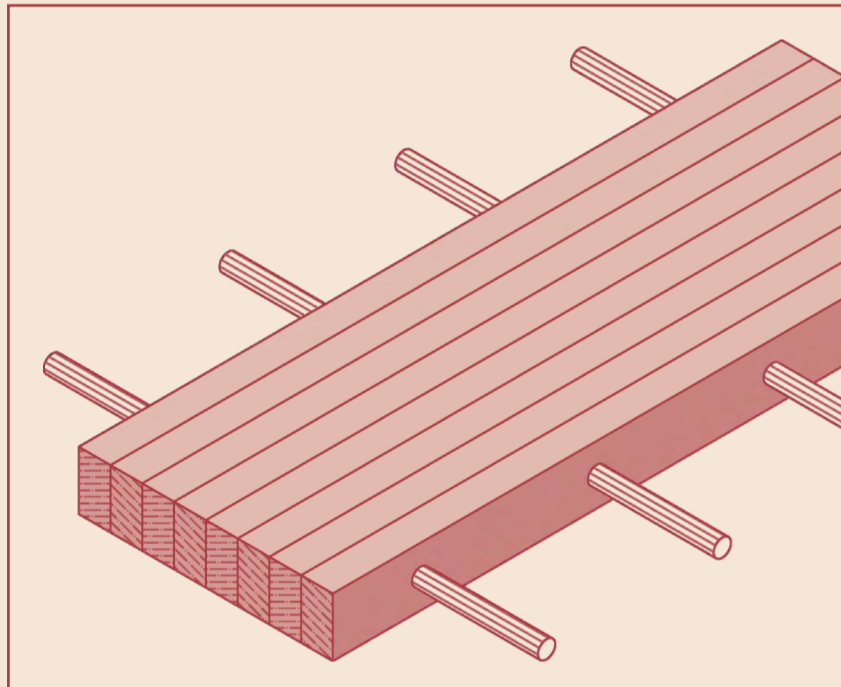

06. The Brettstapel is formed into the portal frame, in three pieces so that it can fit in the truck for the move from the timber factory, ready for assembly to finish onsite.

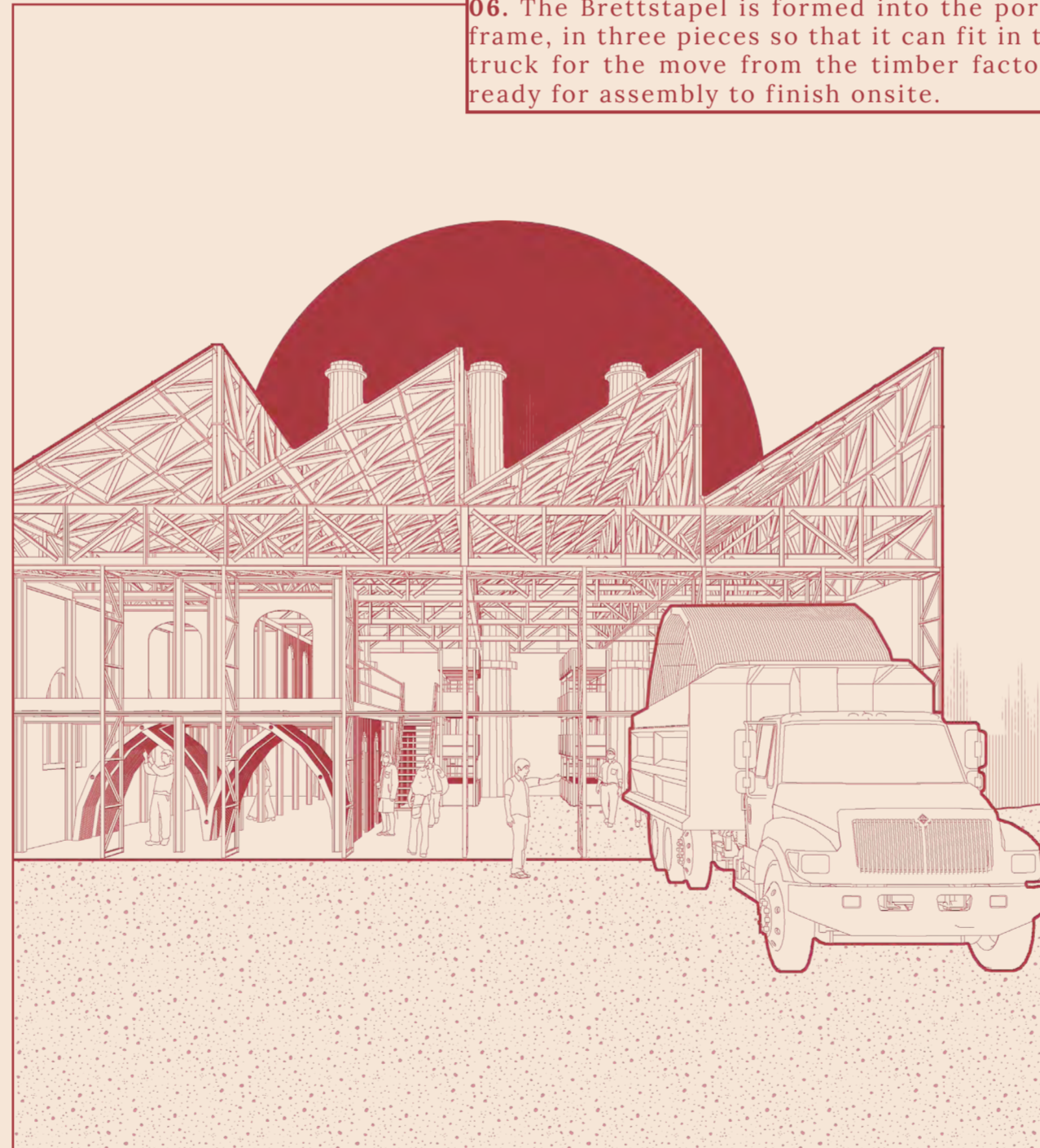

05. The new Brettstapel Posts are formed into the necessary joists for the frame and connected using a double bracket and screw joint with a small soft movement pad included behind to cater to any movement (this is more likely to occur with air dried timber than kiln dried timber due to the higher moisture content).

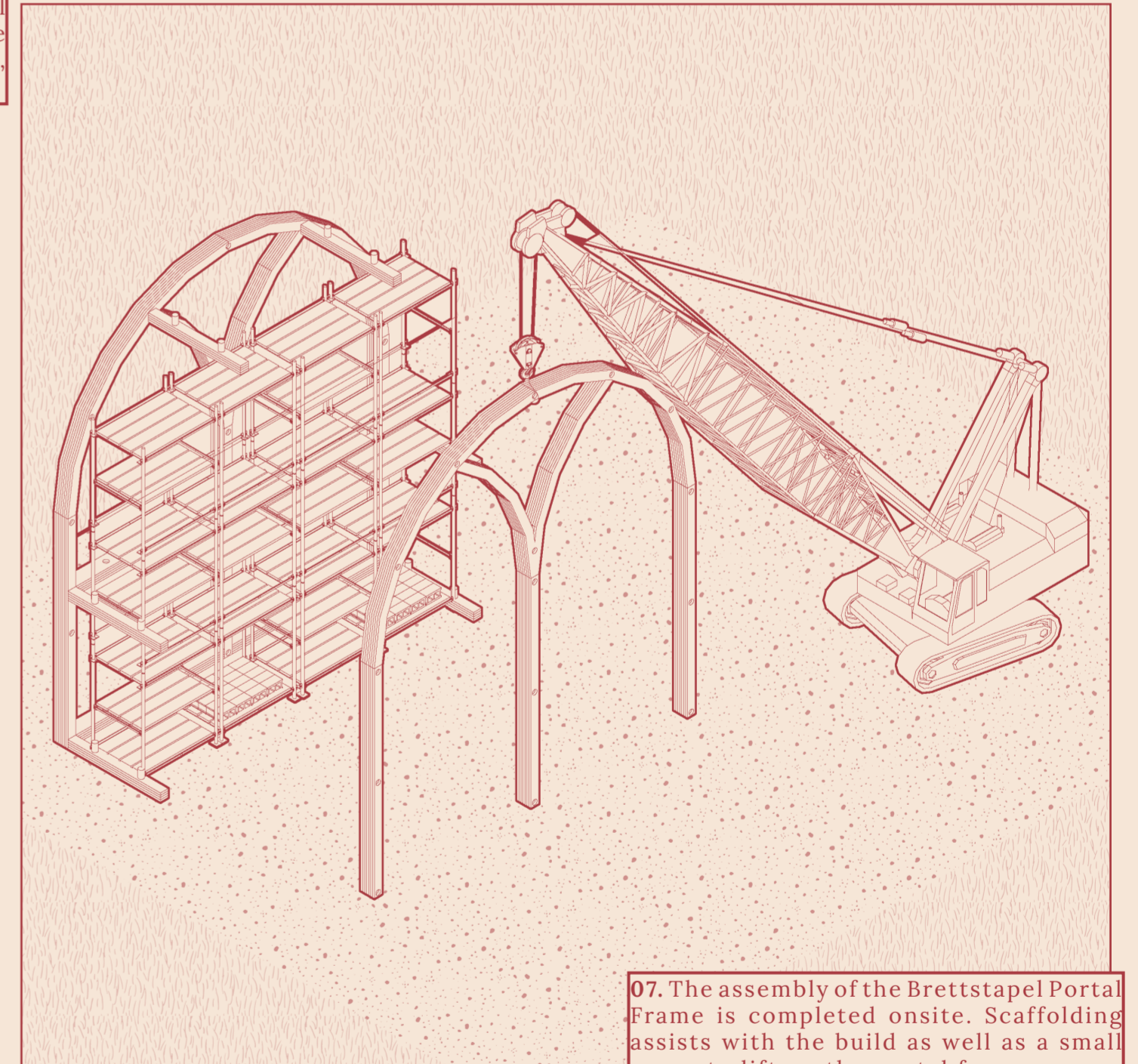
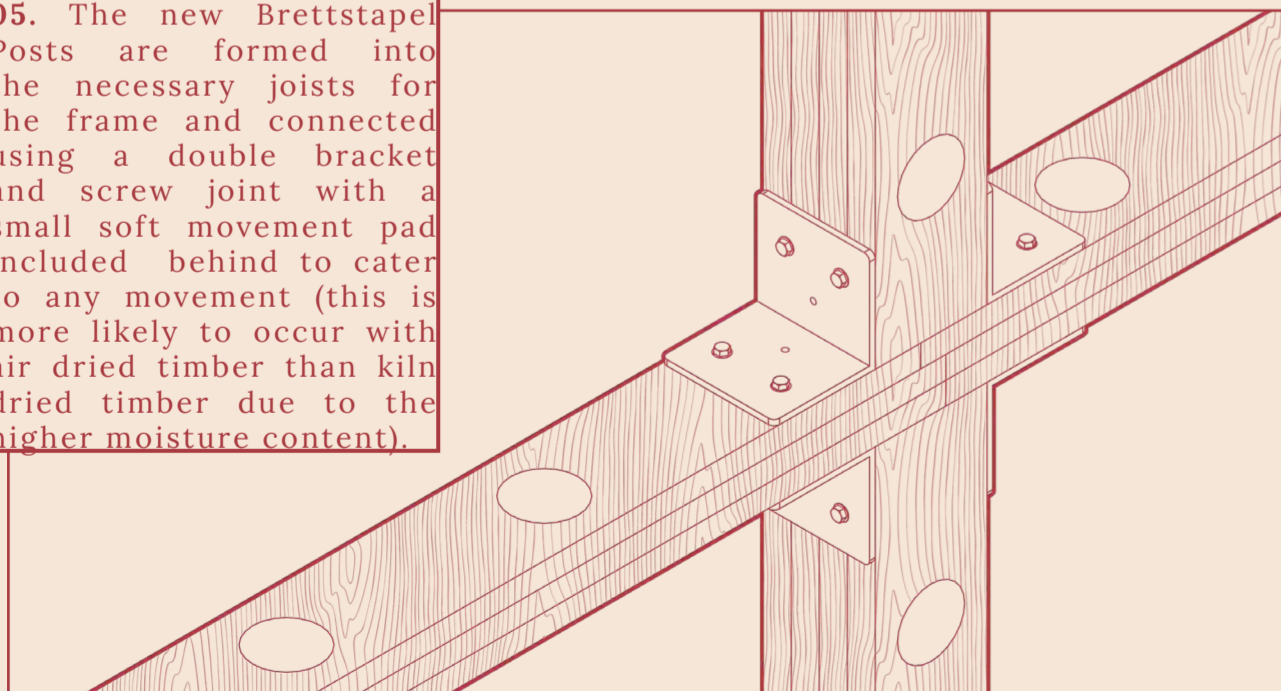

07. The assembly of the Brettstapel Portal Frame is completed onsite. Scaffolding assists with the build as well as a small crane to lift up the portal frame.

Co-Existence

Timber Construction Story: From Felling to Building



RAF Barnham

Encounters in the Commune

A quiet morning in the civic court, members relax on the heathland sitting on benches made from rammed earth of the aggregate leftover from the co-existence living quarters. The market is being set up ready for a day of trading goods grown and made on-site, donated military vehicles assist in moving goods across the site. Remnants from the sites past still stand, all furthering the communities incentives to redesign a space designed for conflict and destruction into a place which creates new life, prosperity and harmony.



Cultural Centre

Encounters in the Commune

The cultural centre makes use of existing brick and punches new, arch shaped openings, symbolic of the openness and importance of communal endeavoured explored elsewhere in the masterplan, as well as keeping the infill of brick to the existing openings notable as an ode to the building's history. As seen elsewhere, simple timber trusses are restored to architectural and structural significance, and partitions are made from metal scavenged from the tin roofs of demolished structures elsewhere on site. The cultural centres are explorations of the beauty of the existing; and how history can be honoured in subtle ways.

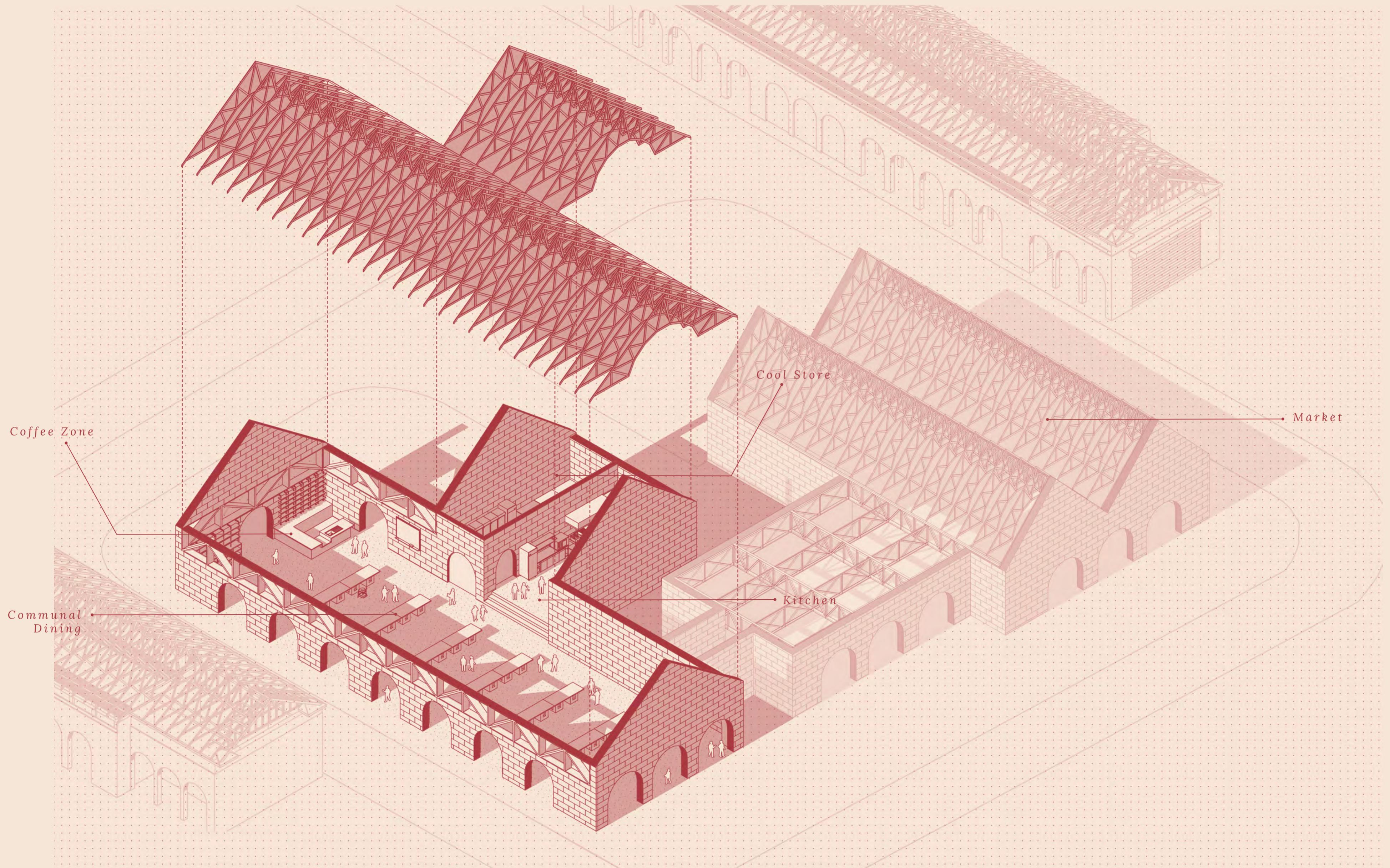

Dining Hall

Axonometric

In the masterplan, the dining hall is the head of the layout. This position in a typical military hierarchy would often be offered to prestigious housing or a museum building typology. In RAF Barnham, the culmination of an annual cycle of cultivation and food processing concludes here; in the most significant building on-site.



Dining Hall

Encounters in the Commune

Making use of existing, hodge podge collections of buildings on this location of the site, a series of pitched pavilions provides marvellous open space for residents to enjoy the fruits of the labour. Quiet mornings drinking coffee in-between working hours are juxtaposed with bustling evenings of communal eating and drinking; a celebration of all the community has achieved.



RAF Barnham

Concluding Encounter

In the image above, we see the decisions made daily as part of an intentional community. An evening conversation about integrating old military vehicles into the cultivation routines, a plan to build new a new cattery, a recap on decision making models. These conversations take place around a table, re-purposed from old signs found on site before its new inhabitation; akin to war talks which would have taken place here many moons ago; but much friendlier this time around.