

INTERIOR ARCHITECTURE & DESIGN
BA (HONS)
WORKBOOK

FATIAH SAIF KHAN
2020 - 2023

The Illustration of Calligraphy

LOCATION

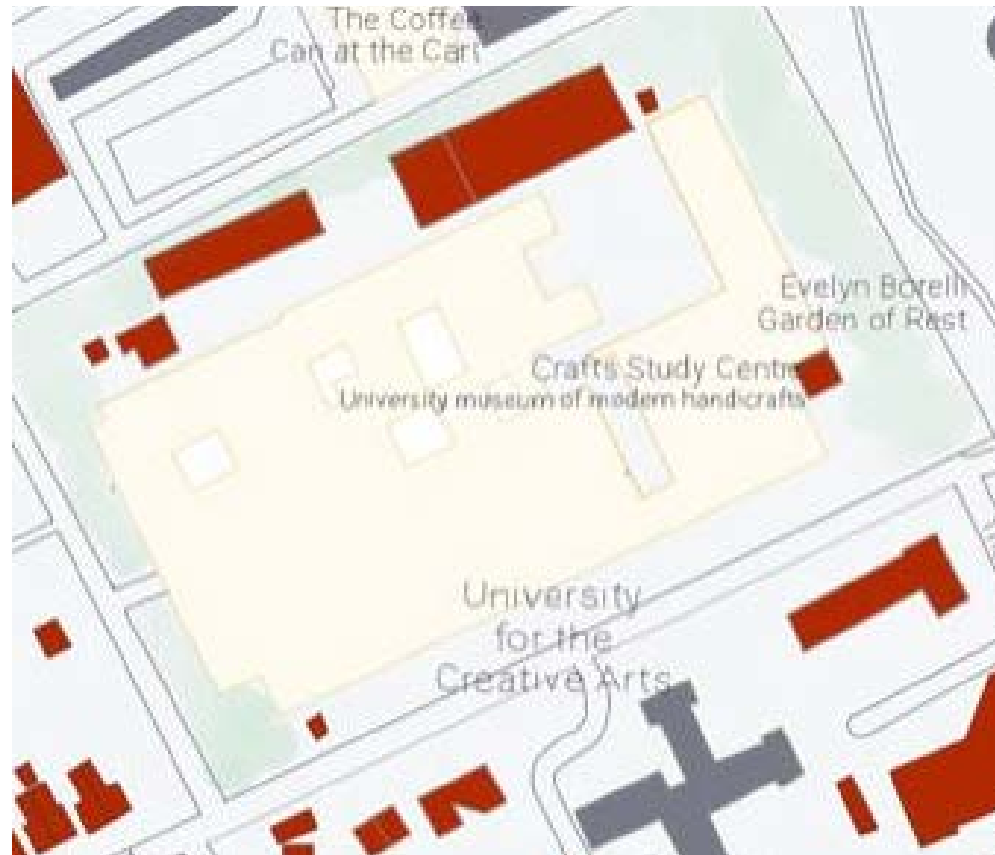

Farnham is a town in Surrey, England, located about 42 miles southwest of London. Farnham is known as "Craft Town" as well. The town is home to Farnham Castle, Farnham Park and the Museum of Farnham, which showcase the town of history and culture. It also has a vibrant arts scene, which has galleries, theaters, and music venues. Farnham is also known for Georgian Architecture, Historic Buildings with many well-preserved buildings from the era and picturesque countryside.

THE SITE



Study Craft Center, the Museum of Farnham, runs a range of educational programs such as Workshop, Exhibition, Research Center and Shop, which showcase the history and development of craft in the area. Study Craft Center has a modern collection of over 6,000 display objects, which include Calligraphy and Lettering, Ceramic, Furniture, Textiles and Archives which contains photographic, diaries and notes from the makers and artist from the 20th and 21st centuries. In formation of craft center, provides a valuable resource for researchers, students and artist. "The Craft Study Center is a specialist university Museum open to the public as well as a research center and home to internationally renowned collection of modern British Craft" (Craft Study Center).

SUN ORIENTATION:

WINTER

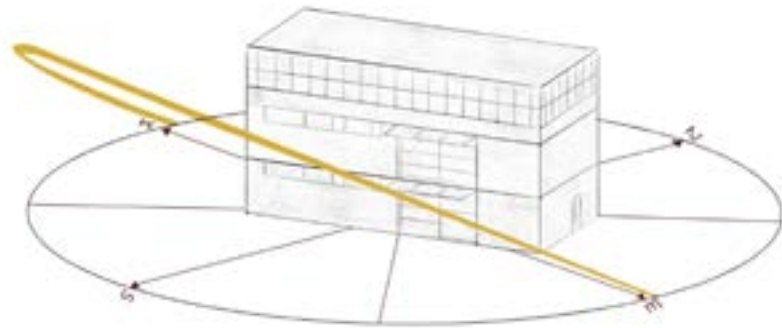

In Winters, between the month of November till January, the Site recived daylight between 09:00 to 15:00

SUMMER

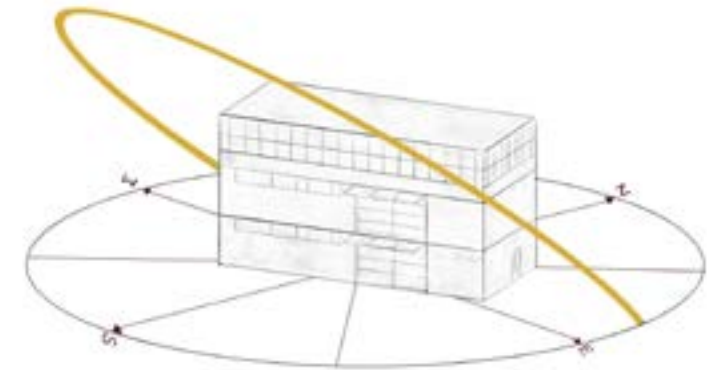

In Summer, Spring and Autumn between the month of April till August, the Site recived direct sunlight between 07:00 to 15:00.

ANALYSIS:

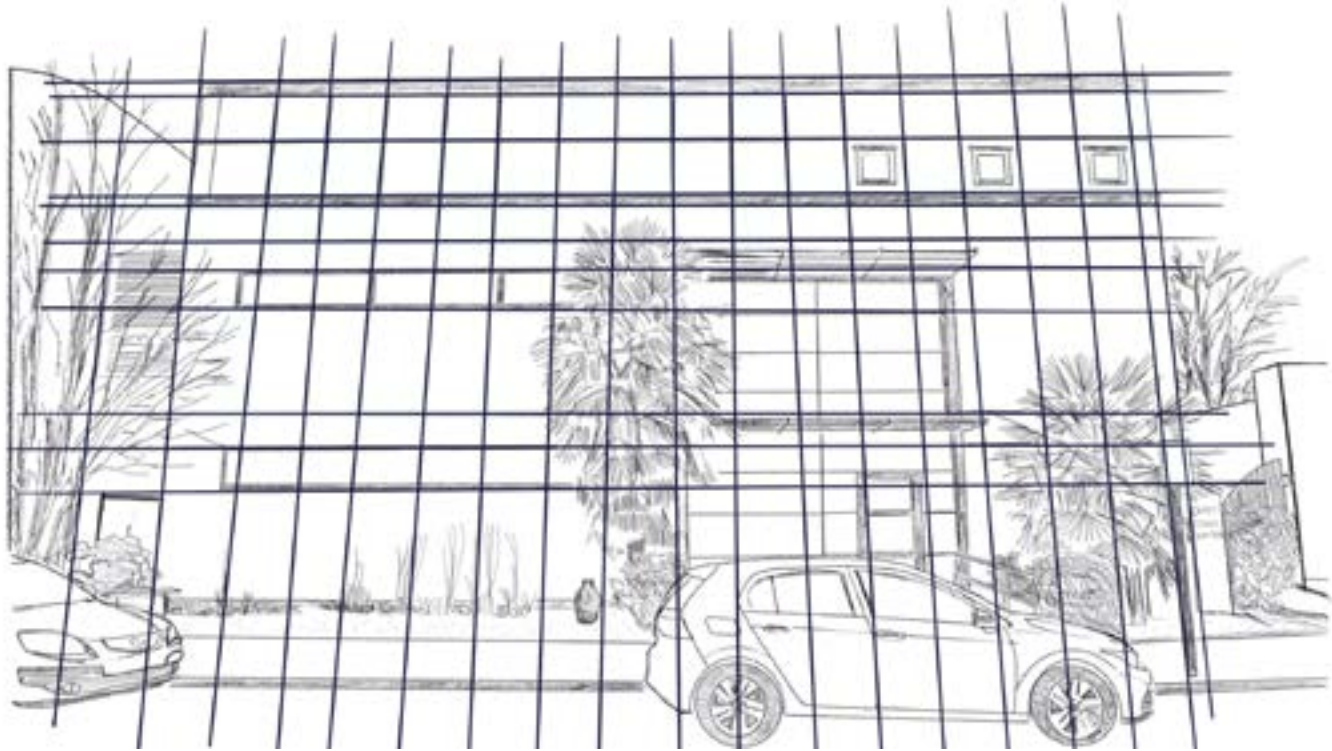

Site was analysed using Geometrical Grid

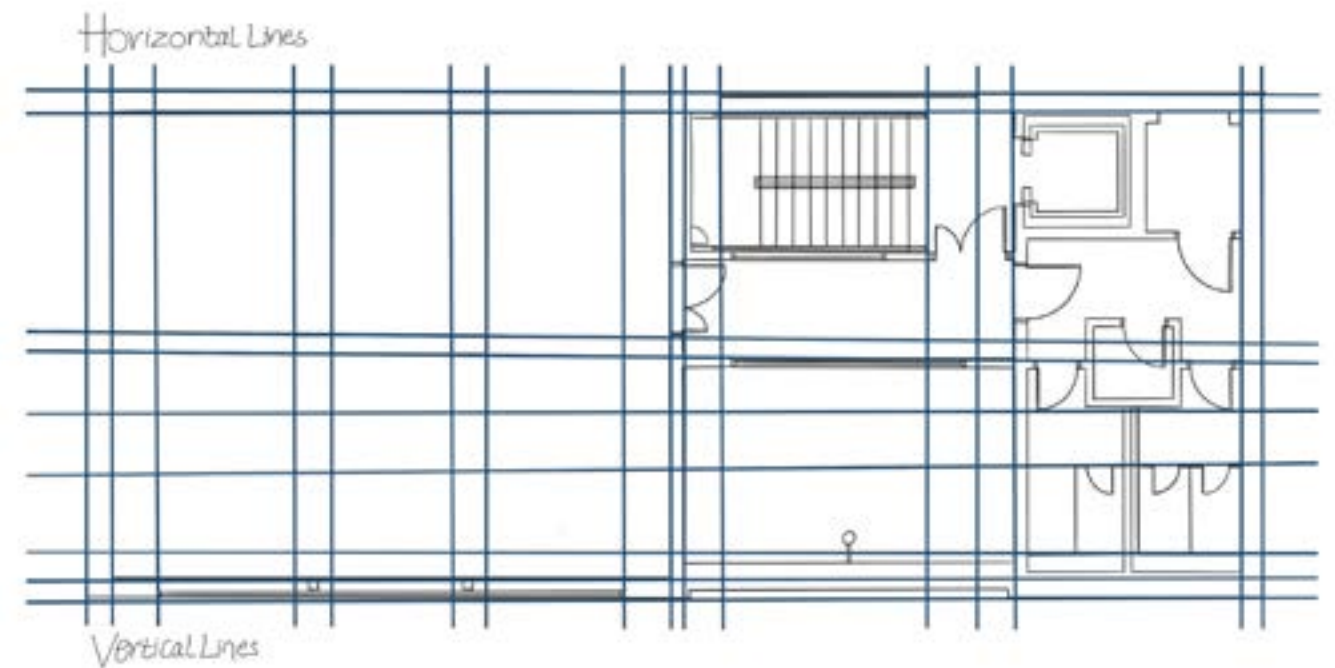
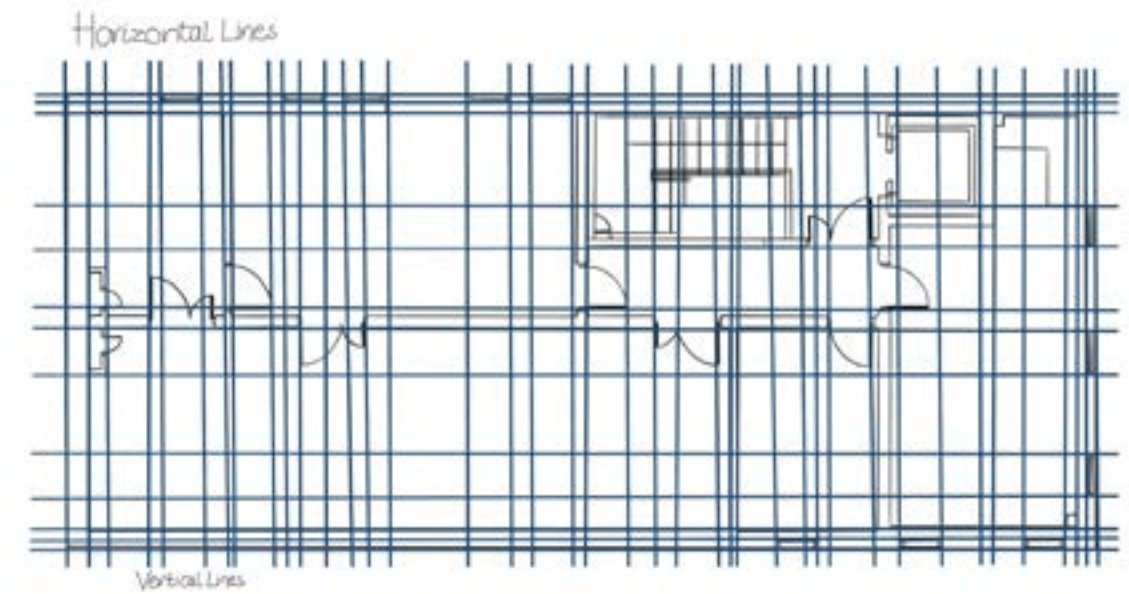
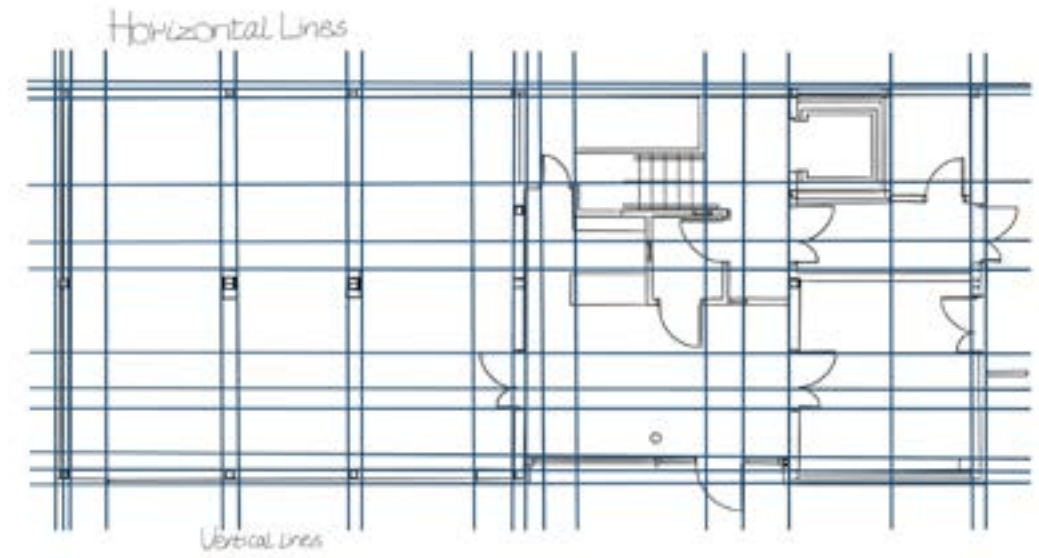

SITE SURVEY:



EXISTING EXTERIOR MATERIAL

Cream Render
Aluminium
Tinted Glass
Anodised Aluminium
PEA Gravel

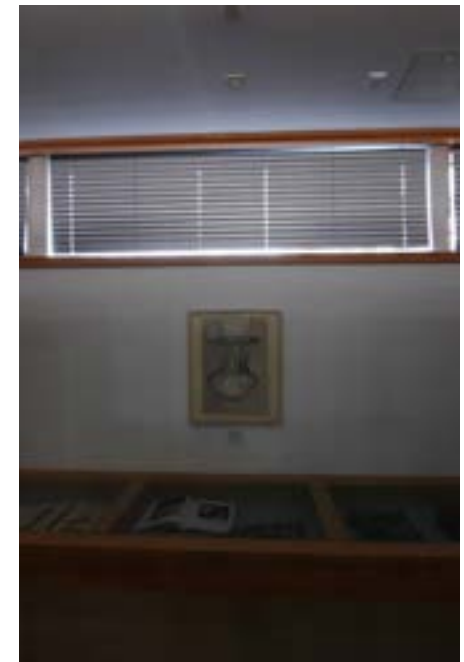
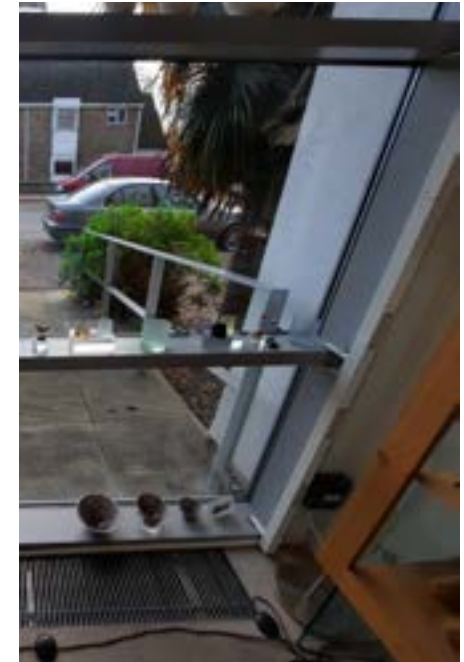
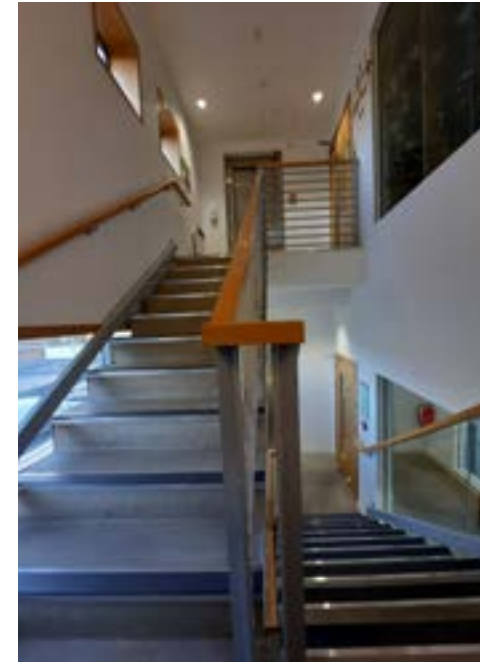

INTERIOR EXISTING MATERIAL









Concrete Staircase
Steel Supports
Lighting Raft
Timber Window Frame

CONCEPT RESEARCH:

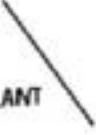
The word “calligraphy” originates from the Greek language, and means the art of beautiful writing. Even centuries ago, it gave people all over the world the opportunity to communicate with each other. In order to achieve optimal results, it is advisable to learn the basic techniques of calligraphy first. Enjoy experimenting with different colours, techniques and nibs.

In the art of calligraphy, making each stroke take roughly the same time. To work with control, the user should start working at a slower pace, and increase pace later. The rhythm is especially important for those who want to display their writing in a variety of media.



MANUSCRIPT BASIC STROKES	HORIZONTAL 	VERTICAL 	SLANT 	CIRCLE 
CURSIVE BASIC STROKES	SLANT 	UNDERCURVE 	DOWNCURVE 	OVERCURVE 

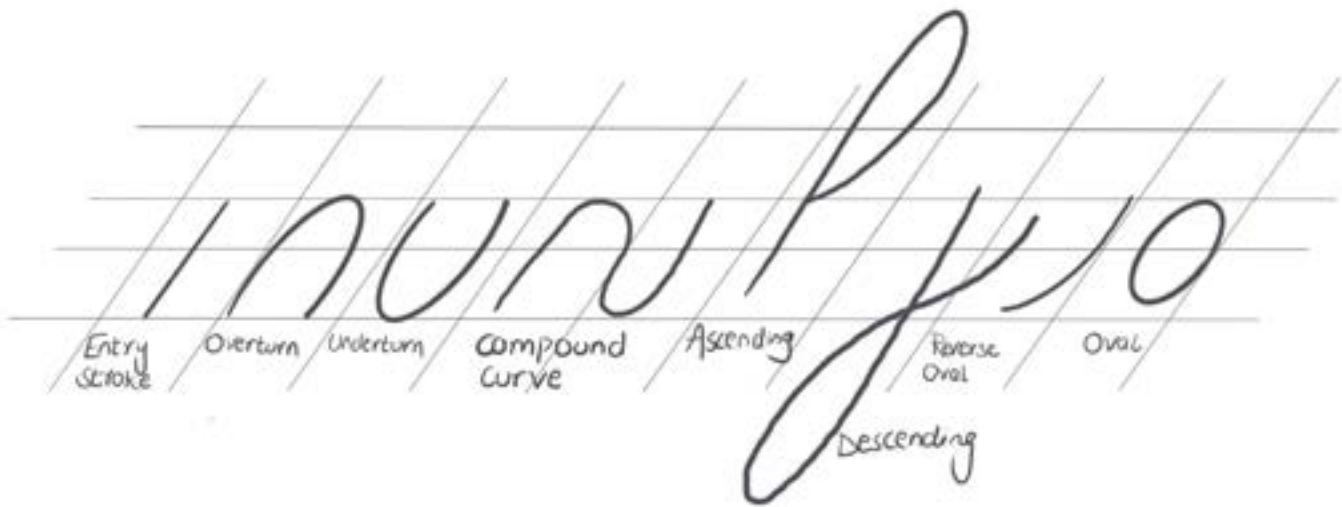

According to stroke
its on a guide lines.

The 8 Basic Stroke of Calligraphy

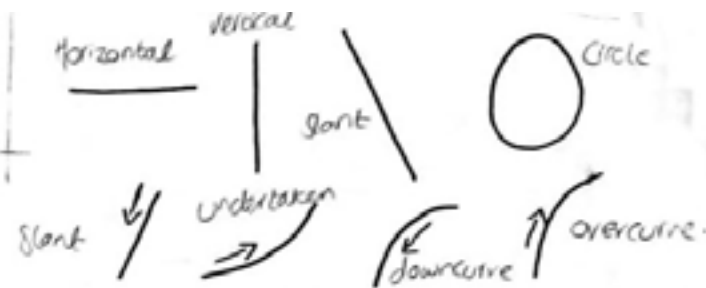

Entry Stroke

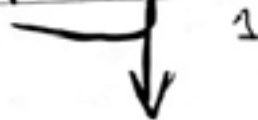

- Entry Stroke know as Entrance stroke.
thin — & curved line found at the beginning & end of the letter.
- Entry stroke found in the 'b', 'c', 'a' & 'g'.

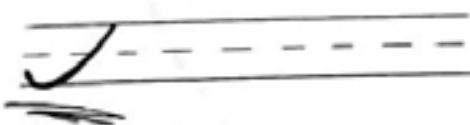

Underturn



Underturn Stroke Starts with heavy pressure coming down. Curve at the bottom & finishes off with a light pressure. find in the letter 'a' & 'i'.

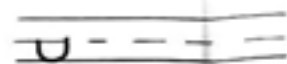

Overturn



Overturn is the same as an underturn but upside down. Starts at the baseline, with the thin light pressure going up, curve at the top & then go back down with thick pressure coming down. find in the letter 'n'.

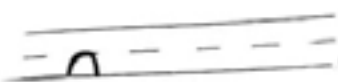

Compound Curve



Compound Curve Stroke is a combination of an overturn leading into an underturn. Starting at the baseline, draw up using light pressure, curve around the top the plunge down to the baseline with more pressure & finish with a light overturn.

find in the letter 'm'.

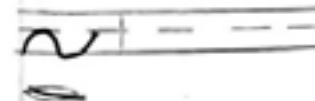

Oval

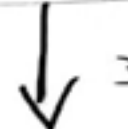

Oval stroke its starts at around 2 o'clock at the oval, drawing counter clockwise. Paying attention to apply more pressure on downstroke & use less pressure on the upstroke.

find in the letter 'a' & 'g' also in partial oval 'c'.



Ascending stem loop



Ascending loop Starts at the header line with a thin curved line up, then turn down with a thick stroke straight down & always parallel to the practice sheet start line. find in the letter 'b' & 'c'.

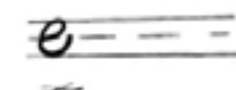

Descending stem loop



Descending loop looks kind of like a lowercase 'j'. Starts at the header line, goes down below the baseline, curve around & loops back in. find in the letter 'g'.

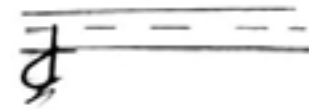

4 Types of Calligraphy / Lettering to learn

Basic (aka monoline calligraphy)

Monoline calligraphy is the first step to write. It doesn't require any fancy tools or paper (like the other style of calligraphy).
Only need paper or pencil & getting right into practicing.
Example:

Basic
Basic
BASIC

Loopy Calligraphy (aka Modern Calligraphy)

In Modern Calligraphy consistency, spacing & formatting isn't as important. It gets the desired stroke shape & it's pretty popular to Instagram community. Use pointed pen.
Example:
a b c d e f
g h i j k l
m n o p q r
s t u v w
x y z

Old English / Heavy Metal Calligraphy (aka Blackletter Calligraphy)

The line variation is low compared to the pointed pen as there is no difference in line when you apply more pressure depends on angle in which more or less.
Ornate, bold style of type & typically resembling Gothic we broad edge pen.
Example:
a b c d e f g
h i j k l m n
o p q r s t u
v w x y z

Fancy Calligraphy (aka Spencerian Copperplate)

Classic diff pen / pointed pen script is similar to modern calligraphy but more strict on size, spacing, consistency & formatting.
Example:
Aa Bb Cc Dd

CLIENT AND PROPOSAL:

*The Society of Scribes
& Illuminators*

CLIENT:

The Society of Scribes and Illuminators is a group of calligraphers and illuminators in the United Kingdom. The Society of Scribes and Illuminators is a UK-based organization that promotes Calligraphy through courses,

The Harmonisation of Calligraphy

CLIENT PROPOSAL:

The Society of Scribes and Illuminators wants to promote, educate and expand public knowledge about calligraphy. Through this they want to benefit and provide a community where people start thinking in a structured way with calm feelings, self-control and discipline.

CALLIGRAPHY CONTROLS:

Letters on strokes, grid line are in angle and taking space. All the elements are controlled and in line when putting in grid.

Control the hand on the grid line with deliberate intent. The Society of Scribes and Illuminators wants to do an Exhibition and Workshop with the Study Craft Center

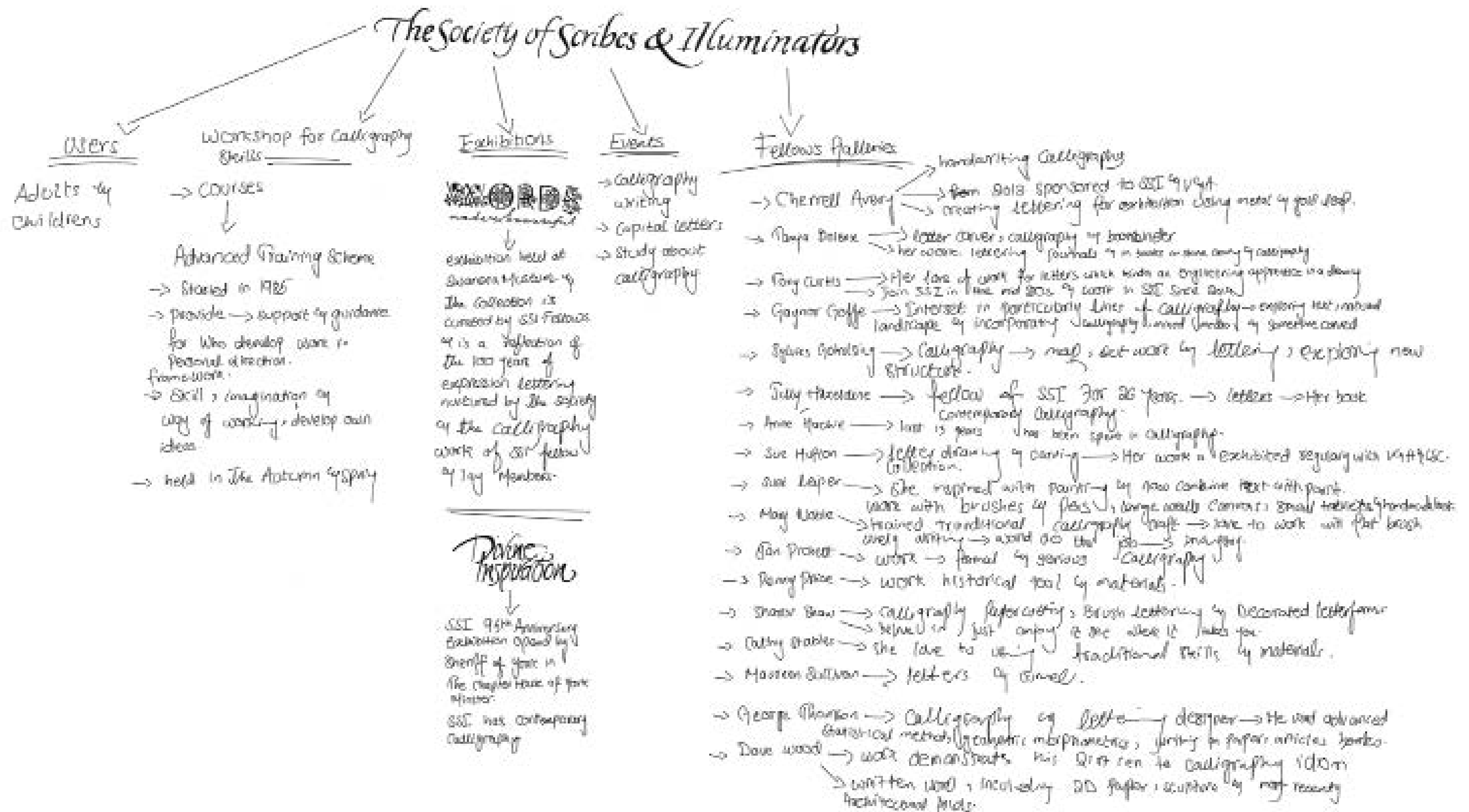

HEAVY PRESSURE:



Geometrical Control, Hard Materials and Control Spaces

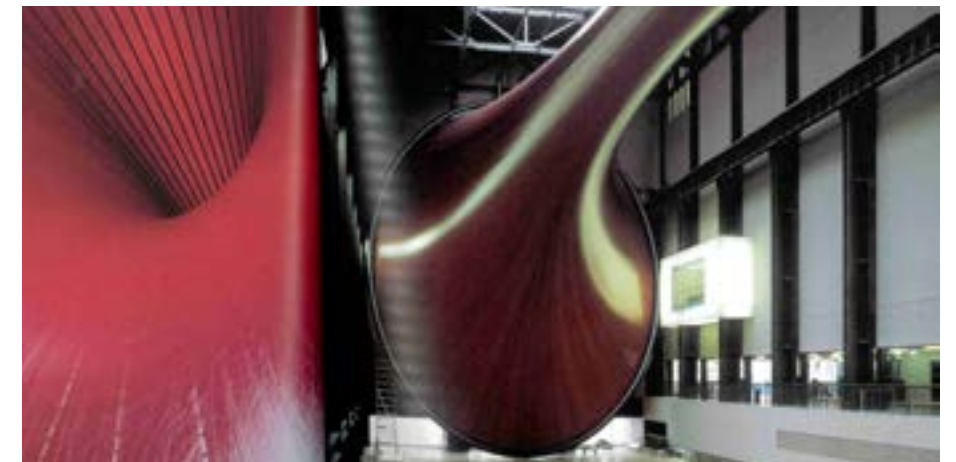

PARALLEL:

Geometrical Control. Geometrical Control. Hard, Mate and Shine

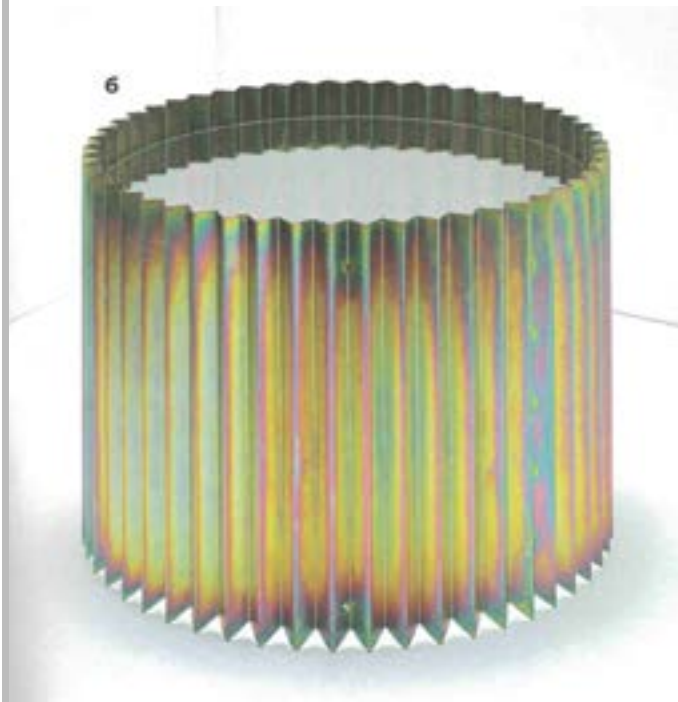

COMBINATION:



Combination of Materials joining the space.

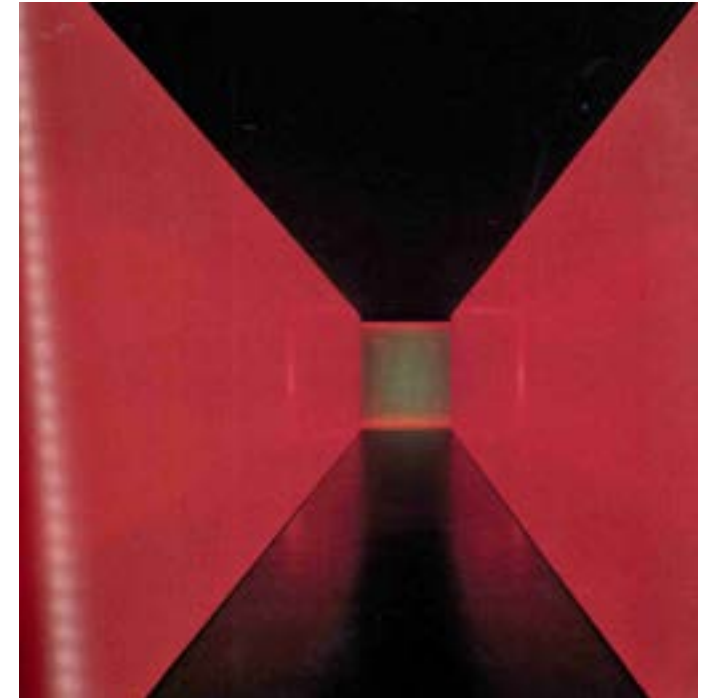

COUNTER:

Counter (Reply Each Other), Harsh, Rauf, Hard, Shine



ABSTRACT CIRCULATION:

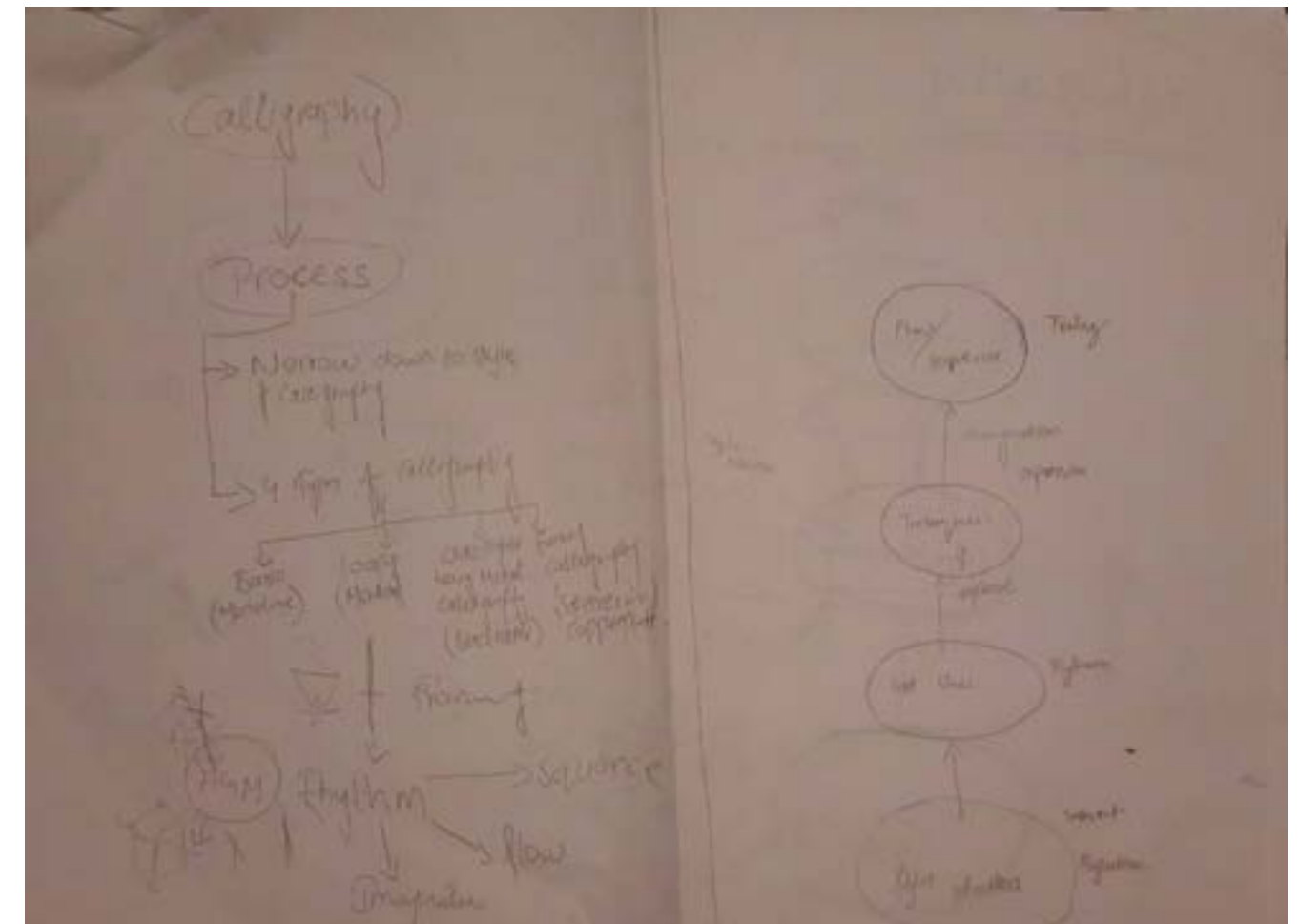
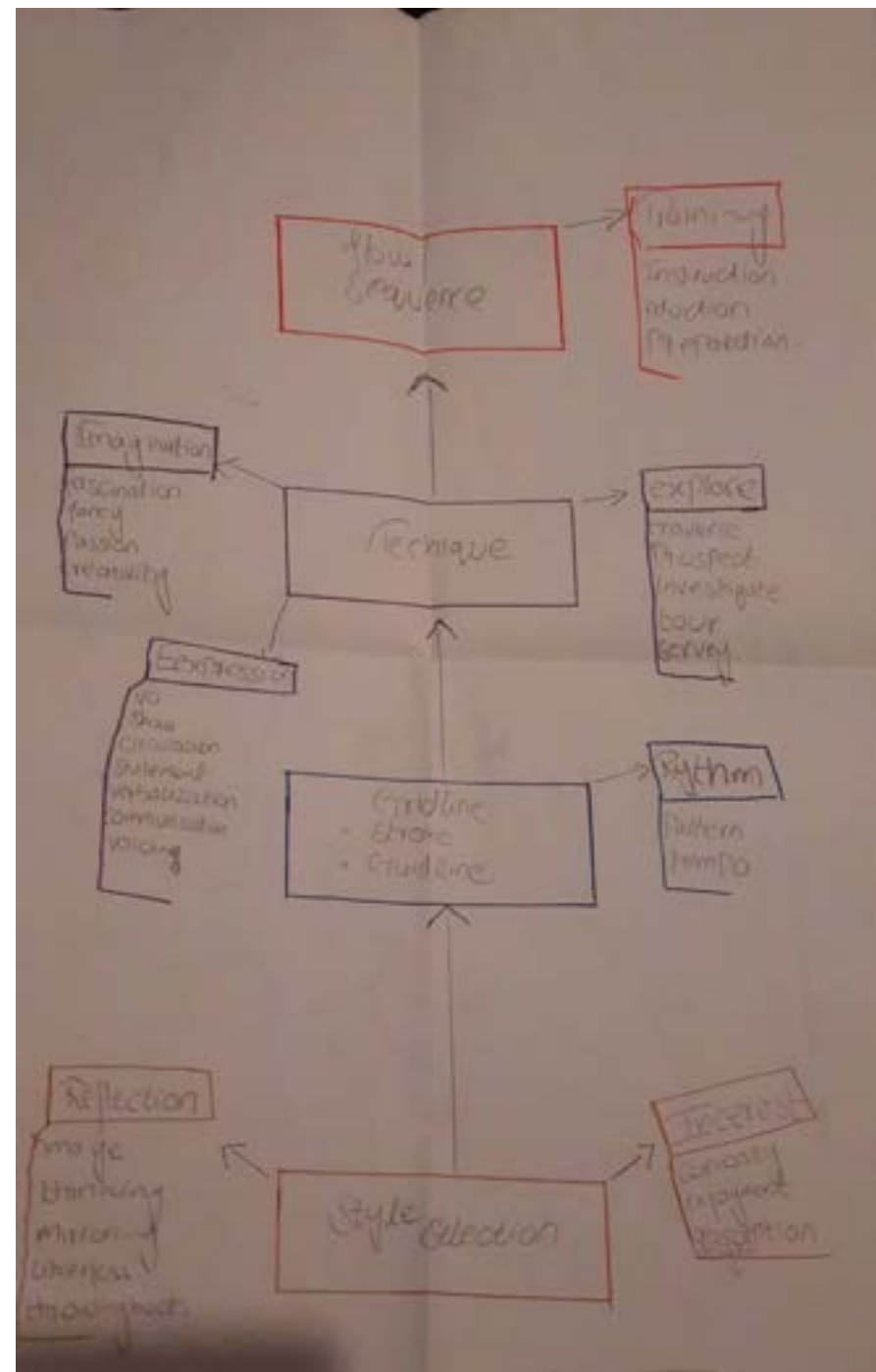

ABSTRACT CIRCULATION:

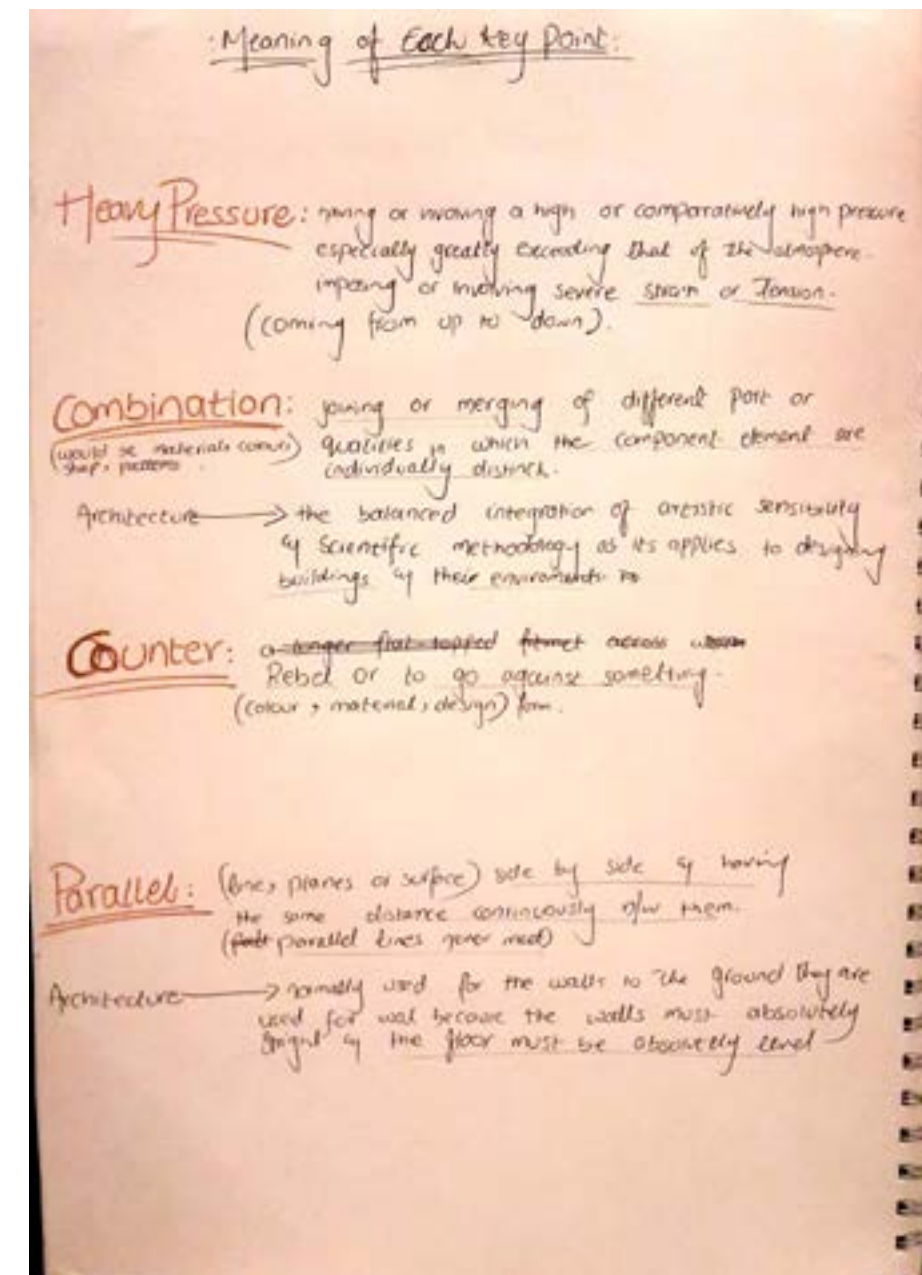
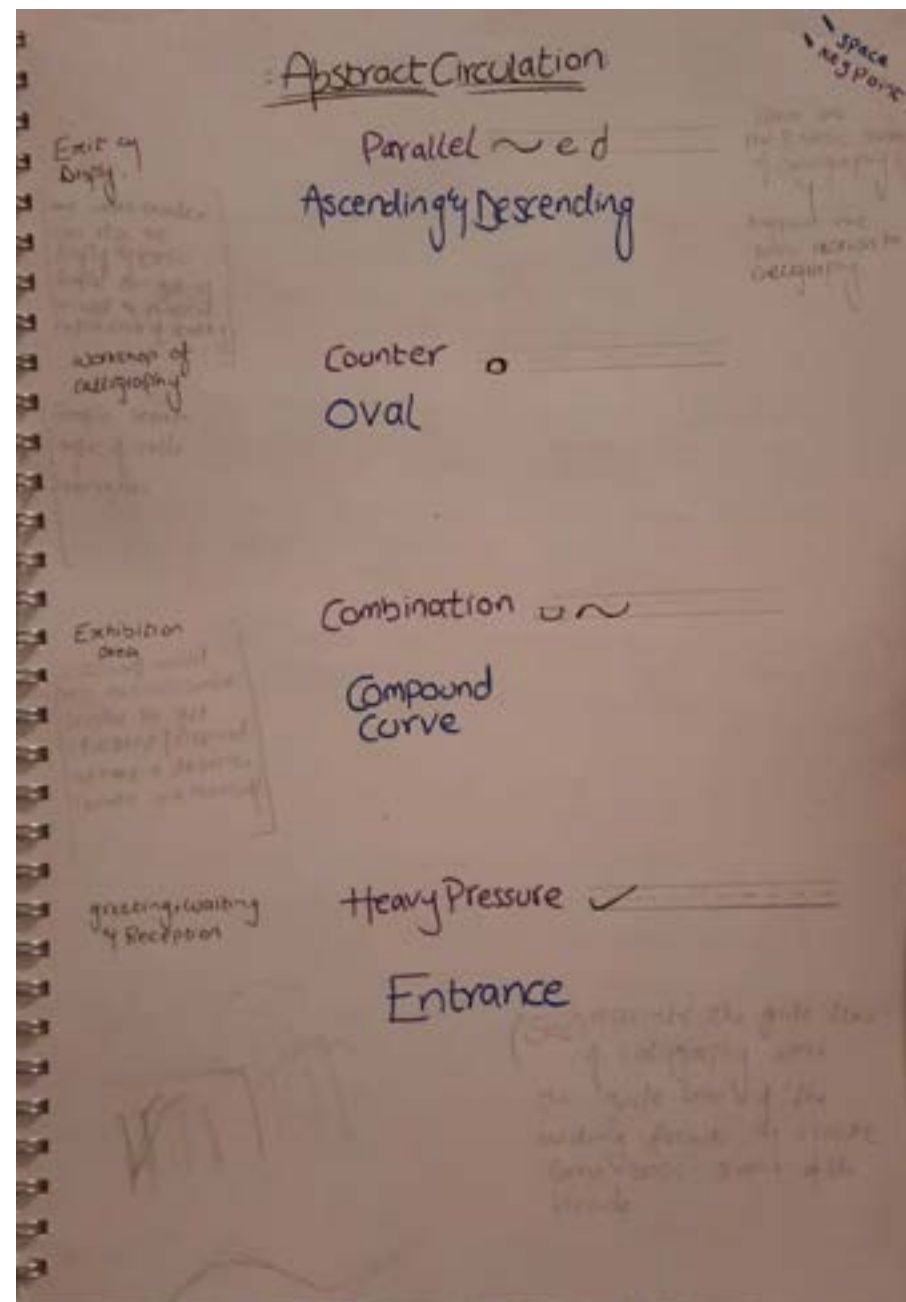

INITIAL SKETCHES AND ABSTRACT MODEL:

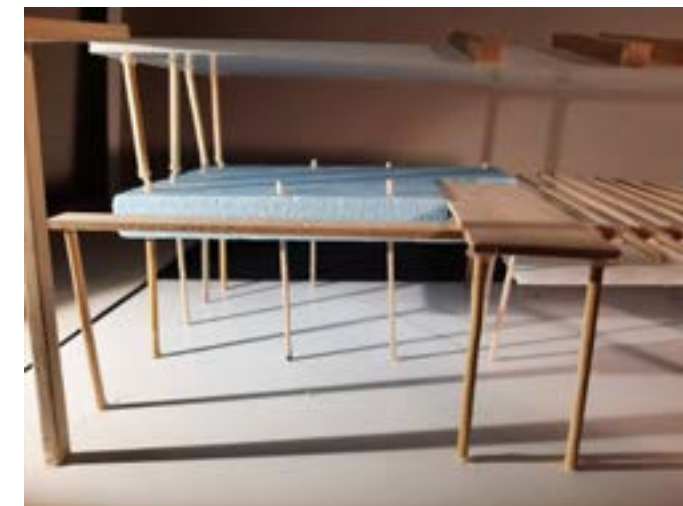
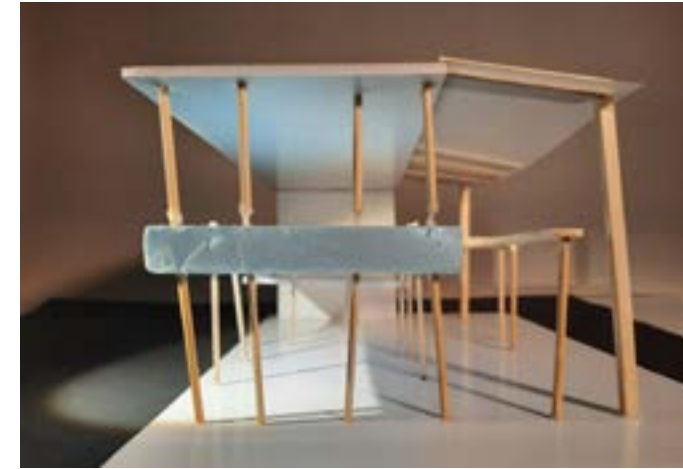
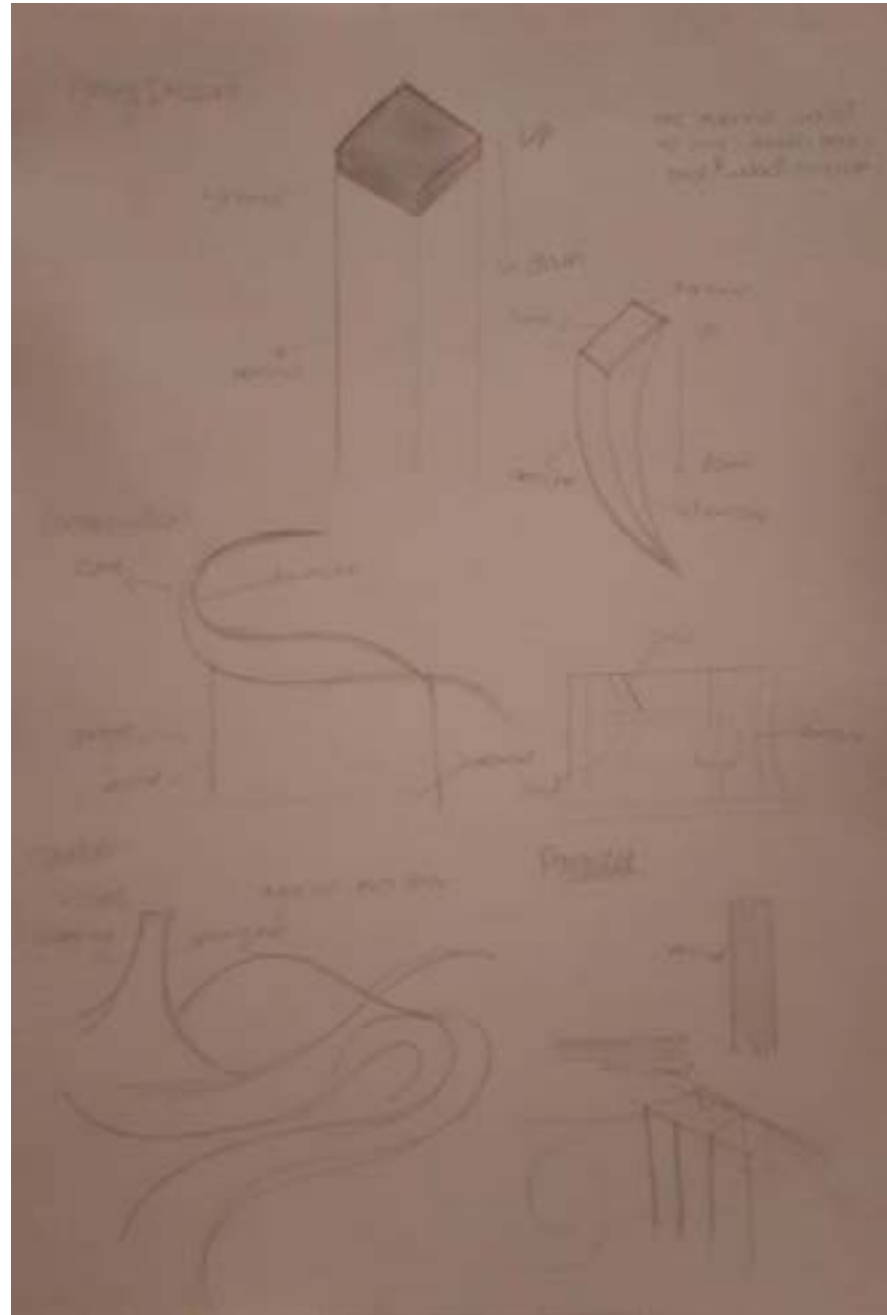

ABSTRACT MODEL:



Abstract Model based on Key Points

DEVELOPMENT DRAWINGS:

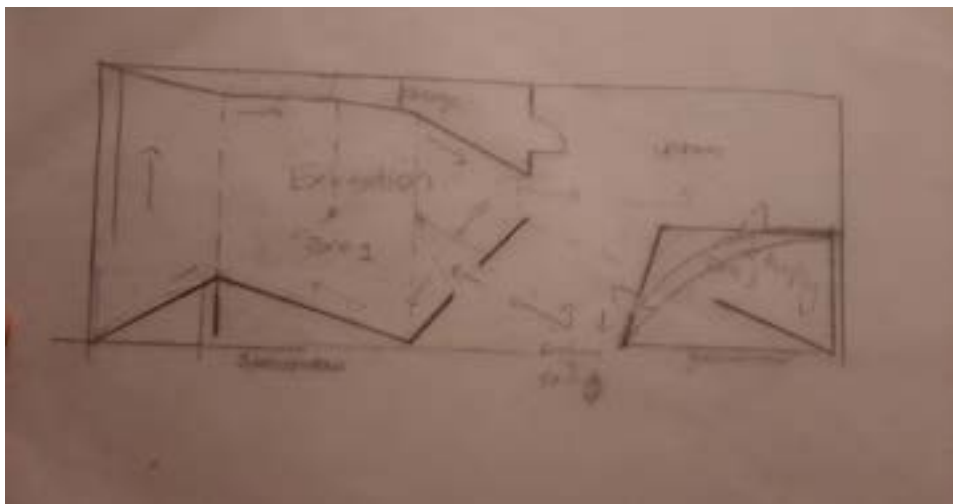
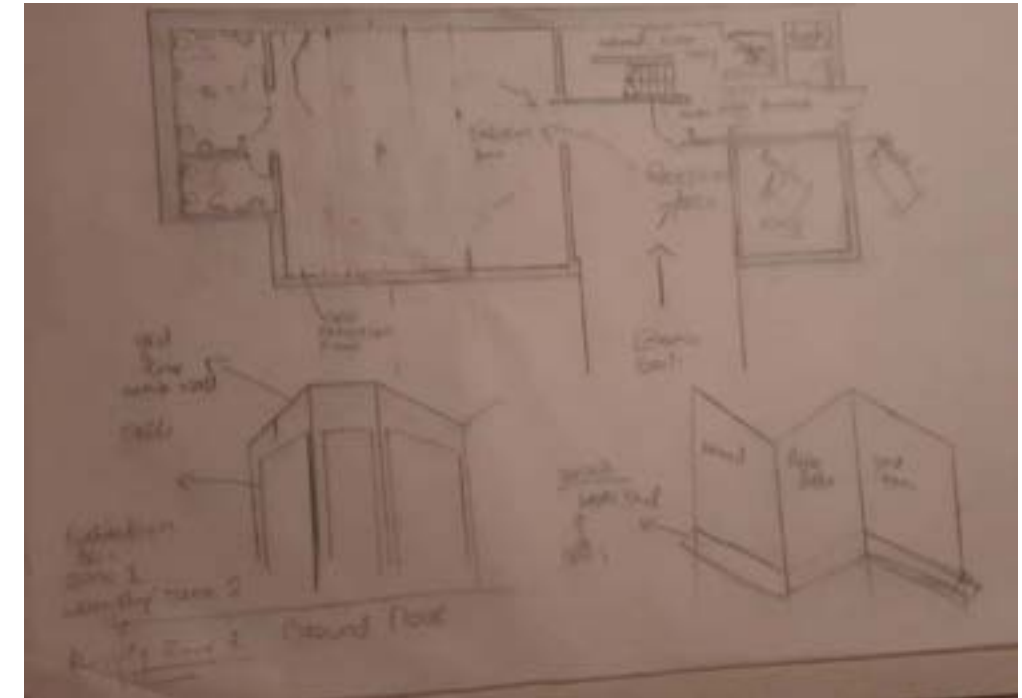
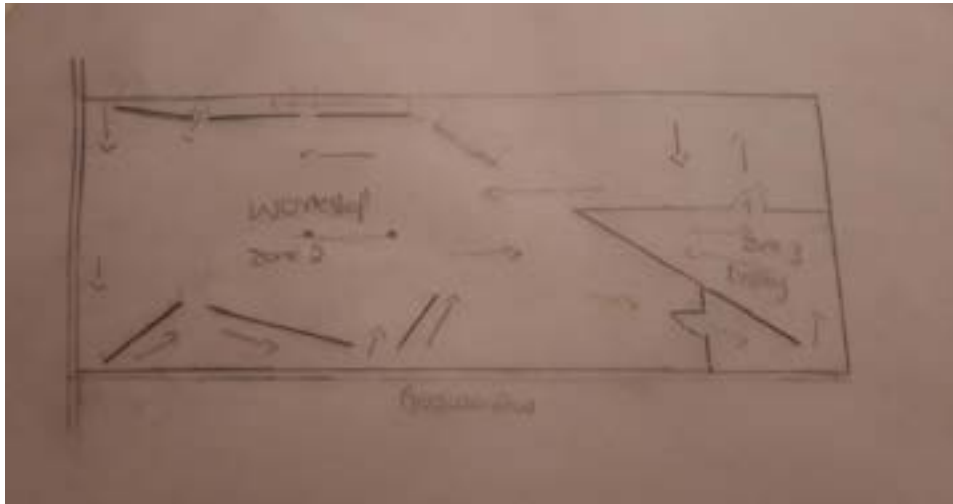

Initial Plan based on Grid

DEVELOPMENT DRAWINGS:

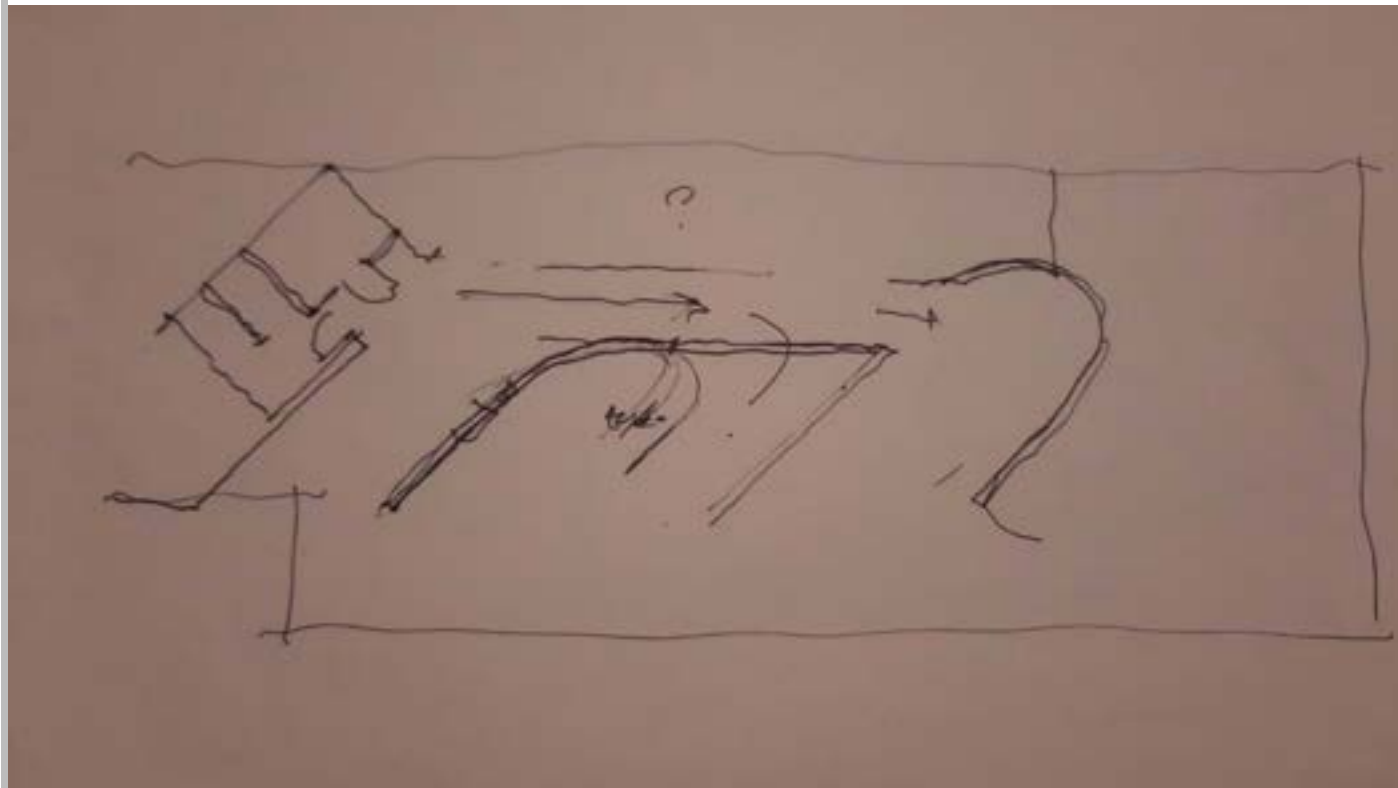
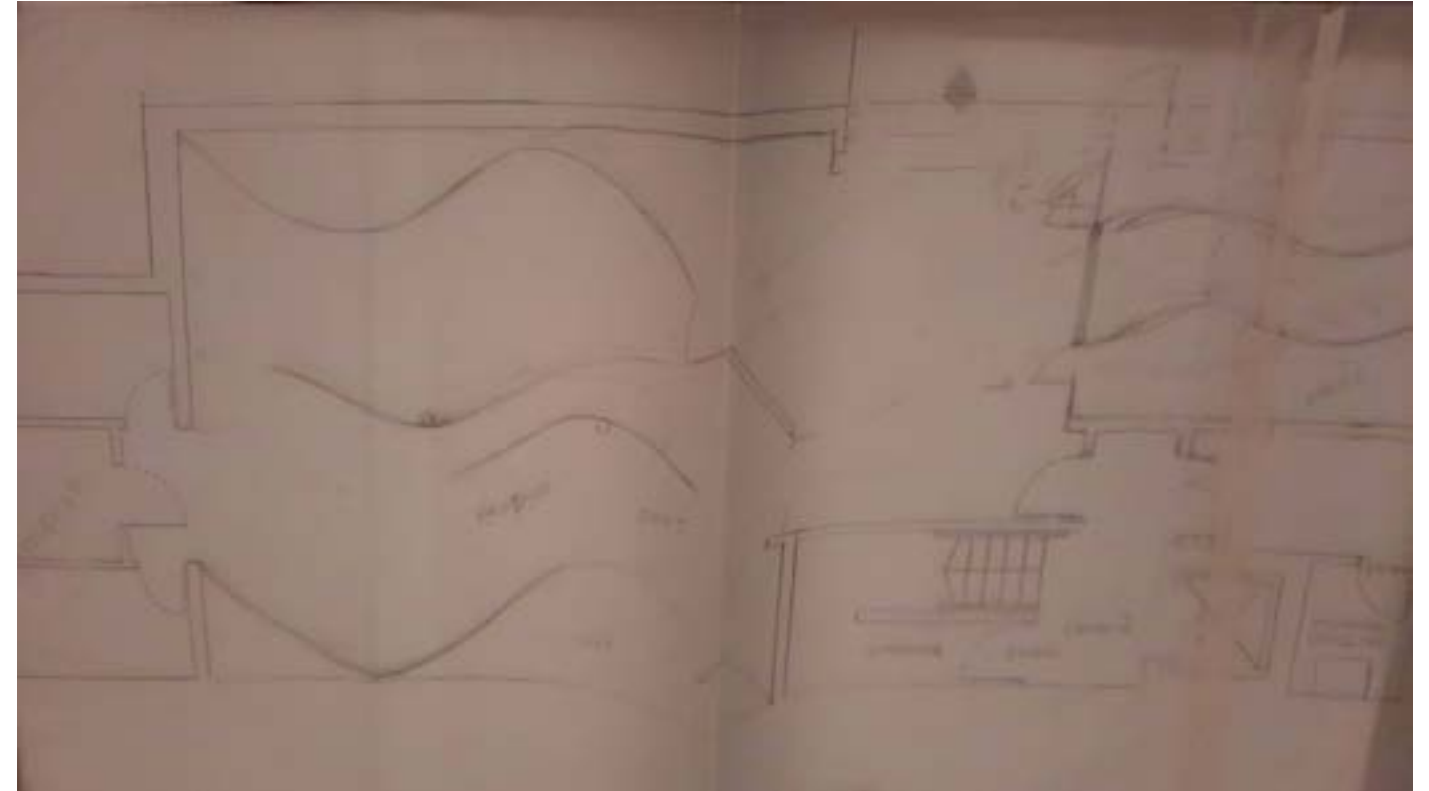
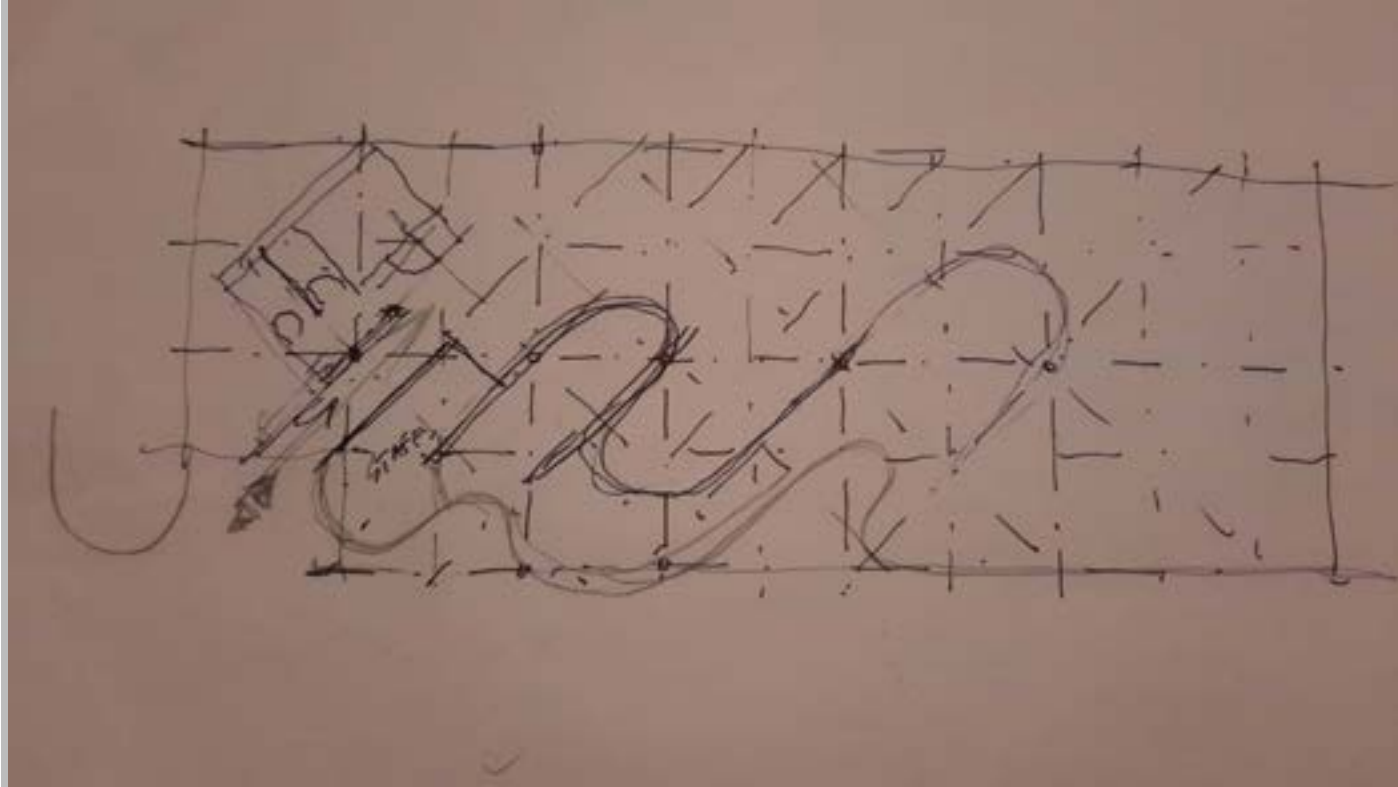

The Initial idea for curve structure.

PLAN & ELEVATIONS:

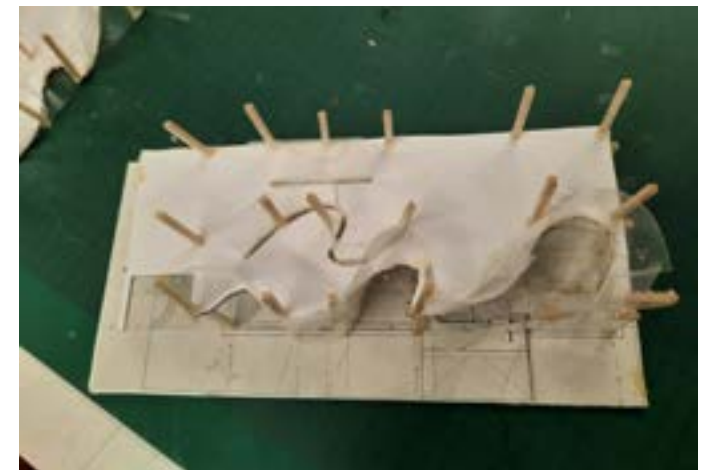
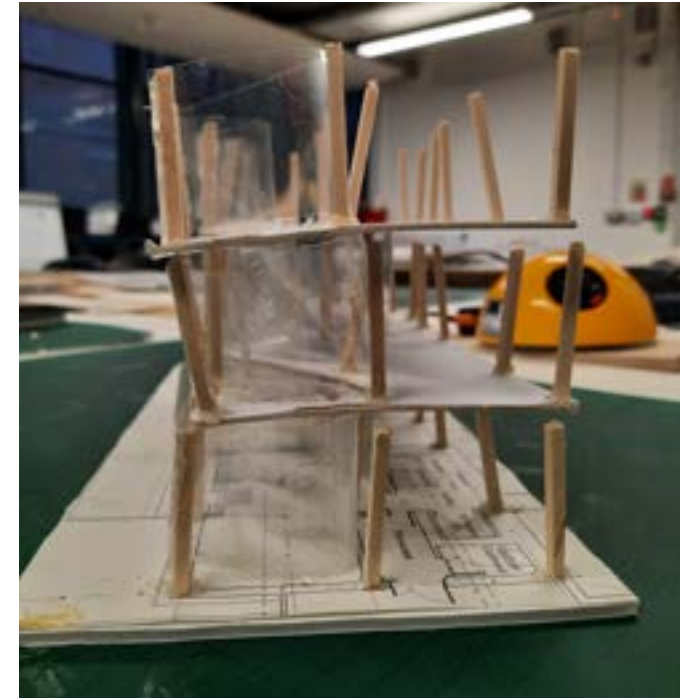
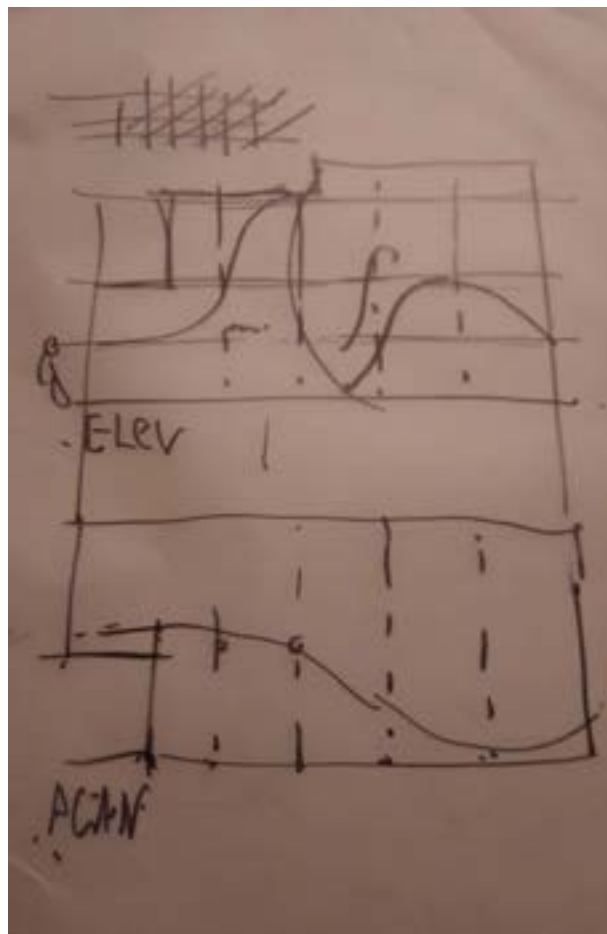
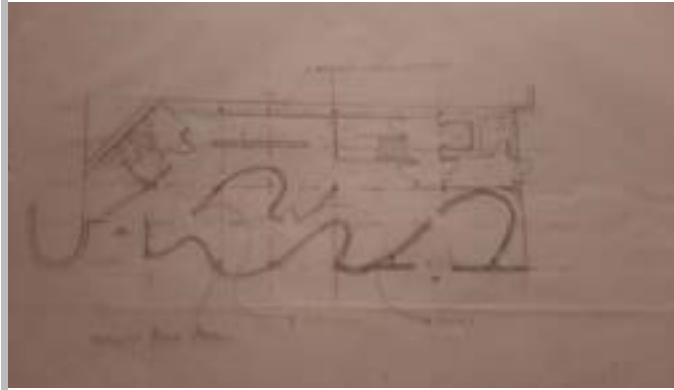

PLAN & ELEVATIONS:

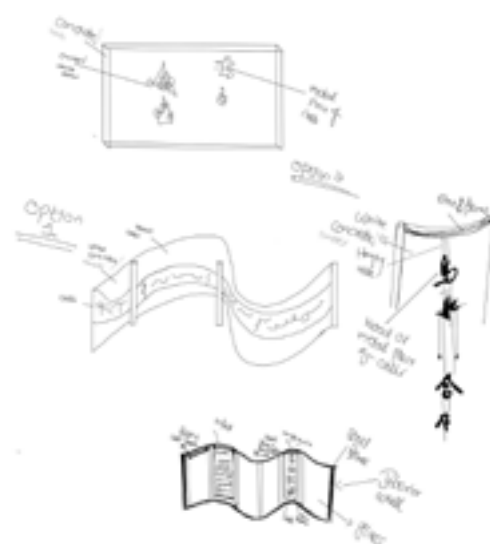
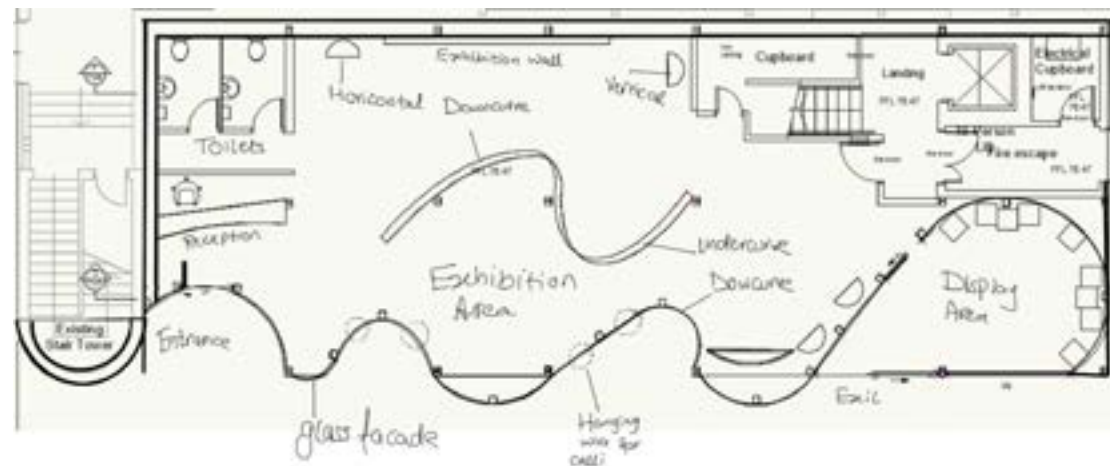
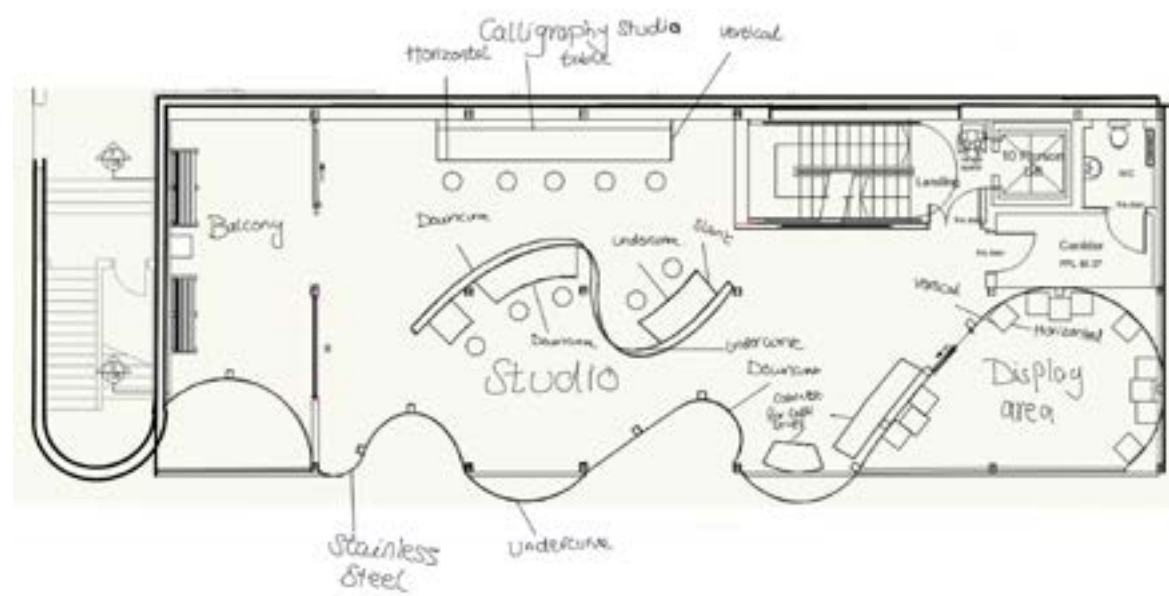

ANALYSIS OF PROPOSED PLANS:

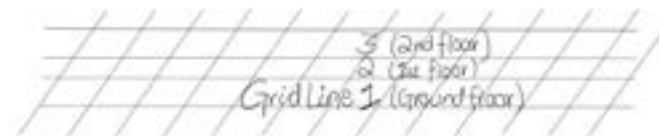
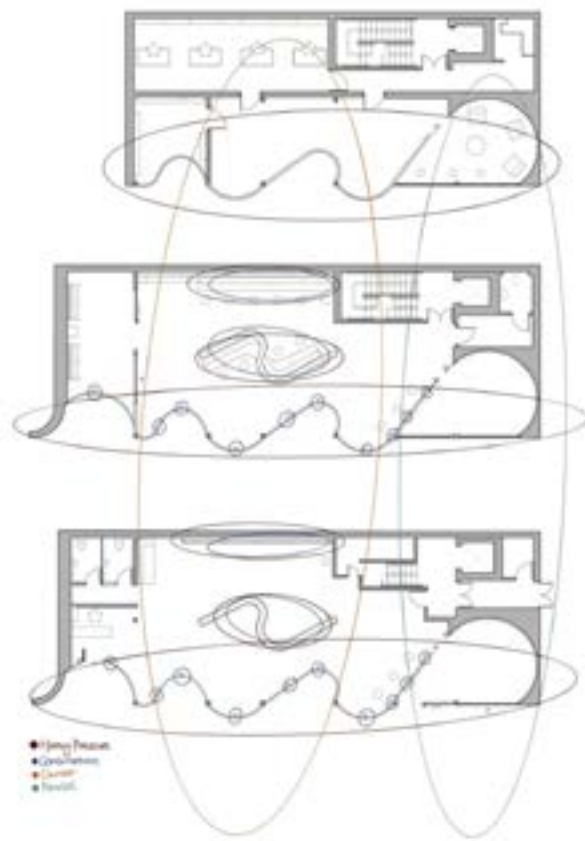

Horizontal lines

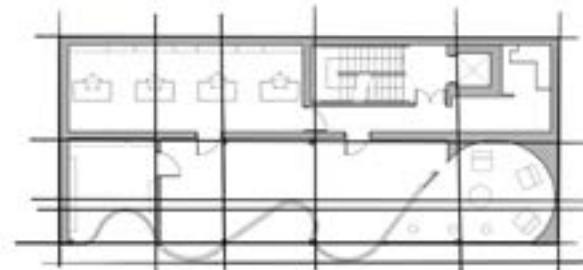

Vertical lines

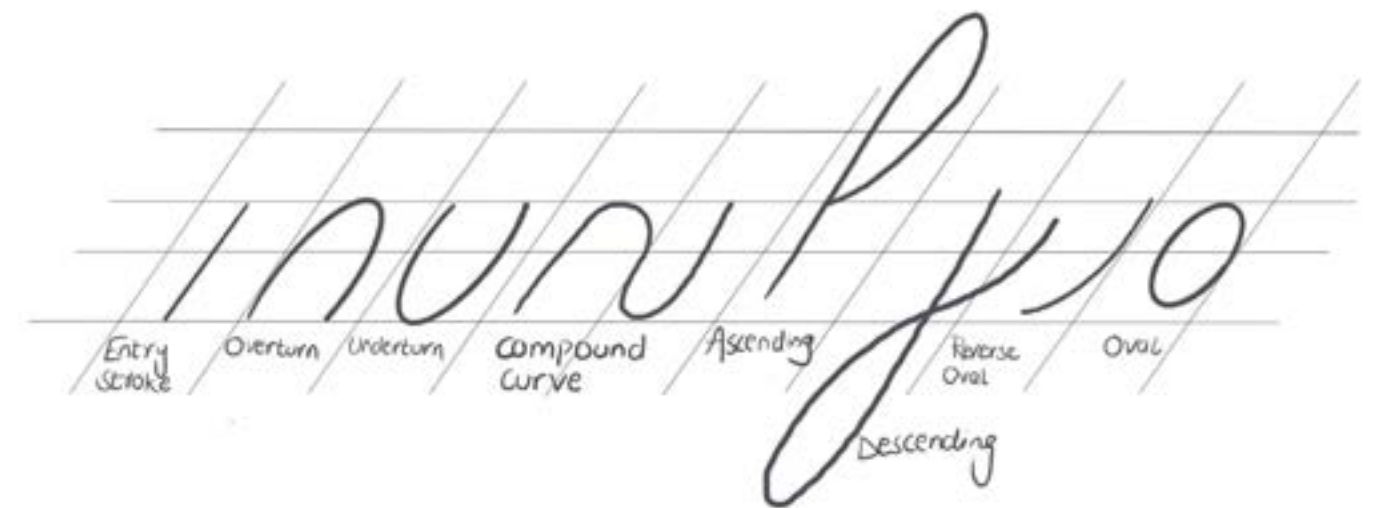
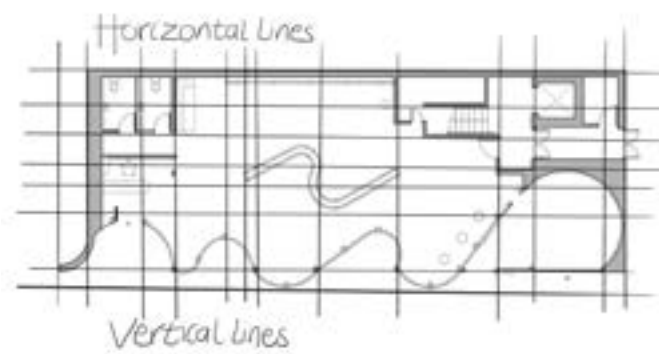

MANUSCRIPT BASIC STROKES	HORIZONTAL	VERTICAL	SLANT	CIRCLE
CURSIVE BASIC STROKES	SLANT	UNDERCURE	DOWNCURE	OVERCURE



Left and Right side concept

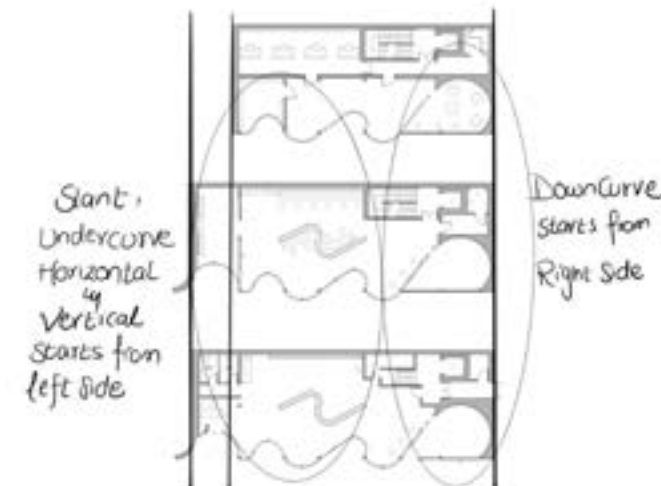
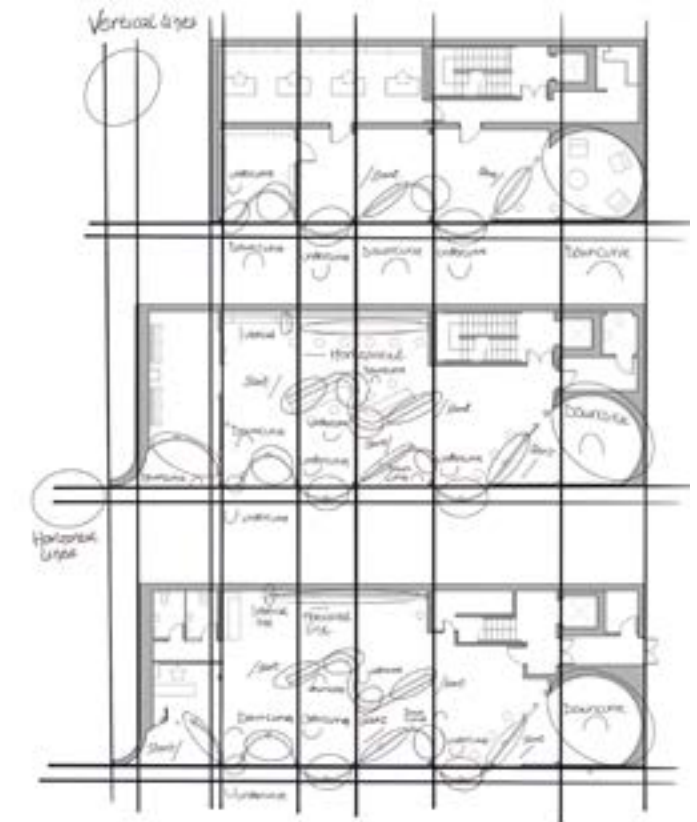

An interesting concept in the design, Chinese, Japanese and British Calligraphy starts from Left side and Islamic Calligraphy form Right Side. In left side different strokes are in design (as in Calligraphy from different culture start from Left to Right, while the Islamic calligraphy starts from Right to Left).

DETAILED MAQUETTE AND MATERIALS:



DETAILED FINDESIGN DEVELOPMENT

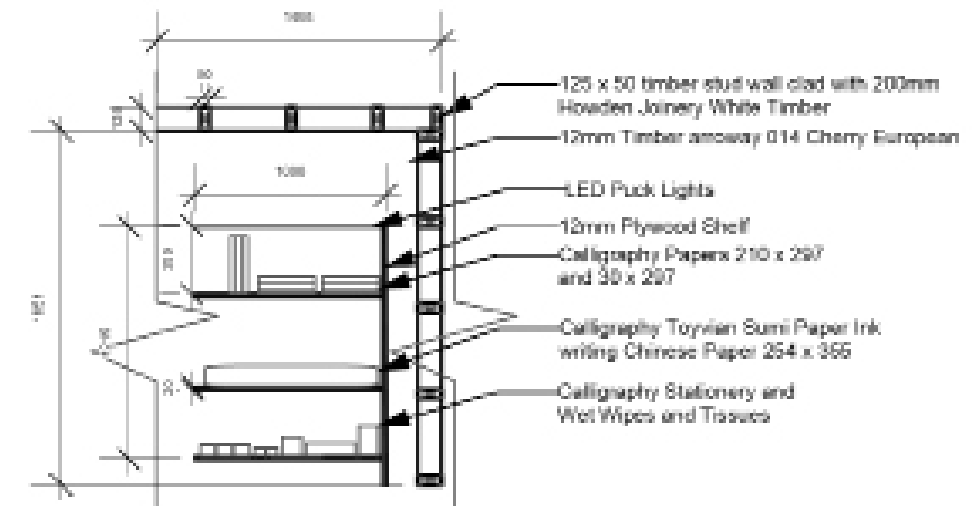
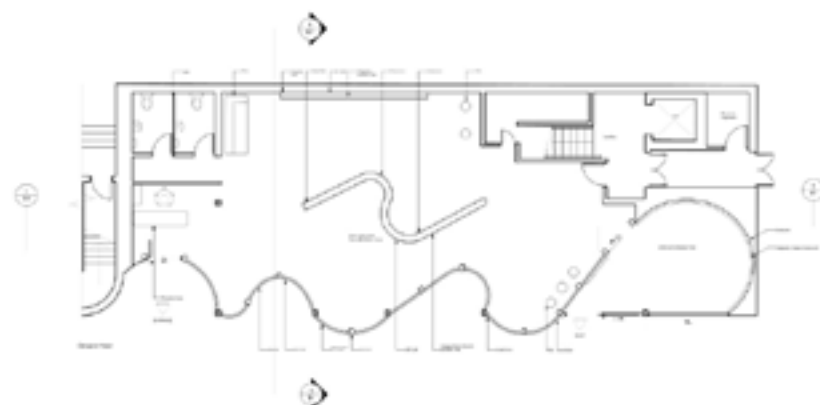
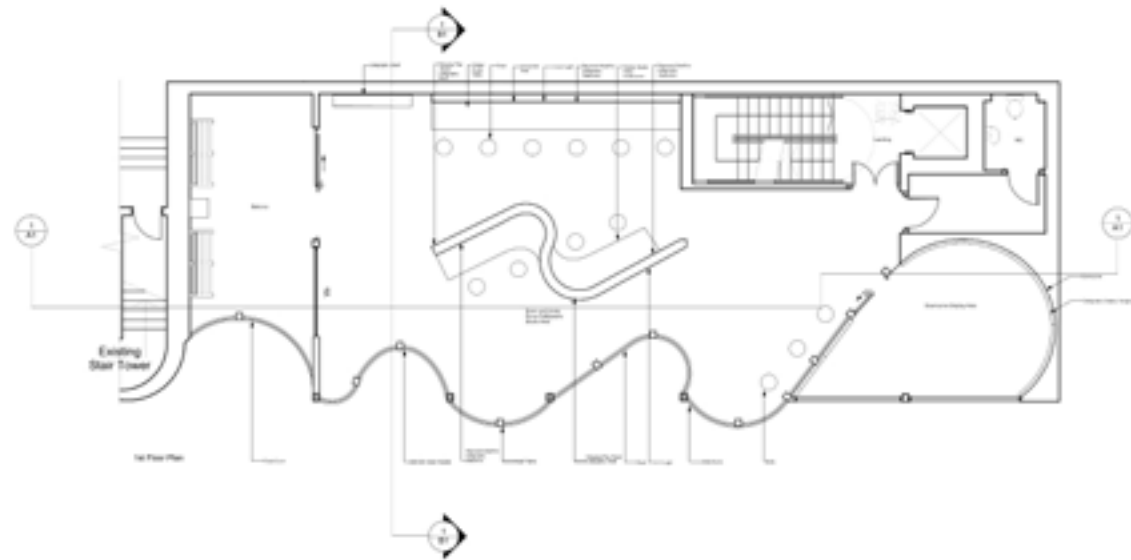
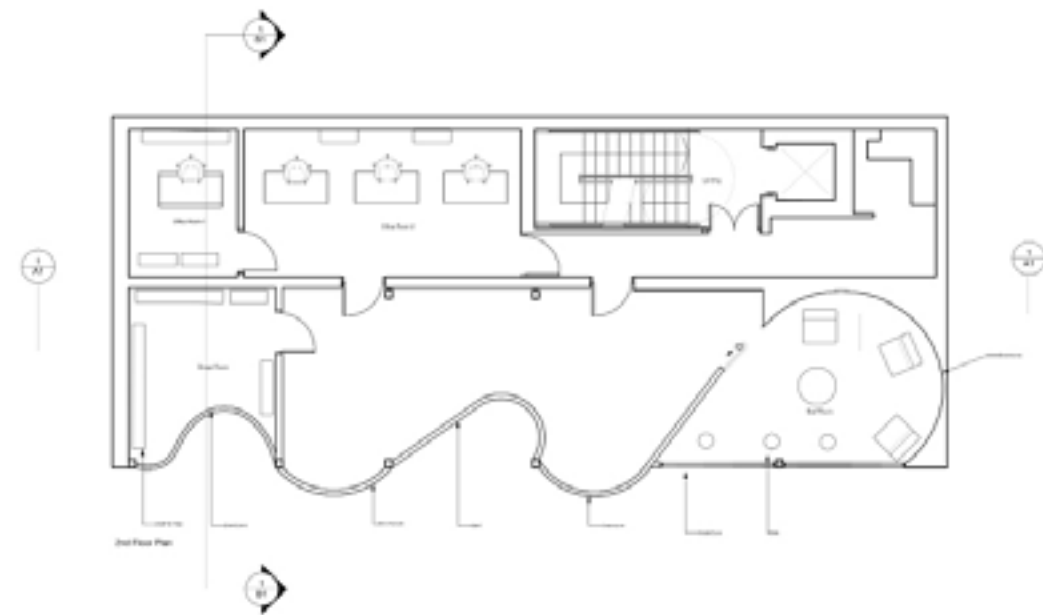

Section

Vectorworks Educational Version

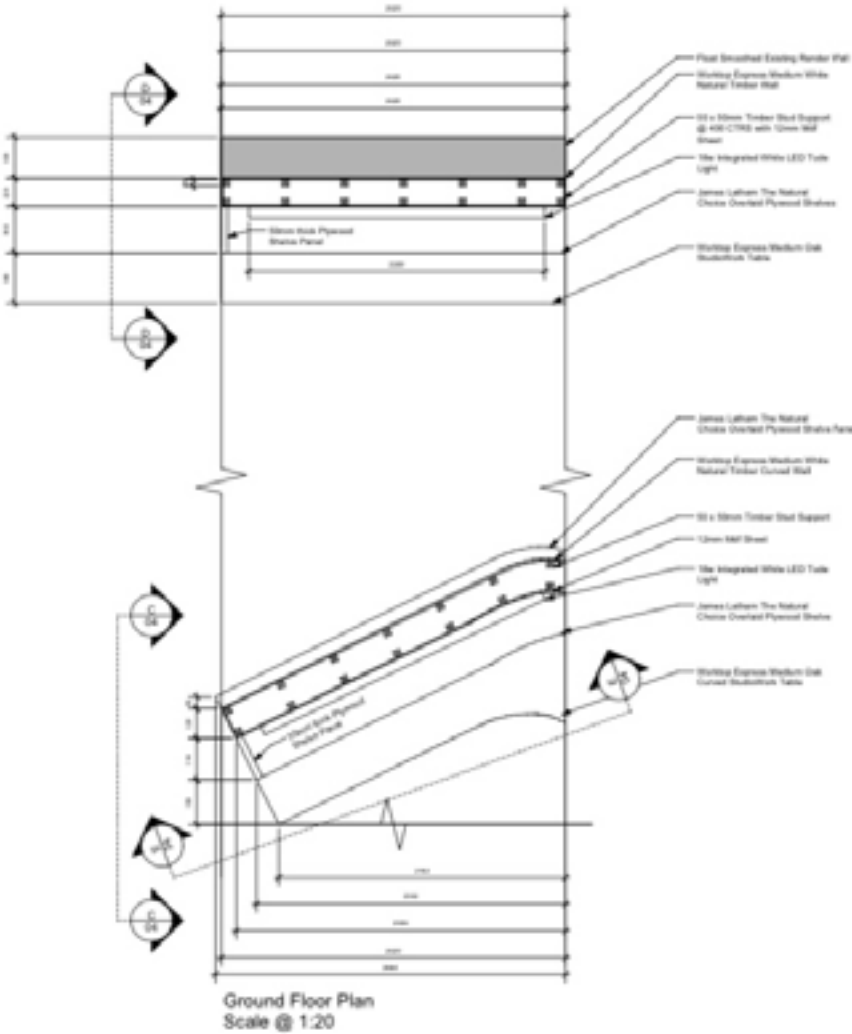

Vectorworks Educational Version

Vectorworks Educational Version

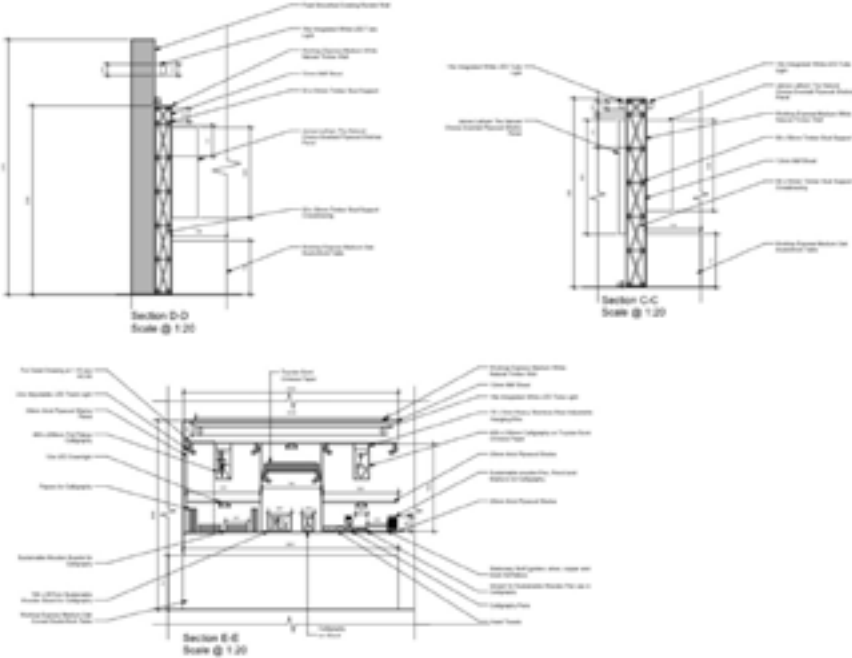

Vectorworks Educational Version

Vectorworks Educational Version

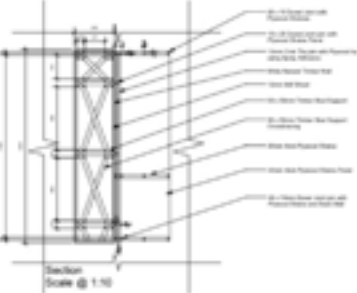

Vectorworks Educational Version

FINAL FACADE, PLAN AND SECTION:

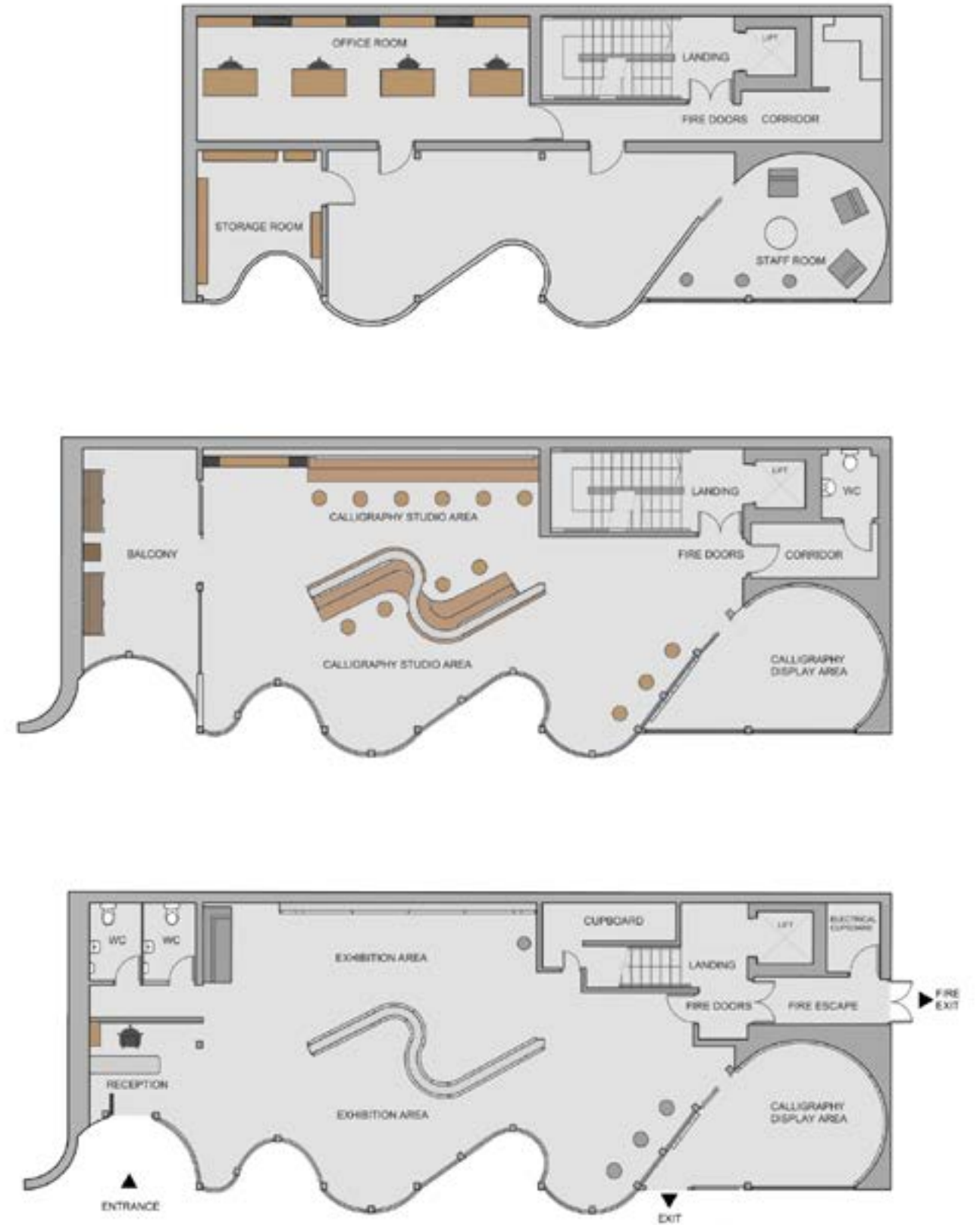
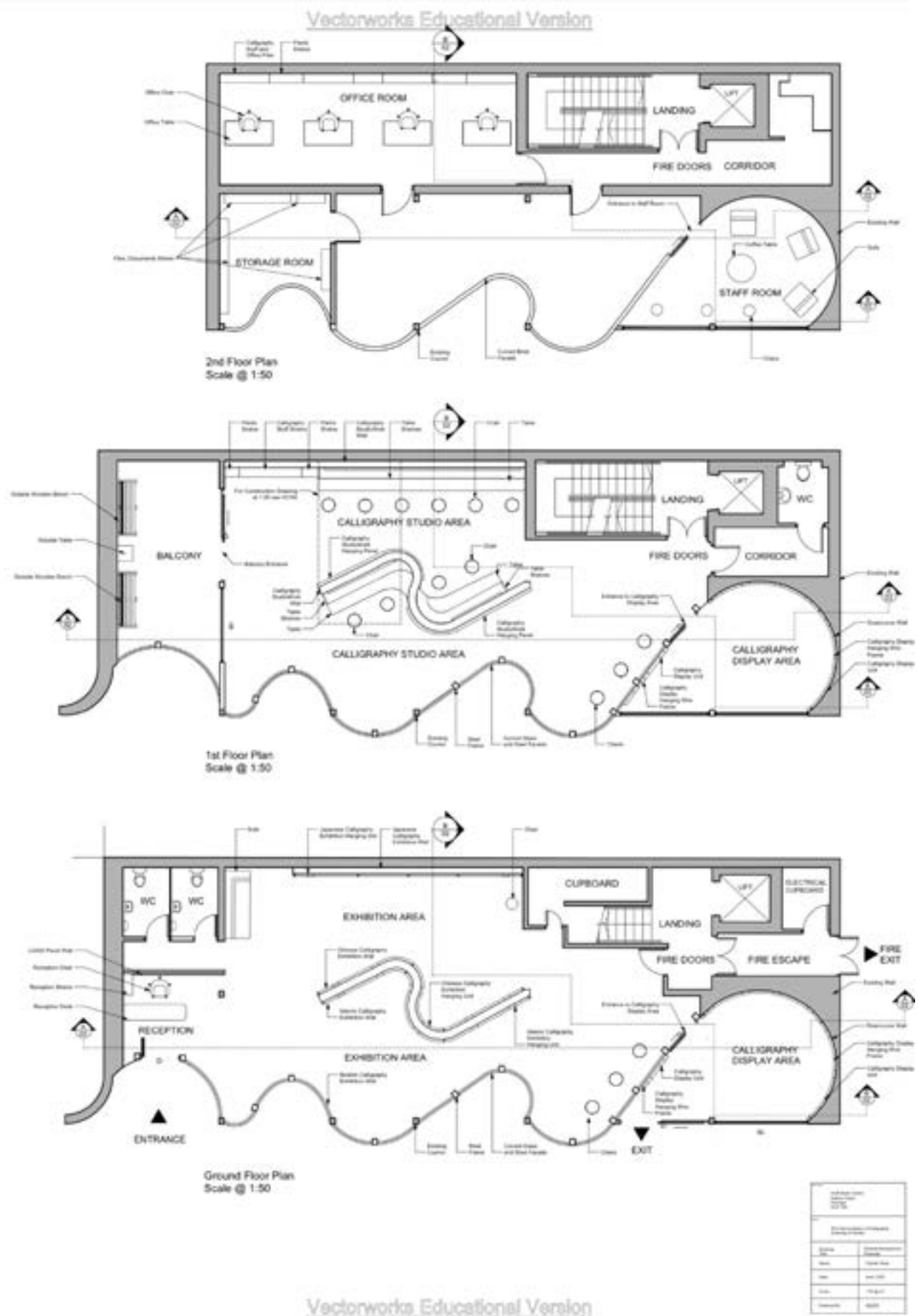

FINAL FACADE, PLAN AND SECTION:



TAKING CONTROL OF THE GRID:



EXPLORING CULTURES:





LEAVING YOUR MARK:



INFOGRAPHIC:

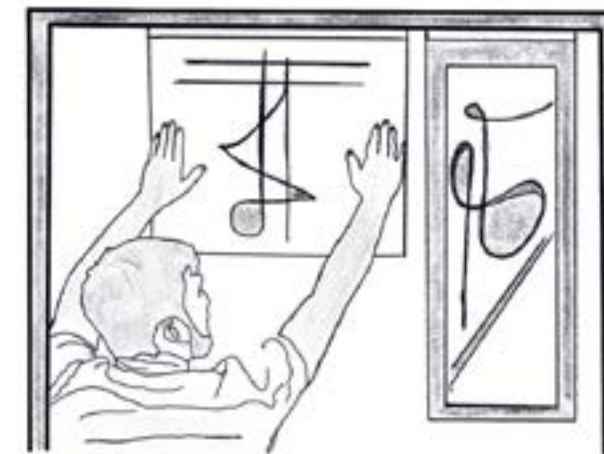
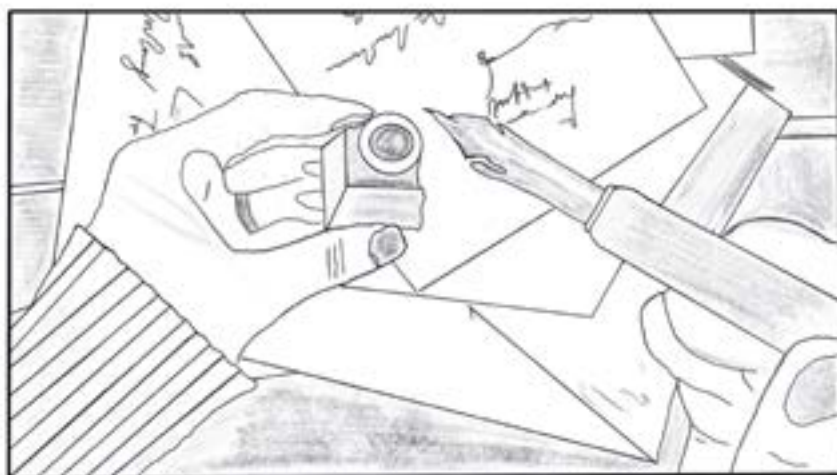



SHOWING CREATIVITY:

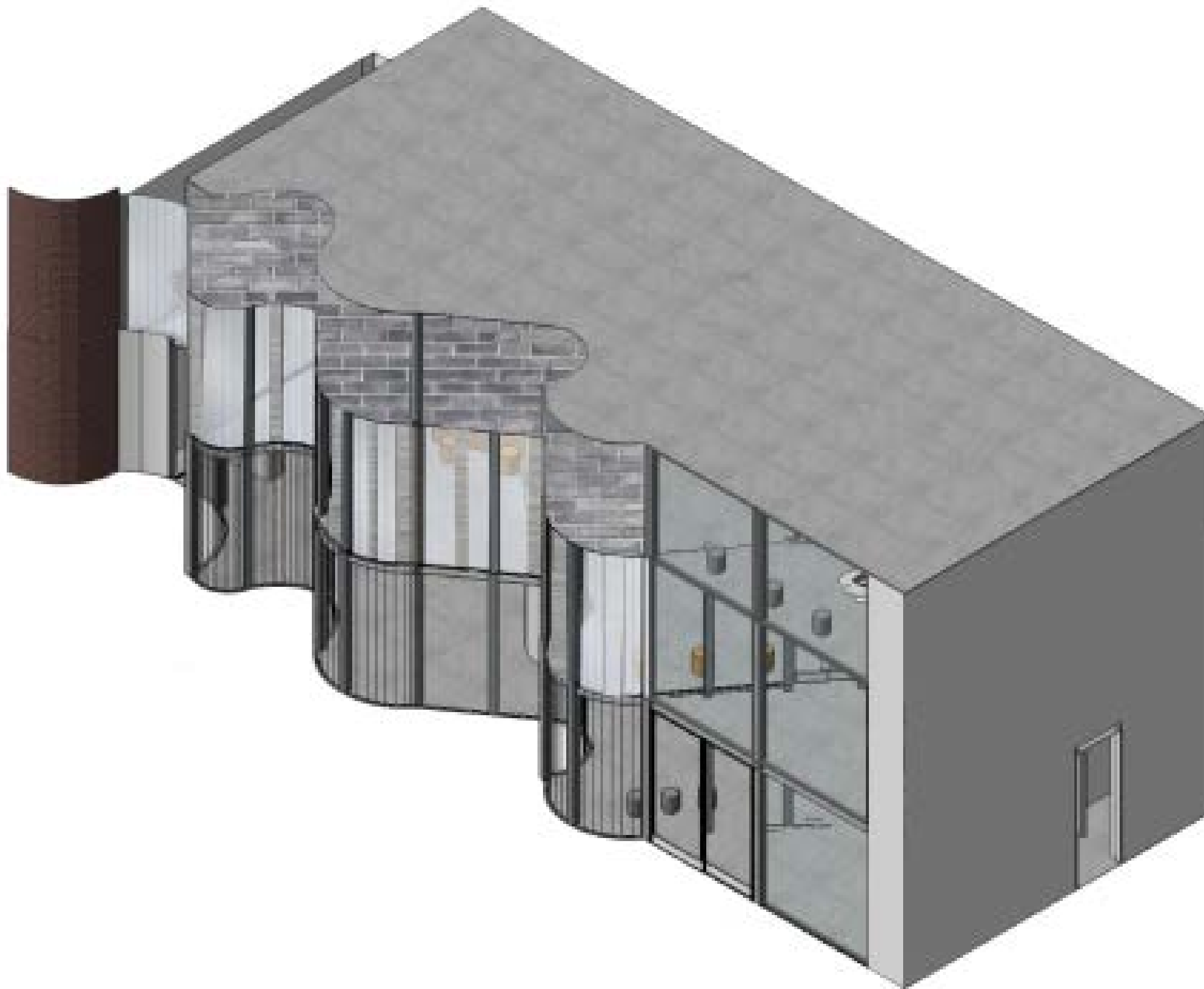

GEOMETRICAL CONTROL:

Thank You!