

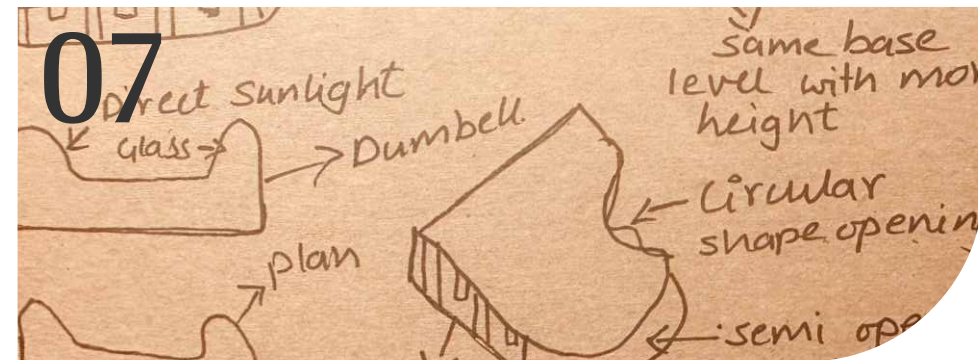

Portfolio

Culture and community

TABLE OF CONTENTS

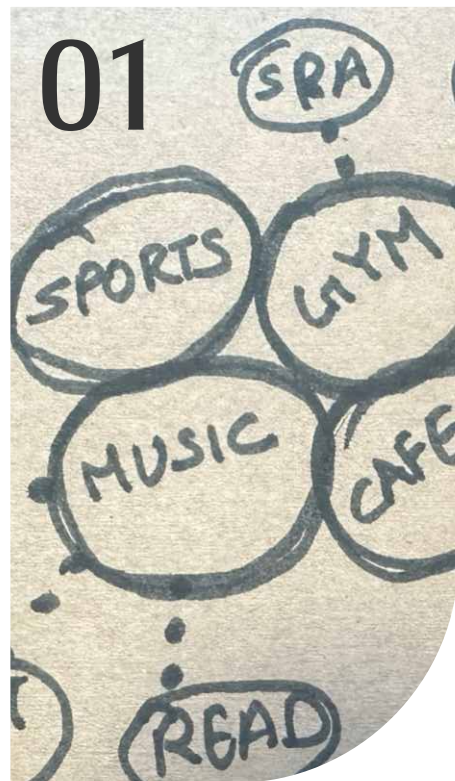

01 Introduction

02 Survey

03 Challenge students face in life journey

04 Activities include in my design

05 Case studies

06 Site Mapping

07 Concept

08 Plan

09 Renders

10 Individual Space Detail

Culture

A culture is a way of life of a group of people--the behaviors, beliefs, values, and symbols that they accept, generally without thinking about them, and that are passed along by communication and imitation from one generation to the next.

Community

A community is a social group whose members have something in common, such as a shared government, geographic location, culture, or heritage.

Local Survey

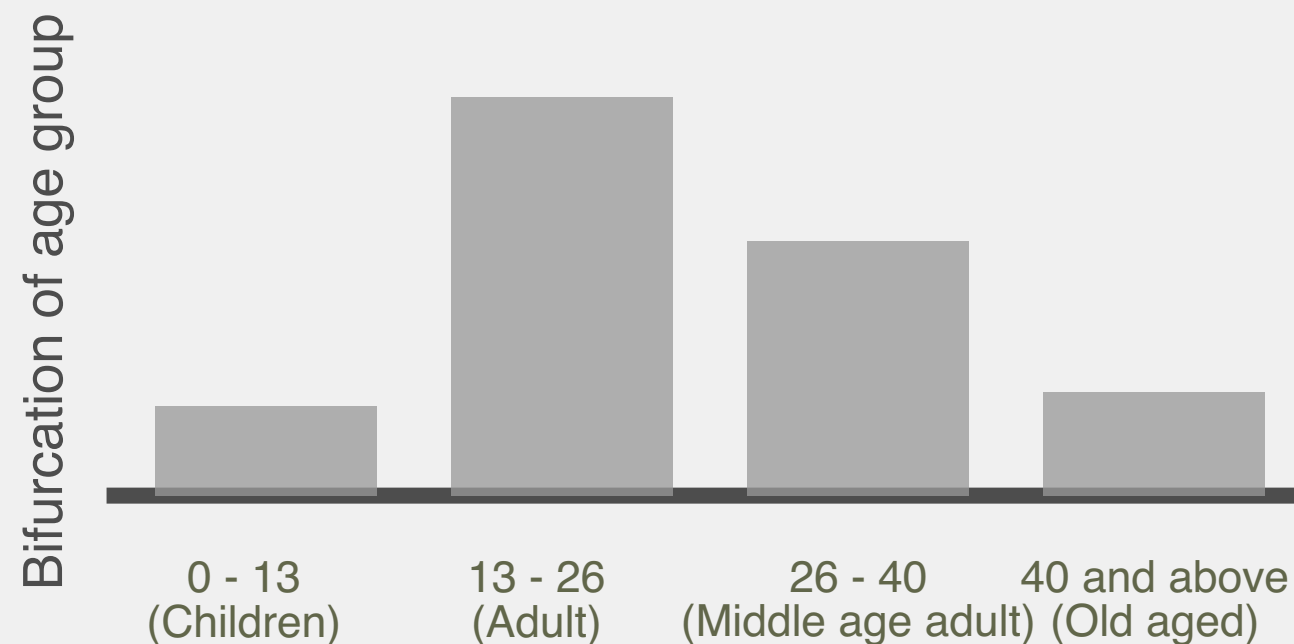

Addressing the problem of
mental stress, Anxiety loneliness.

Students

13 - 26 (Adult)



Conversation With Students

Problems in Common



Bulling



Drug



Drinking Alcohol



Poverty



Teen Pregnancy



Fighting

Challenges students face in life Journey

Time management: Balancing coursework, extracurricular activities, part-time jobs, and personal life can be overwhelming for students.

Academic pressure: Students often experience the pressure to perform well academically, meet deadlines, and achieve high grades.

Financial constraints: Many students struggle with financial difficulties, including tuition fees, textbooks, accommodation, and other expenses.

Stress and mental health issues: The demands of academic life, social pressures, and transitioning to a new environment can lead to stress, anxiety, and other mental health challenges.

Lack of motivation: Students may face periods of low motivation, making it difficult to stay focused and engaged in their studies.

Language barriers: International students may face language barriers that can affect their comprehension, communication, and overall academic performance.

Balancing work and study: Many students need to work part-time to support themselves, which can create challenges in managing their work and study responsibilities.

Uncertainty about the future: Students may feel uncertain about their career path, job prospects, and making important life decisions after graduation.

Activities that include in my design



Exercise



Music Room



Café



Gym



Reading and Drawing



Concert Area



Sports



Dance

Case Study



Architecture: Klai Juba Wald Architecture
Location: Florida, USA
Construction Year: 2019

The tower was built in collaboration with DeSimone Consulting Engineers, who oversaw the project's engineering. At night, it disappears into the night sky. The design team integrated 16,800 V-sticks (strips of LED video lamps) on the rim of the guitar.

In October 2019, the 35-story, 638-room Guitar Hotel made its solo debut, soaring 450 feet into the skies of South Florida. This architectural wonder took three years to create.



and the six vertical strings that run down its midsection by working with Boston lighting designer DCL and Montreal digital agency Float4. Every evening, dynamic choreography set to music by Float4 and LED specialists SACO Technologies transforms the hotel into a transient light installation.



Site Analysis

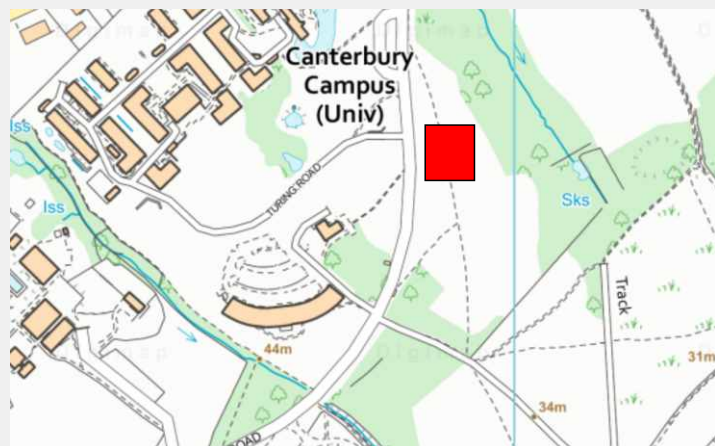
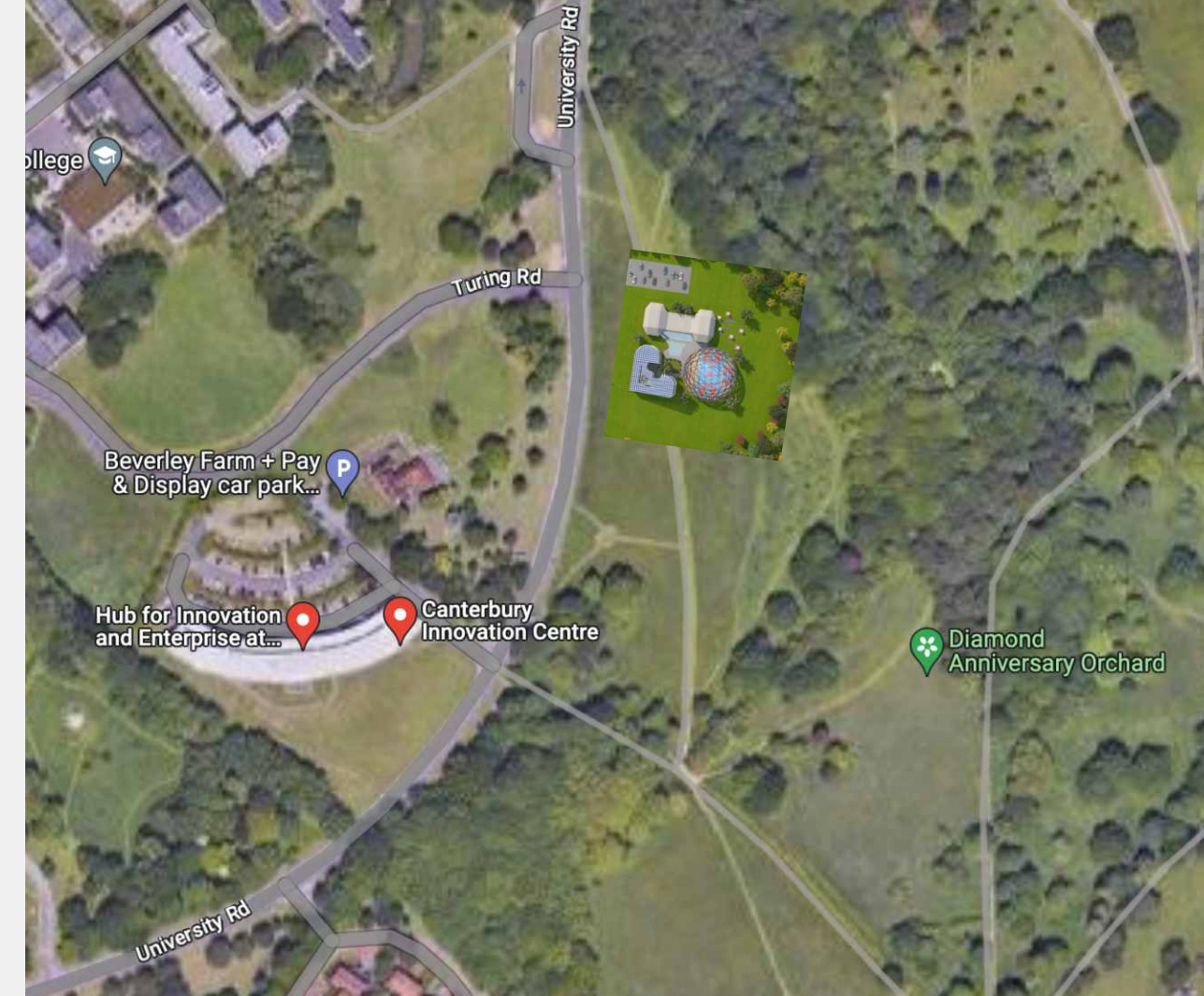
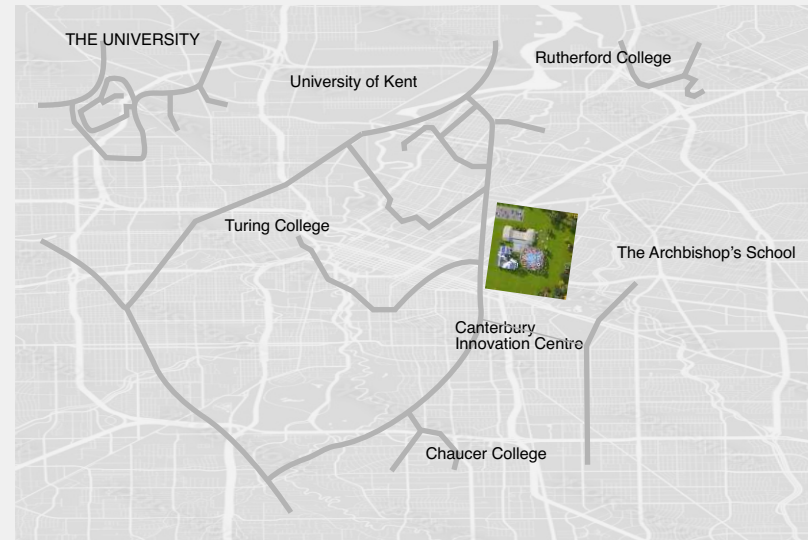
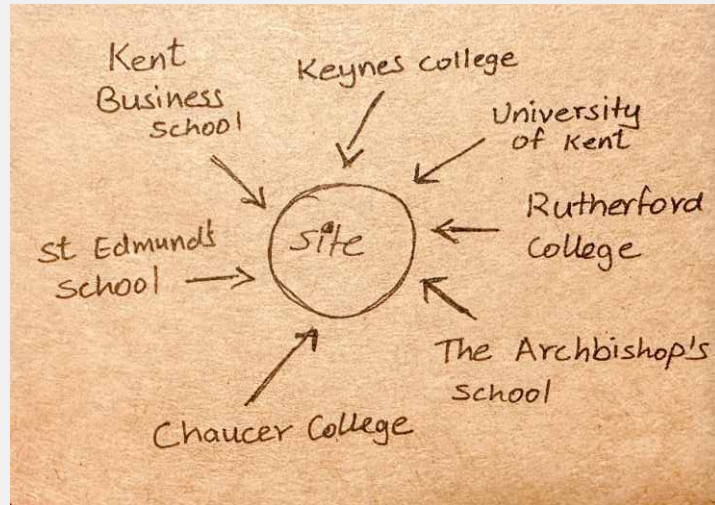

The site is near from 8-9 educational hub so that student can have easy access to go on leisure time.

Concept

When I first started the design, I had the idea to create various buildings based on the activities that would be performed in it, and my concept was to create spaces that were based on the activities that would be performed in that particular building. So, I then chose the shape and gave structure to the buildings.

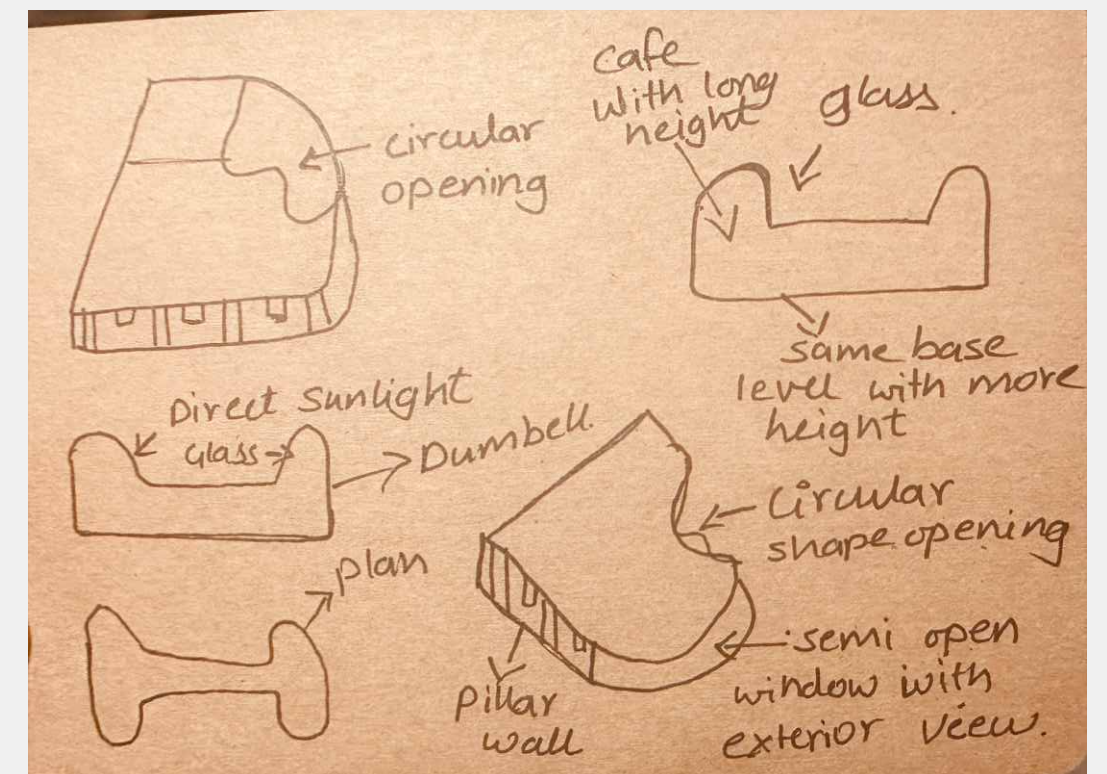
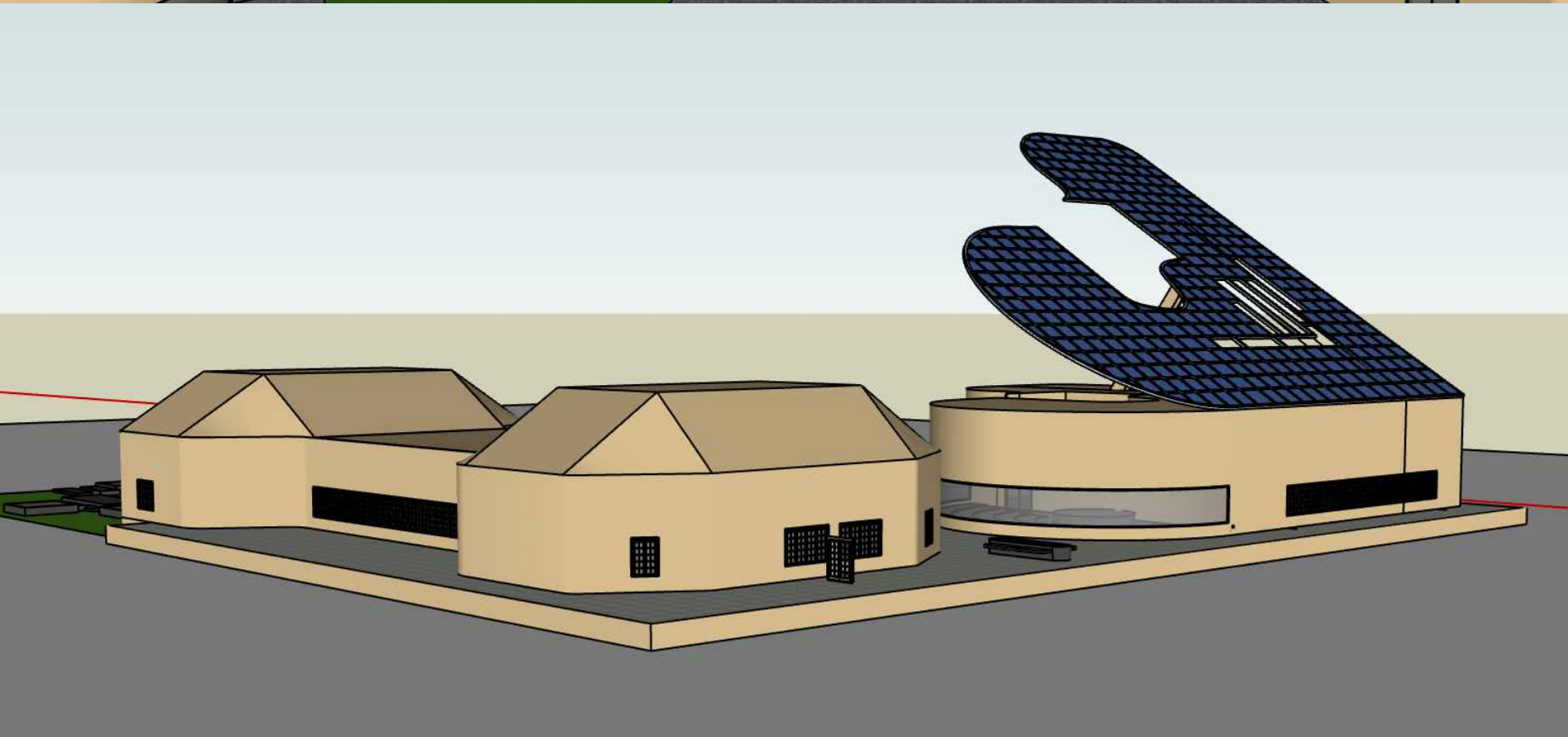

Plan

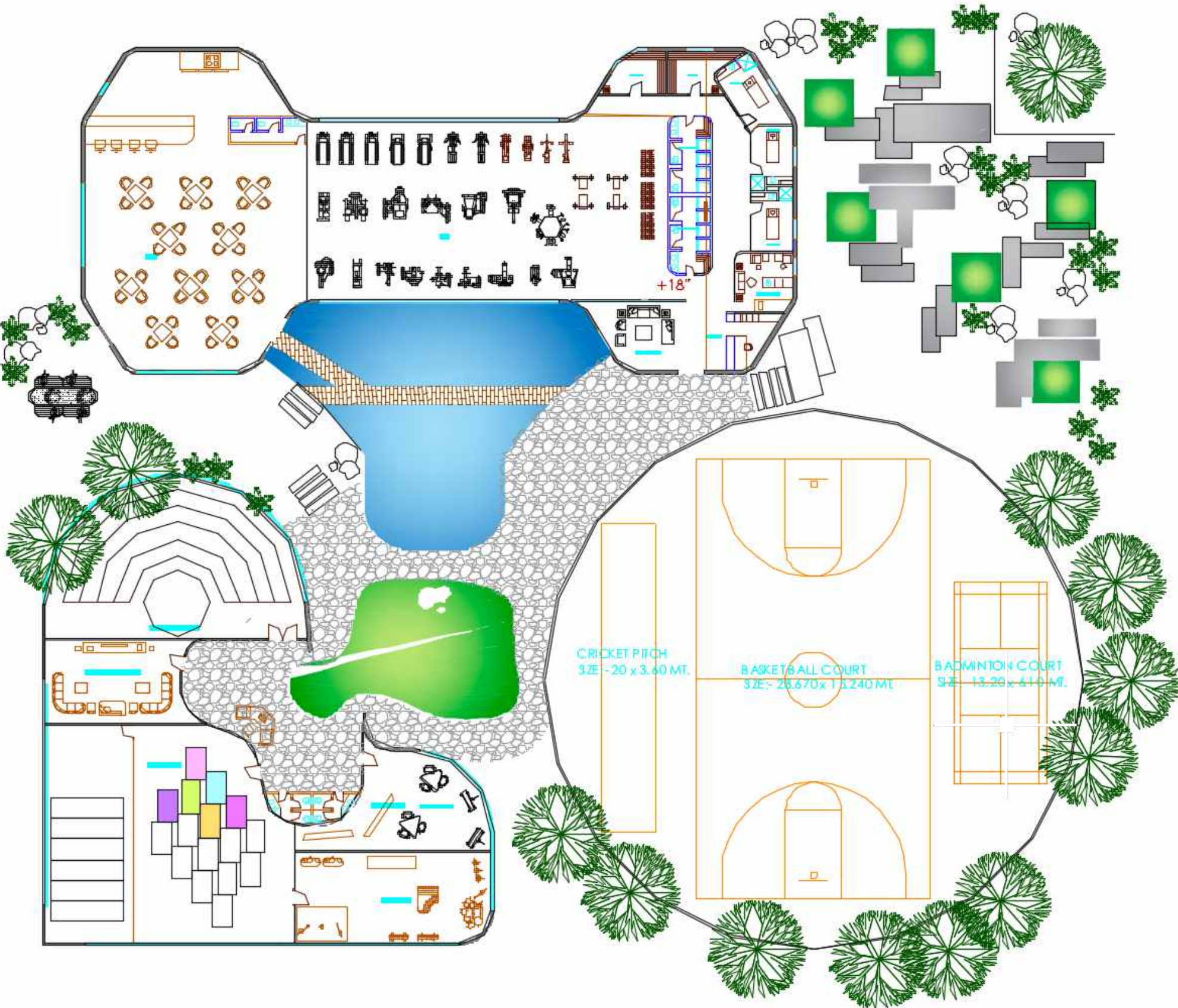

Plan and Sections

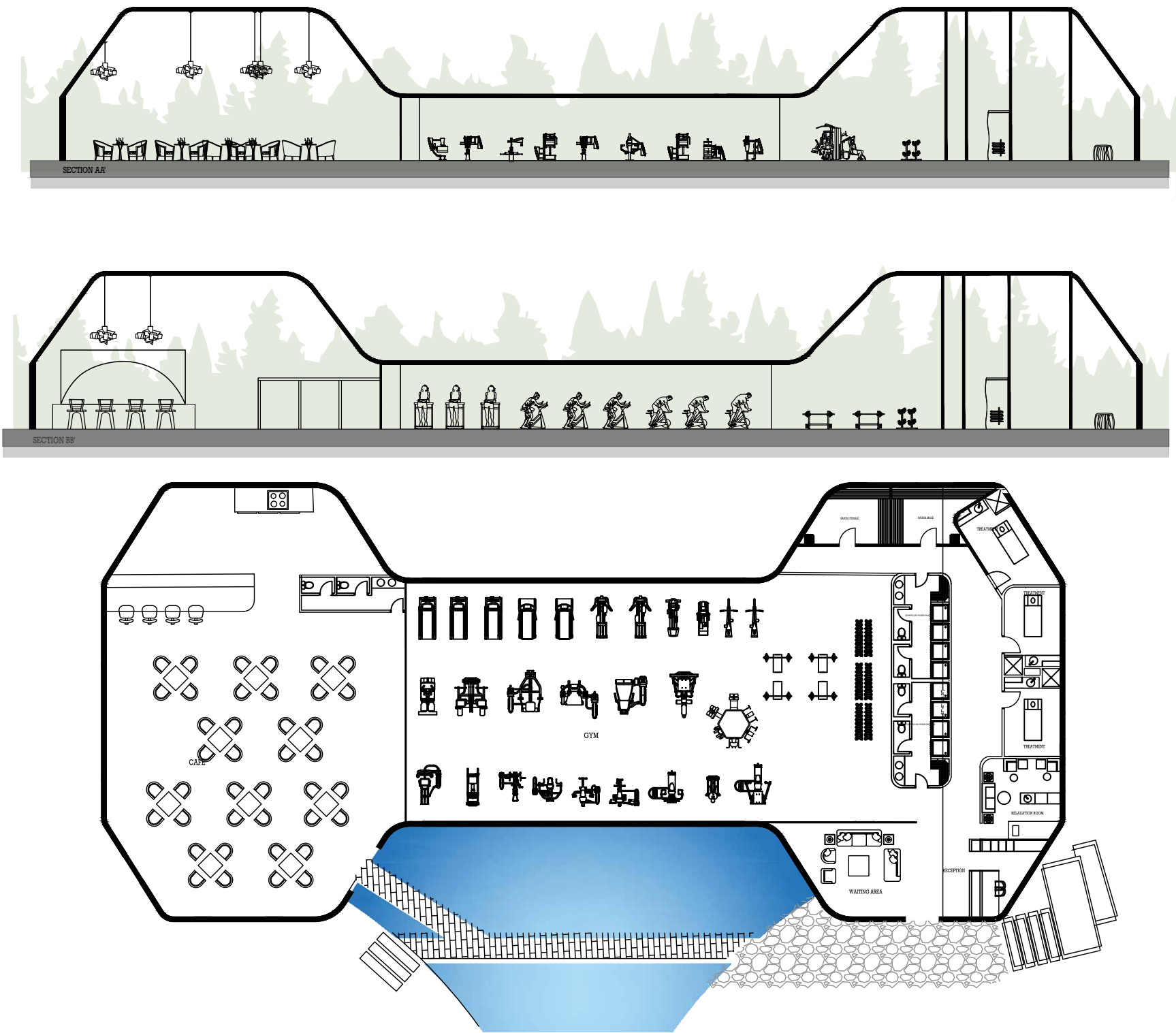

Sections

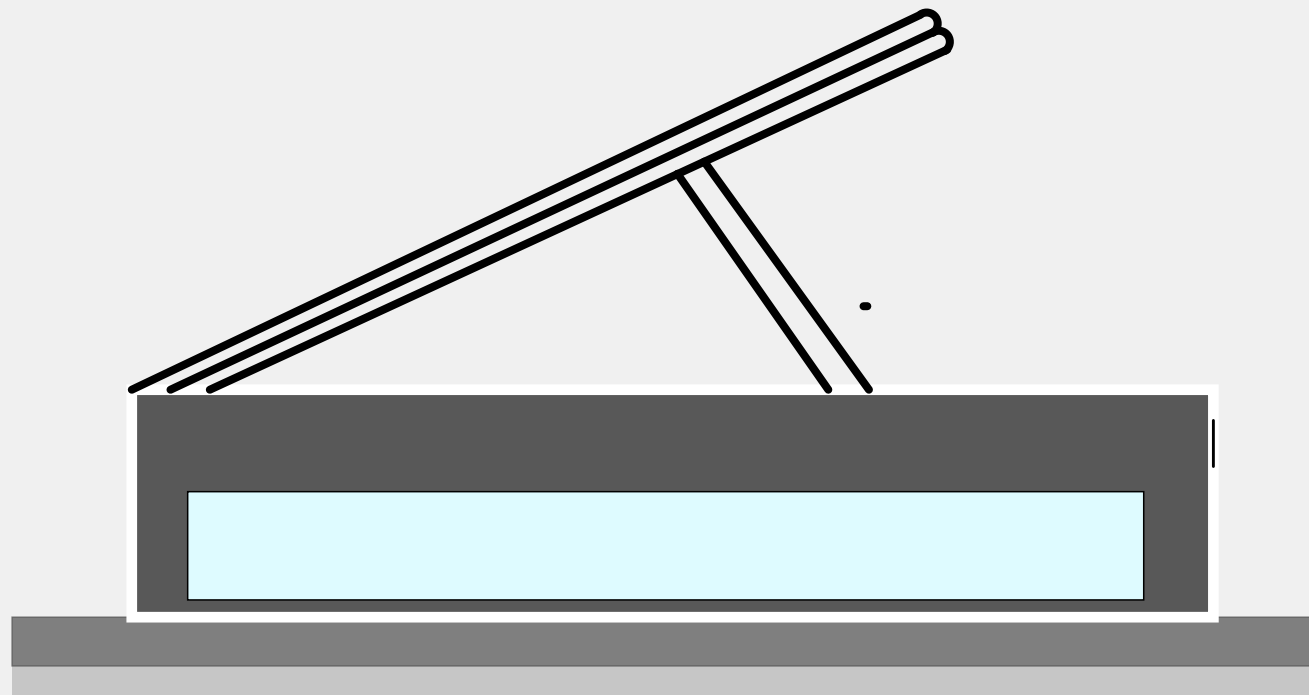

SECTION AA'

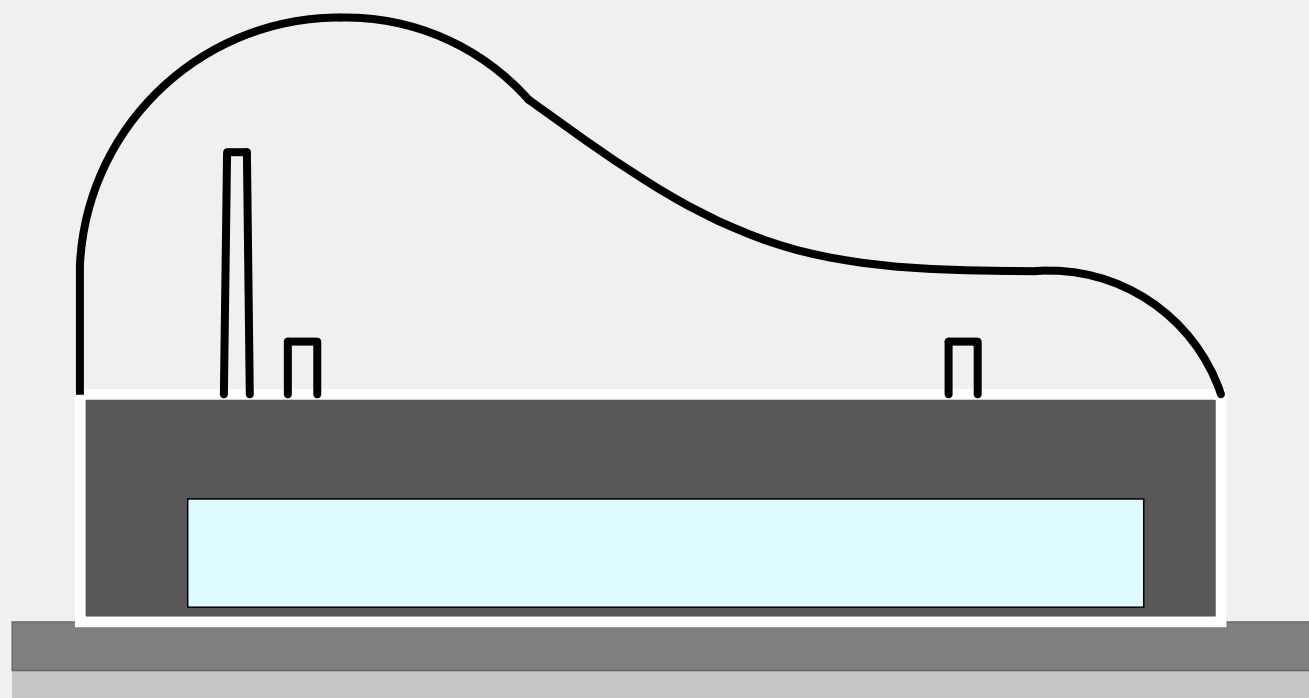

SECTION BB'

This building is designed like a musical instrumental shape piano and is greyish in colour with a sloping roof that is partially open in some of the interior spaces.



Café

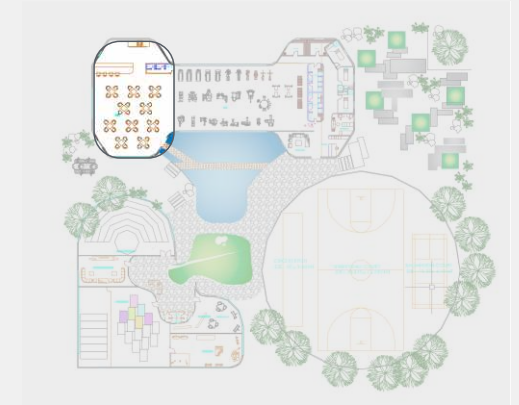

Individuals can meet with unfamiliar people and make casual friends in cafes. I designed the room with marble square flooring, light grey inner walls, and given large window for natural lighting. I created a slope in the ceiling to provide the best exterior perspective of the building.



Gym

I've created a gym that students may use to exercise and remain in shape while also realising the metal streets of the day.

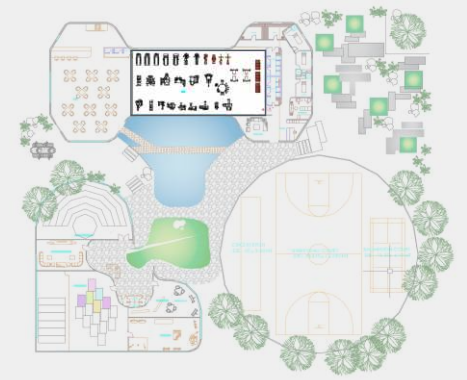

Sauna (Gym)

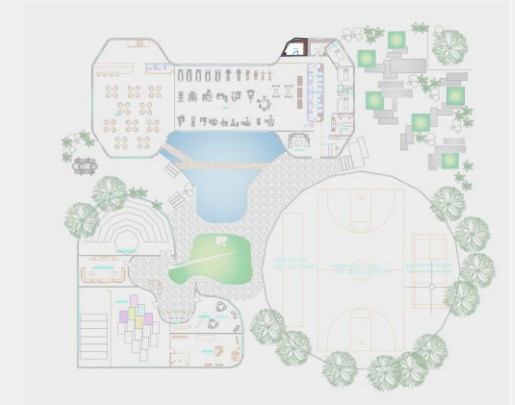
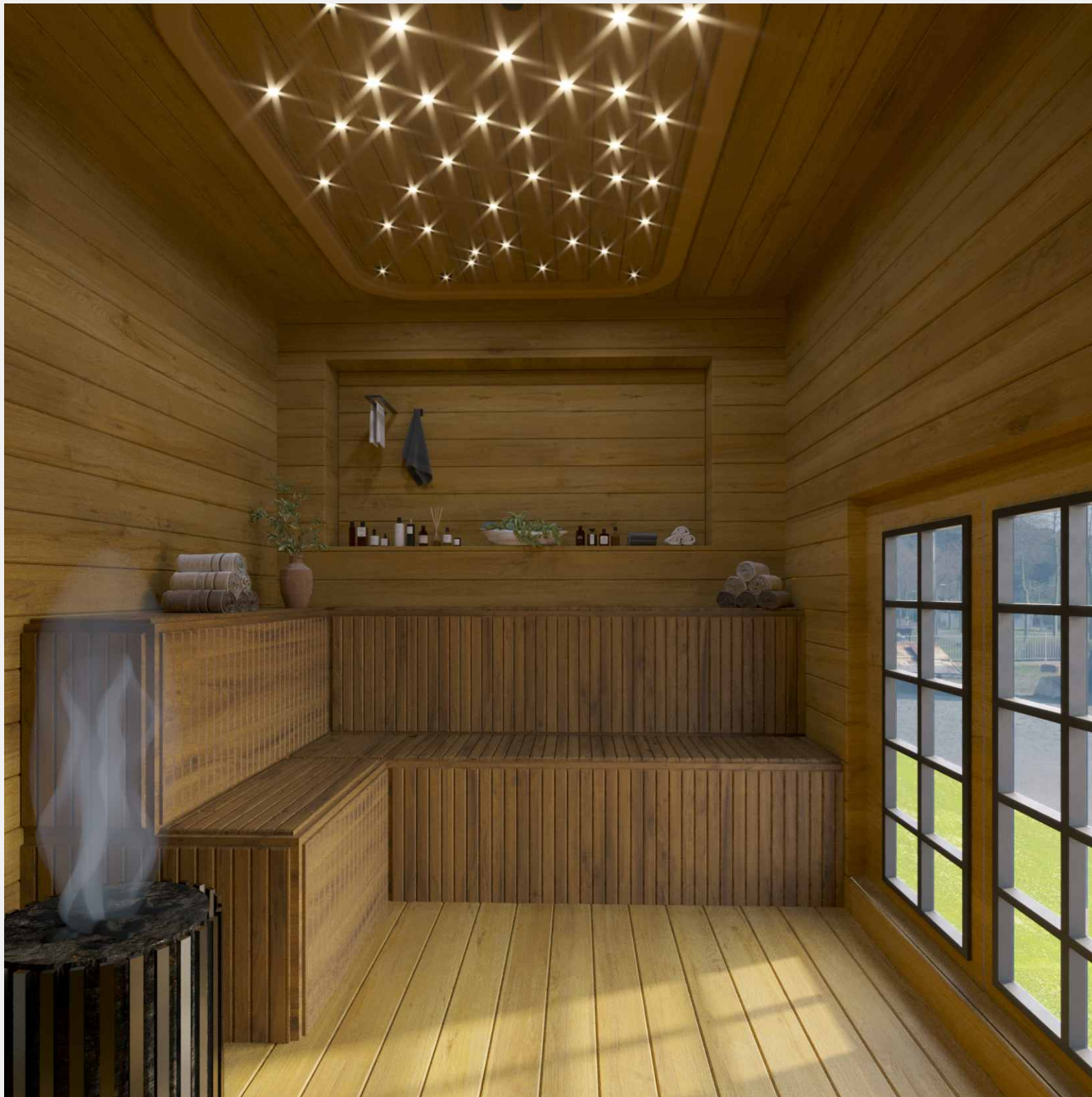

Material use for designing sauna space is local plywood.

I had created gym saunas, which offer warm relaxation at 150–195°F (65–90°C), with the ability to reduce tension and enhance circulation. Health measures and hydration are essential. Additionally available in certain gyms are steam rooms.

Dance Studio

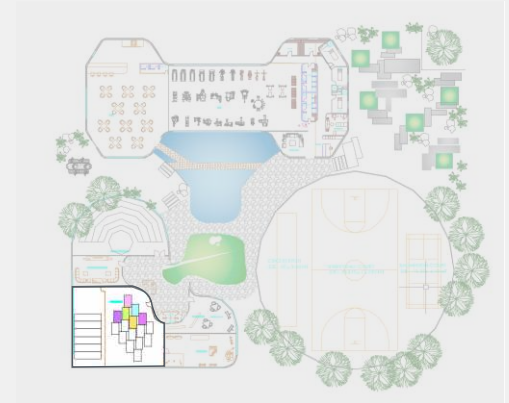

There are two separate kinds of dancing studios here, one for regular classes and the other for shooting. I tried to provide natural light in both areas, and I designed the ceiling an amazing shade that reflects nicely on the floor and may make the area look quite lovely.

Painting and Reading room

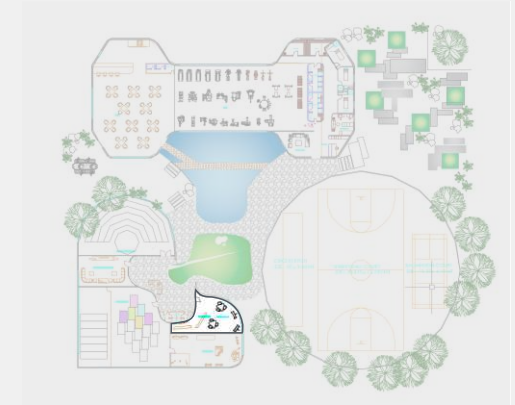

The painting and reading rooms, which are offered in my space that allow students to get relaxed and free from the daily routine, can be most beneficial to students who are quiet and prefer to spend time alone.

Concert area

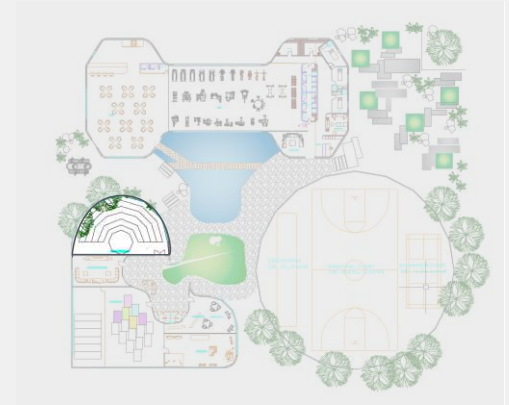

A concert area is a designated location where shows, concerts, and other events are held. It is made to accommodate audiences and offer a setting that is appropriate for live entertainment. Depending on the type of event and the location, concert spaces can have a broad range in size, design, and amenities.

Music Room

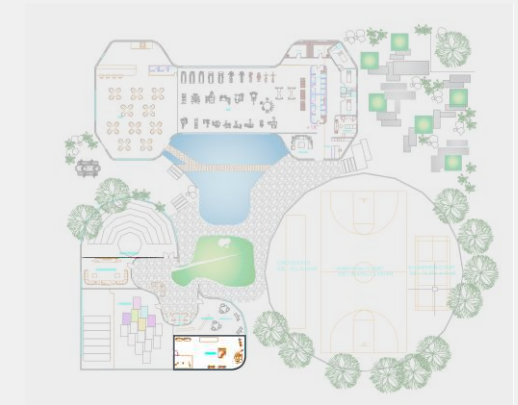
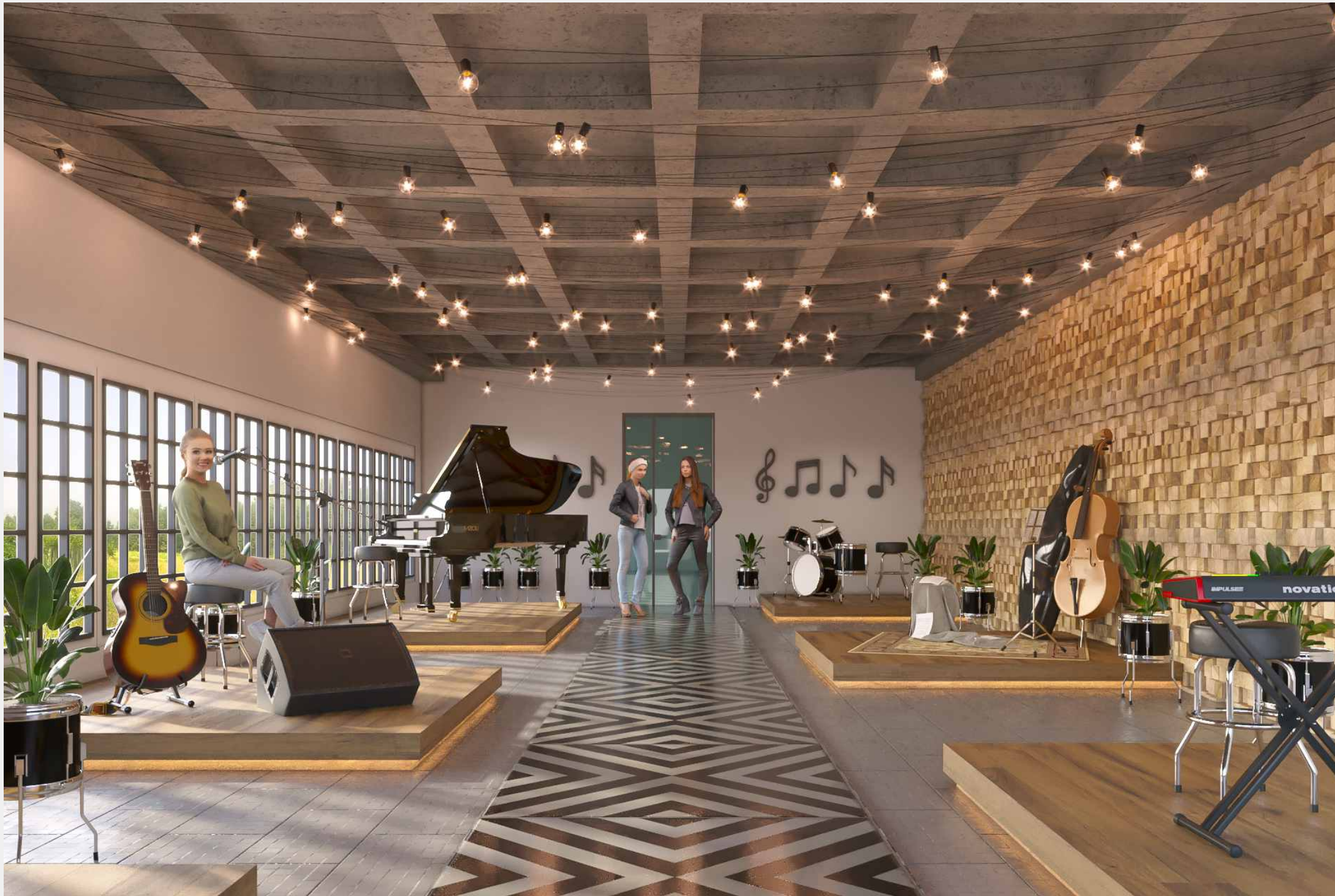

A music room is a designated space where individuals or groups can play, practice, and enjoy music. It's equipped with musical instruments, audio equipment, and sometimes recording gear.

Karaoke Room



karaoke room is the space where friends get together and allowing people to sing along with music using a microphone and lyrics displayed on a screen.

Building exterior views



Building exterior views

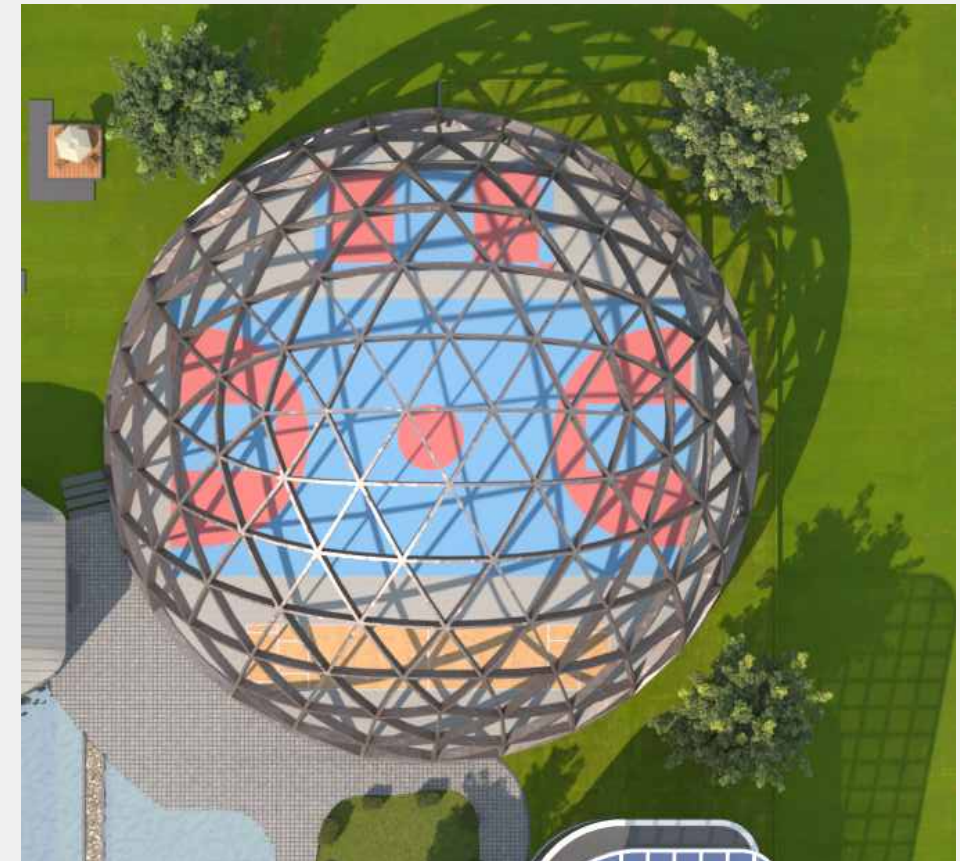

This renders depicts the exterior of my design. For my project, I decided to design the building's structure in accordance with the activity that will take place in that space, so for the gym, I chose to design the building as a dumbbell, for music, dance, singing and painting, I chose to design the building as a piano, and for sports, I used a half-cut ball as a dome.

Materials

Dance Studio



Painting and Reading



Karaoke



Music Room

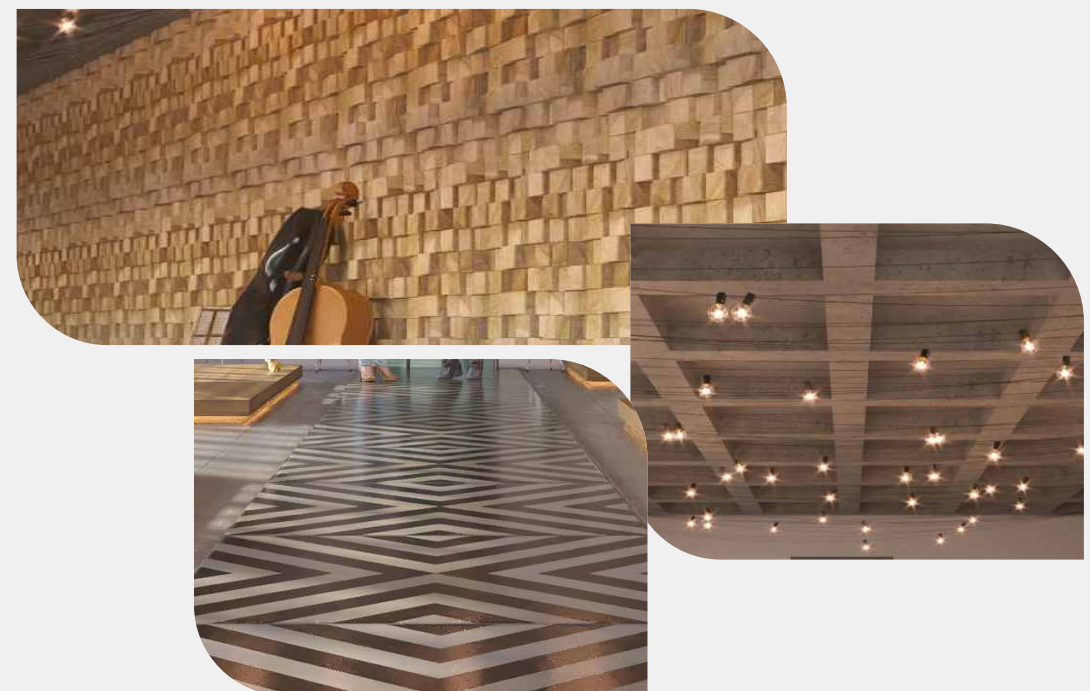

Café



Sauna (Gym)



Gym

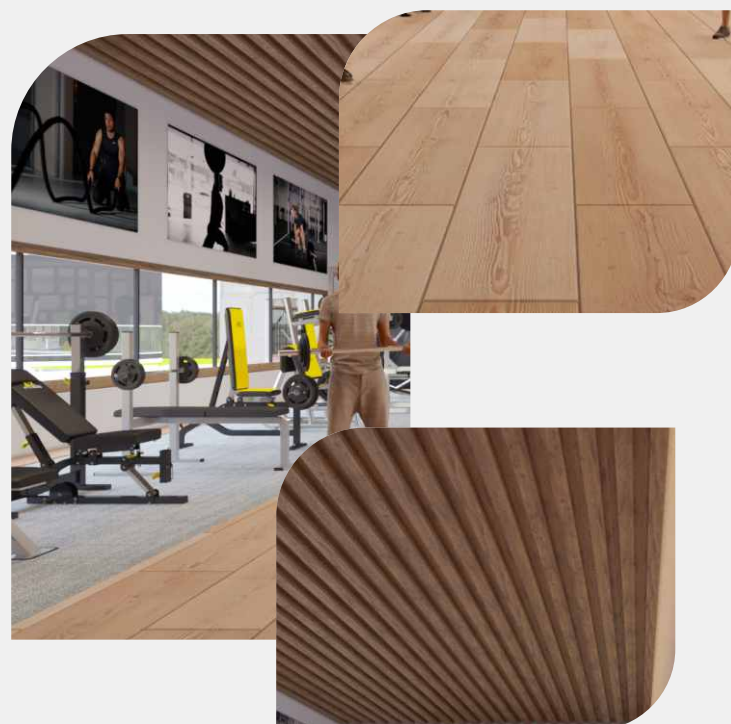

Building Exterior



THANK YOU

Kotak Shweta Bhaveshbhai
2216442